

Installation / User Manual

抽油煙機使用說明書 —RANGE HOOD—

Warning.....	1
Before using the hood.....	2
Installation.....	2
Procedure	3
Operation	4
Maintenance	5
Hood Measurement	5
Others	6
Specifications.....	6
安裝守則.....	7
功能簡介.....	8
安裝注意事項.....	9
保養與清潔	10
油機尺寸	10
注意事項及警告標示.....	11
性能規格表	11

WARNING

1. **WARNING-TO REDUCE THE RISK OF FIRE ELECTRIC SHOCK, OR INJURY TO PERSONS, OBSERVE THE FOLLOWING :**
 - a.) Use this unit only in the manner intended by the manufacturer.
If you have any questions, contact the manufacturer.
 - b.) Before servicing or cleaning unit, switch power off at service panel.
 - c.) Installation work and electrical wiring must be done by qualified person(s) in accordance with all applicable codes and standards, Including Fire-Rated construction.
 - d.) Sufficient air needed proper combustion and exhausting of gases through the flue (chimney) of fuel burning equipment to prevent back drafting. Follow the heating equipment manufacturer's guideline and safety standards such as those published by the national Fire Protection Association (NFPA), and the American Society for Heating Refrigeration and Air Conditioning Engineers(ASHRAE),and the local code authorities.
 - e.) When cutting or drilling into wall or ceiling, do not damage electrical wiring and other hidden utilities.
 - f.) Dusted fans must always be vented to the outdoors.
 - g.) **WARNING-TO REDUCE THE RISK OF FIRE, USE ONLY METAL DUCTWORK.**
 - h.) Make sure the power is off before installing, wiring or maintenance.
 - i.) If the supply cord is damaged, it must be replaced by the manufacturer, its service agent or simily qualified persons in order to avoid a hazard.
2. " **CAUTION**" -For general ventilating use only. Do not use to exhaust hazardous or explosive materials and vapors.
3. **WARNING-TO REDUCE THE RISK OF A RANGE TOP GREASE FIRE:**
 - a.) Never leave surface units unattended at high settings. To boil overs cause smoking and greasy spillovers that may ignite, Heat oils slowly on low or medium settings.
 - b.) Always turn hood on when cooking at high heat or when cooking flaming foods.
 - c.) Clean ventilating fans frequently. Grease should not be allowed to accumulate on fan or filter.
 - d.) Use proper pan size. Always use cookware appropriate for the size of the surface element.
 - e.) Keep fan, filters and grease laden surface clean.
 - f.) Use high hood setting on hood only when necessary.
 - g.) Don't leave hood unattended when cooking.
 - h.) Always use cookware and utensils appropriate for the type and amount of food being prepared.
 - i.) To get the best performance, the vertical clearance between the cook-top and the range hood should range from 26" to 30"
4. **WARNING-TO REDUCE THE RISK OF INJURY TO PERSONS IN THE EVENT OF A RANGE TOP GREASE FIRE , OBSERVE THE FOLLOWING^a:**
 - a.) **SMOTHER FLAMES** with a close-fitting lid,cookie sheet,or metal tray, then turn off the burner, **BE CAREFUL TO PREVENT BURNS.** If the flames do not go out immediately, **EVACUATE AND CALL THE FIRE DEPARTMENT.**
 - b.) **NEVER PICK UP A FLAMING PAN-You may be burned.**
 - c.) **DO NOT USE WATER,**including wet dishcloths or towels a violent steam explosion will result.
 - d.) Use an extinguisher only if:
 - 1.You know you have a class ABC extinguisher, and you already know how to operate it.
 - 2.The fire is small and contained in the area where it started.
 - 3.The fire department is being called.
 - 4.You can fight the fire with your back to an exit.
 - e.) " **WARNING-TO Reduced The Risk Of Fire Or Electric Shock,Do Not Use This Fan With Any Solid-State Speed Control Device^a** .
"Basd on" Kitchen Fire Safety Tips" published by NFPA.
 - f.) Defective bulbs should be replaced immediately to prevent the remaining bulbs from overloading.
 - g.) Danger of suffocation! Never allow children to play with packaging material.

BEFORE USING THE HOOD

- Packaging materials(plastic bags,polystyrene,etc) must be kept out of children's reach, as they are potentially dangerous.
- Installation must be carried out by a qualified technician.
- Check the voltage on the rating plate which should corresponds to the voltage in your home.
- Connect the power and switch on the motors and lighting system to check the Operation.
- Warning ! This appliance must be earthed !
- Check the following accessories before installation:
 - a.Exhaust duct adapter (6" to 6" x 1 pc, 6" to 5" x 1 pc)
 - b.Detachable oil cup 2 pcs, oil dish 2 pcs
 - c.Bulb 1 pcs
 - d.Warranty card 1pc
 - e.Instruction manual 1pc
 - f.Hardware 1 set

INSTALLATION

1. Location :

Air turbulence is from window/door may reduce the effectiveness of hood To suggest close window/door before use hood.

The smoke has to rise up to 25 cm to be within the range of suction efficiency.

2. Position :

- The installation height is measured vertically from center of fan grille of hood to the top of the stove.
- The minimum installation height should not be less than 65 cm and the recommended height is 65 to 75 cm;
- Avoid left-right or front-dropped inclination.

3. Exhaust duct :

- 6-inch diameter exhaust duct is recommended to use in order to maximize suction efficiency.In case of 5-inch exhaust duct, an adapter as enclosed in the packaging can be used;
- Before installing the hood,please apply fast drying glue to the collar and securely attach it to the top of the cooker hood's vent lid. Install the cooker hood and exhaust duct to the plastic collar and seal with fast drying glue.

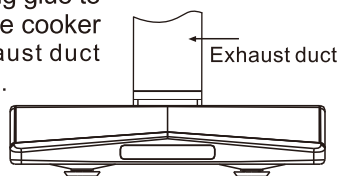
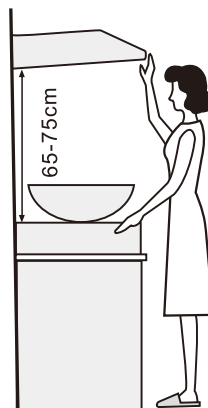

PROCEDURE

1. Find a suitable installation position of hood which should be next to a window and can be cut to let the exhaust duct pass through.
2. If the exhaust duct has to pass through the wall, particular attention must be paid to the structure of the wall as steel reinforcement may be embedded.
3. Mark the location of exhaust outlet hole, then cut/drill the hole with care.
4. Fix the position of hood and mark the position of the two hanging hooks.
5. Drive 2 steel nails into the selected wall with 3 mm (maximum) space leave behind for hanging the hood.
6. Adjust the hanging hooks on both sides of the hood and hang the hood on the steel nails, then adjust the hood from side to side and from front and back to a horizontal position.
7. Follow the instruction print on the enclosed exhaust duct adapter and connect the exhaust duct adapter to the hood and window/wall 5-inch or 6-inch duct can be used.
8. Fasten the hanging bracket to the wall by screws from the fixed holes to avoid of being hanged up by accident.
9. This appliance is not intended for use by persons (including children) with reduced physical, sensory or mental capabilities, or lack of experience and knowledge, unless they have been given supervision or instruction concerning use of the appliance by a person responsibility for their safety.
10. Children should be supervised to ensure that they do not play with the appliance.
11. **Caution To ensure drainage performance, hood shall be installed with slope (2-4mm) as shown in figure.**

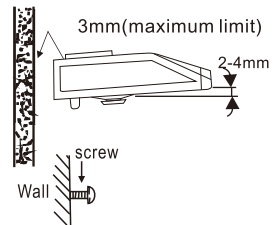
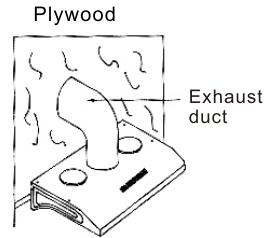

Drill a hole for the air tube
Drive 2 steel nails in, on the upper corner of the both side of the hood

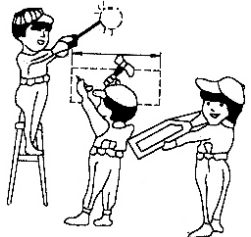

Adjust the hang hood and prepare to install

OPERATION

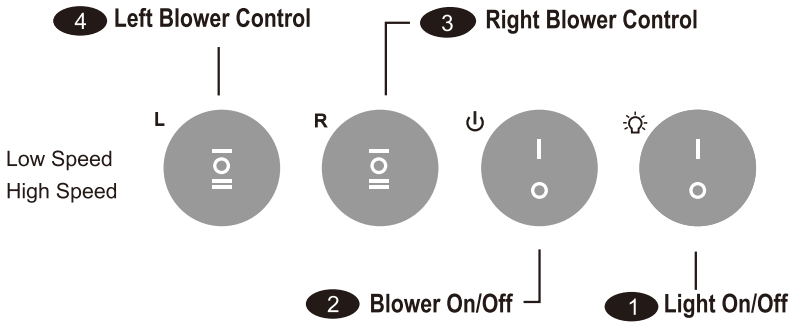

1 Light On/Off

Light switch. " I " means light ON; " o " means light OFF.

2 Blower On/Off

Master Fan Power Switch. " I " means blower ON; " o " means blower OFF.

3 Right Blower Control

Press this button to controls right fan Rock switch up(-) for Low speed. Rock switch down (=) for High speed. Center(O) to turn off.

4 Left Blower Control

Press this button to controls Left fan. Rock switch up(-) for Low speed. Rock switch down (=) for High speed. Center(O) to turn off.

MAINTENANCE

1. Always disconnect from power supply before cleaning.
2. Clean both exterior and interior of the hood long lasting. Do not use abrasive cleanser.
3. Fan protection grille can be detached for cleaning by removing the screws with a screwdriver. It must be reinstalled after cleaned.
4. Oil dish on the grille can also be be detached for cleaning by turning the dish counter-clockwise.
5. The oil cup in the centre of the hood for holding grease can be detached and cleaned regularly.
6. Make a habit to turn on the hood before use stove to avoid high heat in the kitchen.
7. The two easy dismantle rotary knobs are set bottom panel, please turn them anti-clockwise to "—" then loosen safety screw to dismount the bottom panel. It is easy to clean and repair. To turn easy dismantle rotary knobs to " | " and fasten the safety screw to set bottom panel back.
8. Caution: Please must disconnect power before install bulb. To refer step 7 to dismount bottom panel then fasten/loosen bulb with socket.

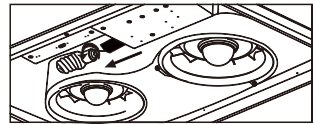
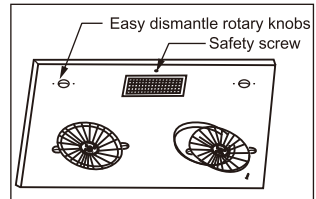
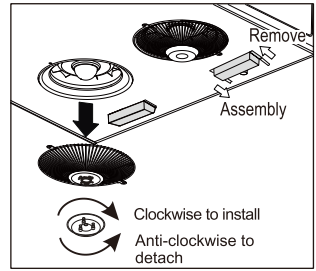
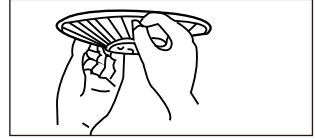

HOOD MEASUREMENT

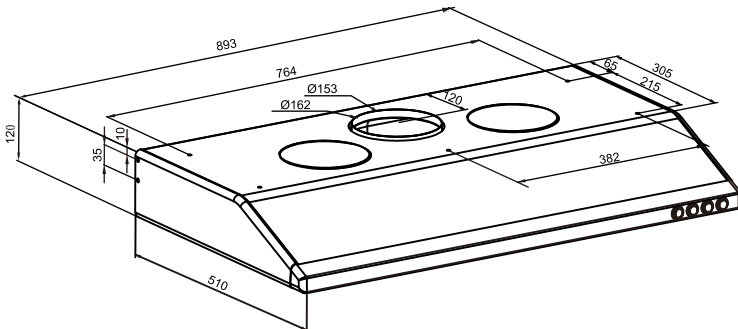

Unit:mm

OTHERS

1. Repair service including replacement of main cord should only be carried out by manufacturer, its service agent or a qualified technician. It is danger for anyone other than the above mentioned people to perform repair service.
2. Hazardous smoke/fume generated from burning Towngas/L.P. gas or/and cooking must be discharged outside the kitchen through the exhaust pipe.
3. Air ventilation inside kitchen must be maintained in good condition when range hood is using.
4. It is danger if cleaning is not carried out in accordance with the instructions specified in this user manual.
5. Do not directly flame the range hood.
6. During installation, power supply must be disconnected

SPECIFICATIONS

Model	HE36W
Weights	NW 13.6 kg GW 15.5 kg
Dimension(mm)(DxHxW)	510x120x893
Packing Dimension(mm)(DxHxW)	620x185x982
Electrical Specification	220-240V, 50Hz, 147W
Transmission	Twin Motor
Diameter Outlet Pipe	150mm
Lighting System*	9W Max, energy saving lamp

*Hood comes with 8W energy saving lamp.

安裝守則

安裝前檢查

附件：說明書1本、保證卡1張、油杯2個、小油盤2個、風管圈(6"轉6"1個、6"轉5"1個)、燈泡1個、螺絲包1組。

性能：安裝燈泡後接上電源，檢查照明、摩打及開關是否正常。

周圍環境 (圖一)

建議油煙上昇至25公分以上，抽油煙始能充份發揮抽油煙效果。

因此抽油煙機安裝位置，如在窗上或附近有太多門窗，請在開動抽油煙機前，先關閉門窗。

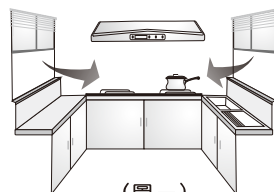

(圖一)
門窗太多、對流太大

安裝高度 (圖二)

抽油煙機安裝高度，自本機底板至瓦斯爐面之距離以65~75cm為最理想。

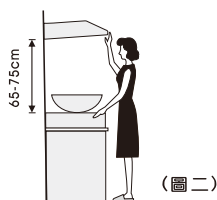

(圖二)

機體位置 (圖三)

機體應保持左、右水平，避免油杯積油溢出。左右水平可以由掛碼調整。前後請調整2-4mm的斜度固定機體，以保持油槽運行方向順暢。

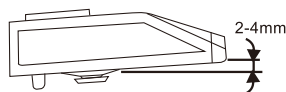

(圖三)

排風管 (圖四)

- 排風管必須配合本機出風管接頭之直徑(6吋)及盡量避免太多彎位，以免影響抽風效能。

- 安裝前先以強力膠注入風管圈後將風管嵌入，再用強力膠接合排風管與風管圈。

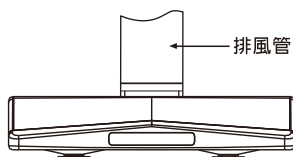

(圖四)

功能簡介

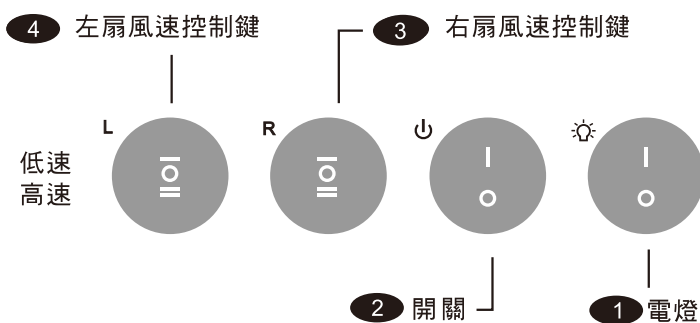

- 1 電燈
電燈總開關；"|" 啟動電燈，"O" 關閉電燈。
- 2 開關
電源總開關；"|" 啟動電源，"O" 關閉電源。
- 3 右扇風速控制鍵
按下(-)右邊風扇開始執行低速運轉、(=)執行高速運轉、(O)停止運轉。
- 4 左扇風速控制鍵
按下(-)左邊風扇開始執行低速運轉、(=)執行高速運轉、(O)停止運轉。

安裝注意事項

A. 理想安裝位置：

- (1) 安裝於爐台之上方。
- (2) 抽油煙機之底部邊緣距地面約在160cm~170cm之間。
- (3) 抽油煙機之底部邊緣距爐台上面不得超過75cm。

B. 排氣管之安裝位置：

- (1) 排氣管於爐台正對窗戶之安裝：
敲下一方玻璃，安裝一塊穿有彎管孔大的合板，排煙管由此孔穿出，絕不損壞壁面。
- (2) 爐台不鄰近窗戶時：
 - ① 選擇最近爐台，可通向室外的窗戶，裝設排氣管穿窗而出。
 - ② 或選擇最近爐台，可通向室外的牆壁(非隔間牆壁)打洞，裝設排氣管穿牆而出。

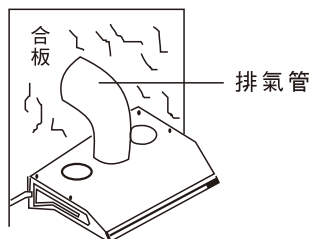

C. 鑽穿牆洞：

- (1) 先量好彎管正對牆面位置，釘頭與牆壁間最多保持3毫米距離，作掛鉤之用此舉有助機身保持水平。
- (2) 然後在壁面畫好鑽洞範圍，在使用電鑽鑽穿牆壁。
- (3) 鑽洞時應要留意牆壁結構和質料，切勿破壞牆洞以外之壁面。

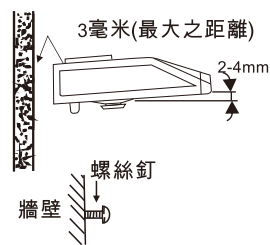

D. 裝設機體及排氣管：

- (1) 在已選定的安裝位置上，釘上螺絲釘。
- (2) 調整機體兩側之掛鉤(吊鐵)，將機體懸掛於螺絲釘上。
- (3) 懸掛後，機體要保持一定水平，(安裝原則裡的機體位置中有敘述)。
- (4) 照已選好排氣管的適當位置，選擇適當長度的直管進行裝設。

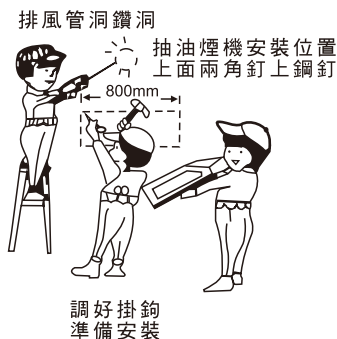

※ 吊掛飾板需鎖緊在牆壁上，以避免發生意外。

保養與清潔

五、保養和清潔

1. 清潔前，務必要切斷電源。
2. 定期清潔抽油煙機的內外側，可以保持抽油煙機壽命，切勿使用研磨性清潔劑。
3. 用螺絲刀拆卸螺絲，可拆卸風扇保護網清潔。完成後，必須重新裝回原位。
4. 按逆時針方向旋轉，可拆卸附在保護網的摩打盛油器清潔。完成後，按順時針方向旋轉，即可重新裝回原位。
5. 抽油煙機的盛油杯可拆卸作定期清潔。
6. 在開啟煮食爐前，請先開啟抽油煙機，以免廚房溫度過高。
7. 煙罩有兩個易拆旋鈕，請將旋鈕逆時針旋轉至“—”後，再將安全開關旋鬆，即可將煙罩卸下，以利於維修及清潔。完成後，將煙罩蓋上裝回原位，並將旋鈕順時針轉至“|”後，將安全開關旋緊。
8. 注意：安裝及更換燈泡前，務必先切斷電源；參考上述第7項步驟將煙罩卸下，再將燈泡旋緊或卸下燈座。

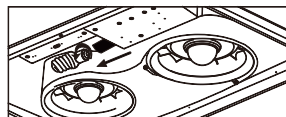
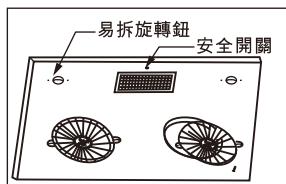
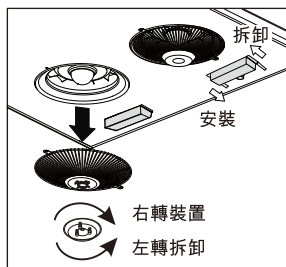
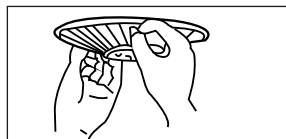

油機尺寸

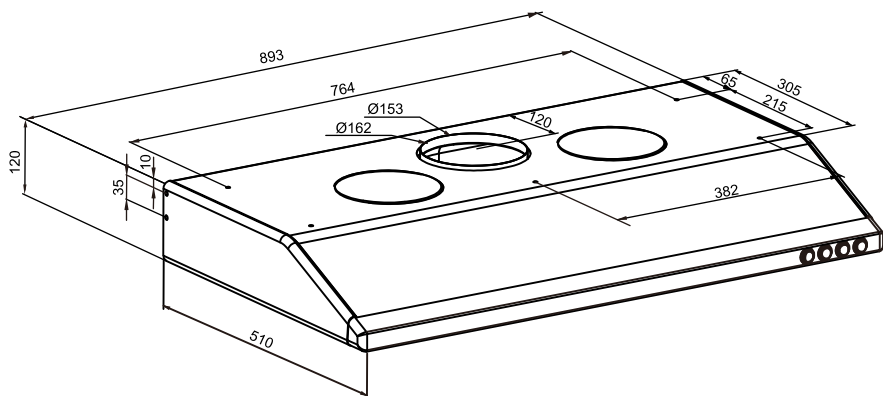

單位:mm

注意事項及警告標示

1. 每次煮食前必須先開抽油煙機才開始煮食，可防止抽油煙機損壞。
 2. 若電源線損壞時，必須由製造廠或其服務處或具有類似資格的人員更換以避免危險。
 3. 當抽油煙機與瓦斯或其他燃料同時使用時室內應有良好的通風。
 4. 若未依說明書執行清潔可能引起火災。
 5. 不可在抽油煙機下方直接燃燒。
 6. 排出的氣體不得藉由瓦斯或其他燃料之排氣通道釋出。
 7. 爐具或爐架與抽油煙機最低部份之最小距離限制，當抽油煙機置於瓦斯爐上此距離至少為65公分，若瓦斯爐之安裝說明書規定更大之距離必須列入考量。
 8. 須適當調整以使廢氣完全排出。
 9. 如果供應的電線商品是損壞的，廠商必須要更換，為了確保銷售人員或者有類似的人員可以避免危險之源。
- ※ 在未受過專業訓練者請勿自行安裝，除非有專業人士在旁指導安裝，且願意自行負責一切後果。
- ※ 小孩子應該被監督且保證他們不玩這項機器。

性能規格表

機種	HE36W
機種重量	淨重 13.6 公斤 毛重 15.5 公斤
機種尺寸(毫米)(深×高×寬)	510x120x893
包裝尺寸(毫米)(深×高×寬)	620x185x982
電壓/頻率/耗電量	220 - 240V, 50Hz, 147W
傳動方式	雙摩打
出風口徑	150mm
照明*	9W(最高)省電燈泡

*隨機附8W省電燈泡