

Whirlpool

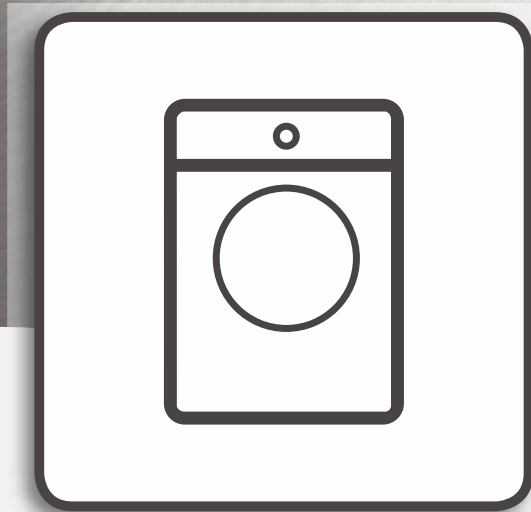

Health & Safety, Use & Care, Installation Guide

Front Load Washer

Models:

FWEB8002XX
FWEB9002XX
FWEB9503BS
FWEB10502XX
FWEB10503BS
WFC80602RT-X
WFC90604RT-X
WFC105604RT-X

USER MANUAL



THANK YOU FOR BUYING A WHIRLPOOL PRODUCT.



Read operator's manual

INDEX

| | |
|---|-----------|
| HEALTH & SAFETY GUIDE | 3 |
| Safety Instructions | 3 |
| USER MANUAL | 4 |
| Installation instructions..... | 4 |
| Specification Sheet..... | 5 |
| Product description | 6 |
| Detergent dispenser..... | 6 |
| Technical data for water connection..... | 6 |
| Control panel..... | 7 |
| Programmes..... | 7 |
| Options & Functions..... | 8 |
| Programme chart..... | 9 |
| Door..... | 9 |
| Accessories..... | 10 |
| How to use the appliance | 10 |
| First time use..... | 10 |
| Daily use..... | 10 |
| Matters need attention..... | 11 |
| Indicators..... | 12 |
| Hints and tips..... | 12 |
| Cleaning & maintenance | 13 |
| Cleaning the outside of the washing machine..... | 13 |
| Checking the water supply hose..... | 13 |
| Cleaning the mesh filters in the water supply hose..... | 14 |
| Cleaning the detergent dispenser..... | 14 |
| Cleaning the water filter / draining residual water..... | 15 |
| Troubleshooting | 16 |
| Door – how to open it in case of a failure, to take out your laundry..... | 17 |
| Transport and handling..... | 17 |
| After-sales service | 18 |

SAFETY INSTRUCTIONS

IMPORTANT TO BE READ AND OBSERVED

Before using the appliance, read these safety instructions. Keep them nearby for future reference. These instructions and the appliance itself provide important safety warnings, to be observed at all times. The manufacturer declines any liability for failure to observe these safety instructions, for inappropriate use of the appliance or incorrect setting of controls.

⚠ Very young children (0-3 years) should be kept away from the appliance. Young children (3-8 years) should be kept away from the appliance unless continuously supervised. Children from 8 years old and above and persons with reduced physical, sensory or mental capabilities or lack of experience and knowledge can use this appliance only if they are supervised or have been given instructions on safe use and understand the hazards involved. Children must not play with the appliance. Cleaning and user maintenance must not be carried out by children without supervision. Never open the door forcibly or use it as a step.

PERMITTED USE

⚠ **CAUTION:** The appliance is not intended to be operated by means of an external switching device, such as a timer, or separate remote controlled system.

⚠ This appliance is intended to be used in household and similar applications such as: staff kitchen areas in shops, offices and other working environments; farm houses; by clients in hotels, motels, bed & breakfast and other residential environments.

⚠ Do not load the machine above the maximum capacity (kg of dry cloth) indicated in the programme table.

⚠ This appliance is not for professional use. Do not use the appliance outdoors.

⚠ Do not use any solvents (e.g. turpentine, benzene), detergents containing solvents, scouring powder, glass or general purpose cleaners, or flammable fluids; do not machine wash fabrics that have been treated with solvents or flammable liquids.

INSTALLATION

⚠ The appliance must be handled and installed by two or more persons - risk of injury. Use protective gloves to unpack and install - risk of cuts.

If you want to stack a dryer on top of your washing machine, first contact our After-Sales Service or your specialist dealer to verify whether this is possible.

This is only possible if the dryer is attached to the washing machine by means of appropriate stacking kit available through our After-Sales Service or your specialist dealer.

⚠ Move the appliance without lifting it by the worktop or top lid.

⚠ Installation, including water supply (if any) and electrical connections and repairs must be carried out by a qualified technician. Do not repair or replace any part of the appliance unless specifically stated in the user manual. Keep children away from the installation site. After unpacking the appliance, make sure that it has not been damaged during transport. In the event of problems, contact the dealer or your nearest After-sales Service. Once installed, packaging waste (plastic, styrofoam parts etc.) must be stored out of reach of children - risk of suffocation. The appliance must be disconnected from the power supply before any installation operation - risk of electric shock. During installation, make sure the appliance does not damage the power cable - risk of fire or electric shock. Only activate the appliance when the installation has been completed.

⚠ Do not install your appliance where it may be exposed to extreme conditions, such as: poor ventilation, temperatures below 5 °C or above 35 °C.

⚠ When installing the appliance make sure that the four feet are stable and resting on the floor, adjusting them as required, and check that the appliance is perfectly level using a spirit level.

⚠ If the appliance is being installed on wood or "floating" floors (certain parquet and laminate materials), secure a 60 x 60 x 3 cm (at least) sheet of plywood to the floor then place the appliance on top of this.

⚠ Connect the water inlet hose to the water supply in accordance with the regulations of your local water company.

⚠ For cold fill only models: do not connect to the hot water supply.

⚠ For models with hot fill: the hot water inlet temperature must not exceed 50 °C.

⚠ The washing machine is fitted with transport bolts to prevent any possible damage to the interior during transport. Before using the machine, it is imperative that the transport bolts are removed. After their removal, cover the openings with the 4 enclosed plastic caps.

⚠ After installation of the device, wait a few hours before starting it so that it acclimates to the environmental conditions of the room.

⚠ Make sure that the ventilation openings in the base of your washing machine (if available on your model) are not obstructed by a carpet or other material.

⚠ Use only new hoses to connect the appliance to the water supply. The old hose-sets should not be reused.

⚠ The supply water pressure must be in the 0.03-1 MPa range.

ELECTRICAL WARNINGS

⚠ It must be possible to disconnect the appliance from the power supply by unplugging it if plug is accessible, or by a multi-pole switch installed upstream of the socket in accordance with the wiring rules and the appliance must be earthed in conformity with national electrical safety standards.

⚠ Do not use extension leads, multiple sockets or adapters. The electrical components must not be accessible to the user after installation. Do not use the appliance when you are wet or barefoot. Do not operate this appliance if it has a damaged power cable or plug, if it is not working properly, or if it has been damaged or dropped.

⚠ If the supply cord is damaged, it must be replaced with an identical one by the manufacturer, its service agent or similarly qualified persons in order to avoid a hazard - risk of electric shock.

CLEANING AND MAINTENANCE

⚠ **WARNING:** Ensure that the appliance is switched off and disconnected from the power supply before performing any maintenance operation; never use steam cleaning equipment - risk of electric shock.

DISPOSAL OF PACKAGING MATERIALS

The packaging material is 100% recyclable and is marked with the recycle symbol .

The various parts of the packaging must therefore be disposed of responsibly and in full compliance with local authority regulations governing waste disposal.

DISPOSAL OF HOUSEHOLD APPLIANCES

This appliance is manufactured with recyclable or reusable materials. Dispose of it in accordance with local waste disposal regulations. For further information on the treatment, recovery and recycling of household electrical appliances, contact your local authority, the collection service for household waste or the store where you purchased the appliance. By ensuring this product is disposed of correctly, you will help prevent negative consequences for the environment and human health.

The symbol  on the product or on the accompanying documentation indicates that it should not be treated as domestic waste but must be taken to an appropriate collection center for the recycling of electrical and electronic equipment.

INSTALLATION INSTRUCTIONS

Transport

Transport must be handled by two persons. Two persons should respectively stand on two sides of the washing machine and hold with both hands to transport the washing machine.

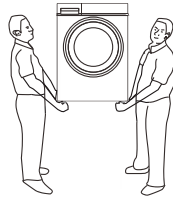

Placing the washing machine correctly

The washing machine must be installed on firm, flat and slip-proof ground. Do not place the washing machine on carpeted or wood covered floor. It is forbidden to place the washing machine on a ground platform and rack.

The washing machine must keep a minimum distance of 10 cm away from the wall or the hard reflector on three sides.

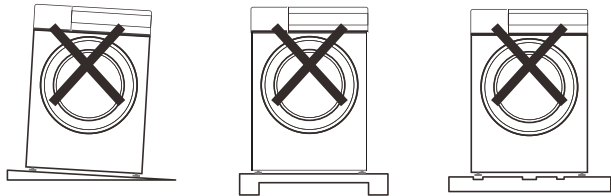

1. On sloping ground 2. On ground platform and rack 3. On uneven ground

Removing transport bolts and base protector

To protect the washing machine during transport, the internal structure of the washing machine is fastened with four transport bolts. All the transport bolts should be removed before use. (If the bolts are not removed, the washing machine will vibrate vigorously, generate loud noises and function improperly during spinning.)

1. Loosen the transport bolts (four pieces) with a wrench.
2. Shake the bolts left and right to pull them out.
3. Align the bolt covers with the original bolt holes and press until they fit.

● Please keep the transport bolts safe. They are necessary to make a move.

● Do not remove the base protector before use, as shown in the figure, or the washing machine will function improperly.

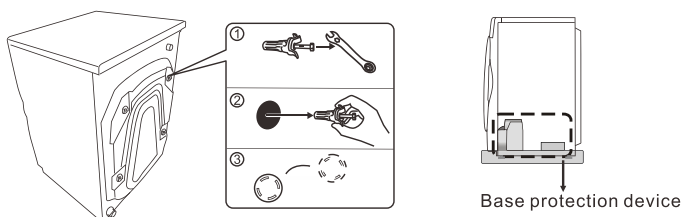

Level adjustment

If installed on an uneven place, the washing machine will generate abnormal noises or vibrations or function abnormally when in use.

The feet of the washing machine (the four feet are all adjustable) can be adjusted by the following method:

1. Loosen clockwise the locking nuts of the washing machine feet with the wrench and rotate the feet to adjust the height so as to make the washing machine level.
2. When allowed by conditions, use a level meter to check the adjusted state of the washing machine and make calibration when necessary.

Note: all four feet must reliably touch the ground and stand on the ground firmly.

3. Tighten the locking nuts counterclockwise with the wrench to lock the nuts to the bottom of the case.

4. After adjustment, press the diagonal corners of the top cover of the washing machine by a proper force with two hands to confirm that the washing machine is stable.

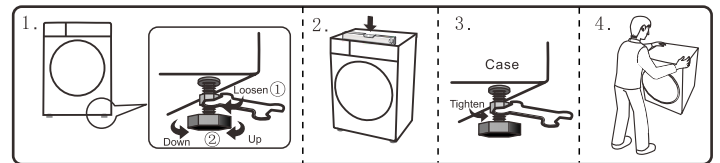

Choosing water tap

Water tap type: (The opening of the water tap should be flat.)

Type A: most suitable type

Type B: the water tap length must be greater than 16 mm, or the universal joint cannot be installed.

Type C: Water may leak from the position as shown in the figure.

CAUTION:

- Do not connect to a hot water source of over 50°C.
- If the water tap used is not suitable, replace with a suitable one.

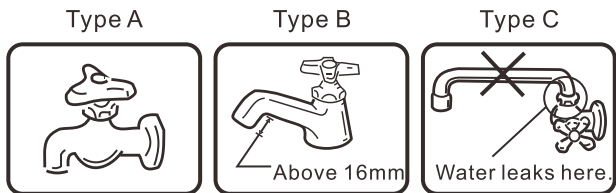

Connecting the inlet hose

Note : It is recommended the use of the provided hose.

How to attach the inlet hose

1. Loosen the four screws and slide the top of the inlet hose joint (section A in the figure) onto the faucet. Then, securely tighten the four screws provided with the inlet hose joint by using a screwdriver to secure the top of the joint to the faucet.
2. Remove the CAUTION label from the inlet hose joint.
3. Turn the male coupler on the joint (section B in the figure) clockwise to attach it securely to the top of the joint (section A in the figure).

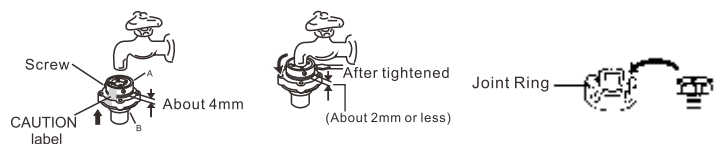

CAUTION:

If outer diameter of faucet is larger than caliber of the Joint Ring, loosen the four screws and remove the Joint Ring from the inlet hose joint.

Connecting Water Inlet Hose to the Washer

Turn the nut clockwise till the nut is tight while holding the hose.

Turn the nut counterclockwise after turning the faucet off if you want to detach the water inlet hose.

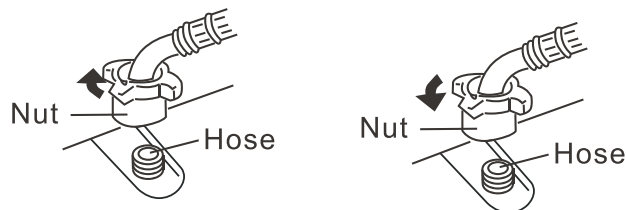

Connecting the Drain Hose

1. When the machine is not in use, put the drain hose at the back of machine (figure 1).
2. When in operation, install the drain hose into drainage duct (figure 2); you can also put end of drain hose into sewer, leaving space between end of drain hose and sewer elbow to avoid difficulty in draining water out of washing machine.
3. Clean the filter in the pump periodically to keep the wash machine working normally.

Note: Do not take off the drain hose to avoid drainage problems.

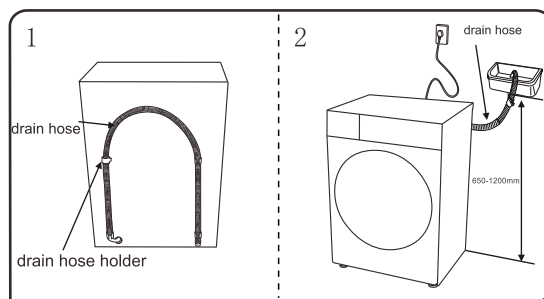

Specification Sheet

| | | |
|------------------------|--|---|
| Washing capacity | 8.0/9.0/9.5kg | 10.5kg |
| Spinning capacity | 8.0/9.0/9.5kg | 10.5kg |
| Max current | 10A | |
| Rated voltage | 230V/60Hz&220-240V/50Hz | |
| Rated power | 220-240V/1750W | |
| Washing noise | 62dB | 62dB |
| Spinning noise | 73dB | 79dB |
| Water pressure | 0.03~1.0MPa | 0.03~1.0MPa |
| Product dimension (mm) | 600x599x850(Door inclusive) 600x544x850(Door exclusive) | 600x635x850((Door inclusive) 600x580x850(Door exclusive) |

PRODUCT DESCRIPTION

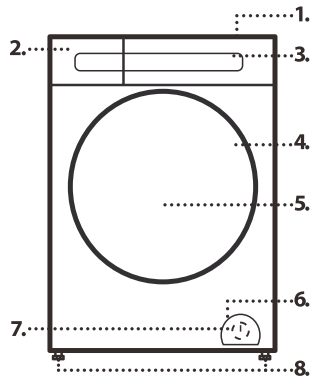

1. Worktop
2. Detergent dispenser
3. Control panel
4. Door handle
5. Door
6. Water filter - behind pump cover
7. Pump cover
8. Adjustable feet (4)

DETERGENT DISPENSER

Laundry sanitizer compartment

- The sanitizing liquid is placed in this compartment. It is recommended to use the sanitizing liquid with an ingredient of parachlorometaxylenol. To prevent damage to clothes, the highly concentrated sanitizing liquid should be added according to its instructions.

Softener compartment

- Fabric softener will be automatically injected into the drum during the final rinse.
- Consumer should follow the softener instructions.

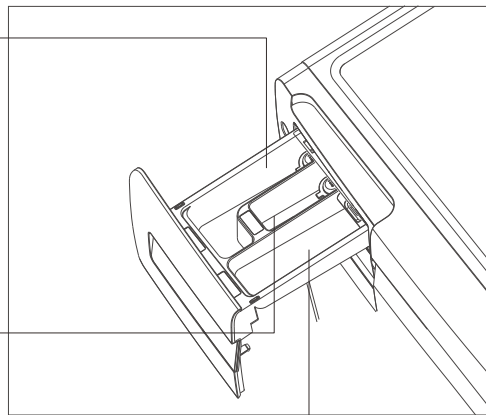

Main wash compartment

- Detergent for the main wash. For liquid detergent or powder detergent.
- Detergent which is difficult to dissolve, such as powder-shaped soap, should be fully dissolved in advance and then poured into this compartment.

- Special detergent for the front loading washing machine should be used.
- Follow the dosage recommendation. It optimizes the cleaning result, it avoids irritating residues of surplus detergent in your laundry and it saves money by avoiding waste of surplus detergent.
- Detergent should be used according manufacturer's instructions and the type, color, water temperature and degree of stain of the laundry.

TECHNICAL DATA FOR WATER CONNECTION

Water connection

Water supply

Cold

Minimum water supply pressure

30kPa (0.3bar)

Maximum water supply pressure

1000 kPa (10 bar)

CONTROL PANEL

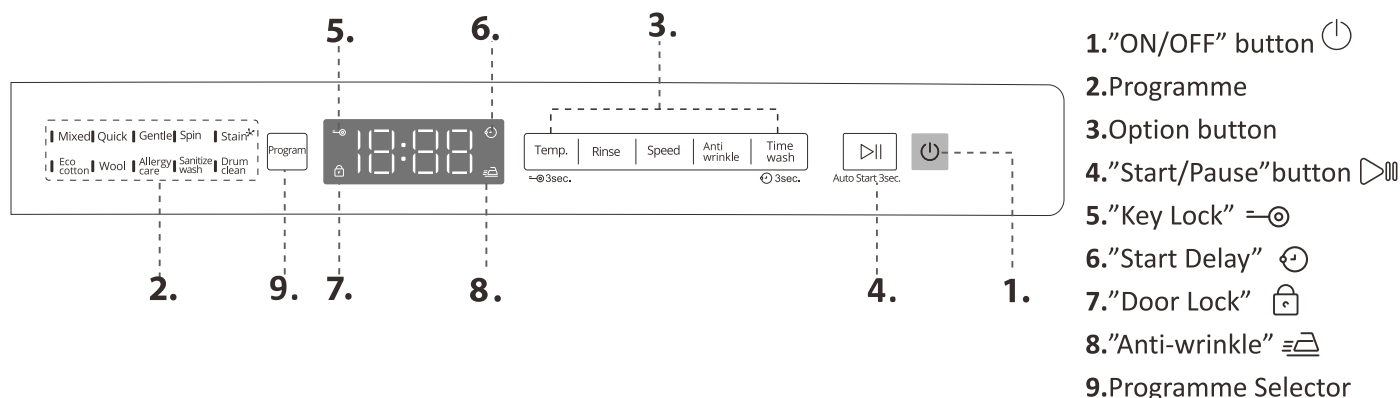

1. "ON/OFF" button
2. Programme
3. Option button
4. "Start/Pause" button
5. "Key Lock"
6. "Start Delay"
7. "Door Lock"
8. "Anti-wrinkle"
9. Programme Selector

PROGRAMMES

For choosing the appropriate programme for your kind of laundry, always respect the instructions on the care labels of the laundry. The value given in the tub symbol is the maximum temperature possible for washing the garment.

MIXED

- For washing lightly to normally soiled resilient garments in cotton, linen, synthetic fibres and mixed fibres.
- When choosing this programme, you can change the temperature, speed and rinse time.

QUICK

- For quick washing of small load or lightly soiled garments.
- When you choosing this programme, you can change the temperature, speed and rinse times.

GENTLE

- For washing particularly delicate garments. Preferably turn garments inside out before washing.
- When choosing this programme, you can adjust the temperature, speed and rinse time.

SPIN

- Spins the load then empties the water.
- When choosing this programme, you can adjust the speed and rinse time. If you adjust the rinse time, then the function will change to rinse and spin.

STAIN

- For washing normally to heavily soiled clothing.
- When choosing this programme, you can not change the temperature, speed and rinse time.

ECO COTTON

- For washing normally soiled cotton garments. At 60°C, this is the standard cotton programme and the most efficient in terms of water and energy consumption.
- When choosing this programme, you can change the temperature, speed and rinse time.

WOOL

- Wool garments can be washed using programme "Wool" (Machine washable). For best results, use special detergents and do not exceed maximum kg declaration of laundry for this programme.
- When choosing this programme, you can adjust the temperature, speed and rinse time.

ALLERGY CARE

- Effectively remove allergens such as dust mites, pollen and fur.
- When choosing this programme, you can change the temperature, speed and rinse times.

SANITIZE WASH

- This programme requires you to add laundry sanitizer into its dedicated compartment, which can effectively reduce and prevent bacterial reproduction.
- When choosing this programme, you can adjust the temperature, speed and rinse time.

DRUM CLEAN

- For drum cleaning only, using high temperature to sterilize the drum to effectively remove dirt and bacteria.
- When choosing this programme, you cannot adjust the temperature, speed and the rinse time.

OPTIONS

TEMPERATURE

- Every programme has a predefined temperature. If you want to change the temperature, press the “temperature” button. The value appears on the display.
- Long pressing for 3s to select the child lock function.

TIME WASH

- You can choose various predefined washing time based on soiled level, from lightly soiled to heavily soiled for everyday wash, the operation is flexible and fast.
- When long press time wash button for 3s you can set the end time of the programme. The icon  lights on the display when this function is enabled. To cancel it, long press the button 3s again.

ANTI-WRINKLE

- This option removes odours and helps to dewrinkle the laundry. After the wash cycle ends, the washing machine will perform gentle tumbling through slow rotations of the drum. You can cancel the anti-wrinkle function by pressing the anti-wrinkle button before the operation starts, or you can interrupt it anytime by pressing the on/off button.

RINSE

- By selecting this option, the efficiency of the rinse is increased and optimal detergent removal is guaranteed.
- It is particularly useful for sensitive skin.

SPEED

- Every programme has a predefined spin speed. If you want to change the spin speed, press the "Speed" button. The value appears on the display.

FUNCTIONS

ON/OFF

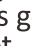
- To switch on the washing machine: press the  button.
- To switch off the washing machine after programme end, long press the  button until the lights go off.
- To save energy, if the washing machine is not switched off manually with the button, it turns off automatically approximately 10 minutes after the end of the programme.

START/PAUSE

- To start the programme, after you have finished your settings. To pause a running programme. To continue a paused programme.
- Long press 3s will activate Auto Start programme from shutdown mode. The max. wash load is same as “Mixed” programme. You can only adjust speed & rinse times.

 Not recommended for wool or silk garments.

PROGRAMME SELECTION

- After the washing machine is powered on, you can select the desired wash programme depending on the load and stain level.
- Long press the programme key allows to select the desired programme in a skipping way.

CHILD LOCK

- You can activate the child lock function to prevent unintentional changes to programmes, especially with children near the machine. Both the door and programme buttons will be locked automatically. Door will be unlocked once this function has been deactivated.
- Turn on machine and press “temperature” button for 3 seconds till the buzzer sounds. The child lock function is activated. Repeat steps to deactivate.

ADD CLOTHES FUNCTION

- As long as a wash programme is running, the door remains locked. To open the door while a programme is in progress, press the “Start/Pause” button. Provided the water level and/or temperature is/are not too high (below 50°C), the “Add” indicator lights up and you can open the door. For example to add/ remove laundry. Press the “Start/Pause” button again to continue the programme.
- Forcing the door to open may cause parts damage or injury.

PROGRAMME CHART

| Programme | Temperatures | | Rinse | Max Spin Speed (RPM) | | Max Wash Load (Kg) | | | | Programme Time | Time wash | Anti-Wrinkle | Detergents & Additives | | |
|---------------|--------------|----------|-------------------------|----------------------|--------------|--------------------|-----|-------|--------|----------------|-----------|--------------|------------------------|-----------|----------|
| | Setting | Range | | 8kg | 9/9.5/10.5kg | 8kg | 9kg | 9.5kg | 10.5kg | | | | Laundry sanitizer | Main wash | Softener |
| Mixed | 30°C | ☼ - 60°C | Default:2 Range: 0-6 | 1200 | 1400 | 6 | 6.5 | 6.5 | 7 | 1:02 | ✓ | ✓ | - | ✓ | ✓ |
| Eco cotton | 60°C | ☼ - 60°C | Default:2 Range: 0-6 | 1200 | 1400 | 8 | 9 | 9.5 | 10.5 | 1:27 | - | - | - | ✓ | ✓ |
| Quick | ☼ | ☼ - 30°C | Default:1 Range: 0-4 | 1000 | 1000 | 1 | 1 | 1 | 1 | 0:15 | ✓ | ✓ | - | ✓ | ✓ |
| Gentle | 30°C | ☼ - 40°C | Default:3 Range: 0-6 | 1000 | 1000 | 2 | 3 | 3 | 4 | 1:31 | ✓ | ✓ | - | ✓ | ✓ |
| Spin | - | - | Default:0 Range: 0-6 | 1200 | 1400 | 8 | 9 | 9.5 | 10.5 | 0:11 | ✓ | ✓ | - | - | ✓** |
| Stain | 40°C | - | Default:2 | 800 | 800 | 3 | 3.5 | 3.5 | 4 | 1:30 | - | ✓ | - | ✓ | ✓ |
| Wool | ☼ | ☼ - 40°C | Default:2 Range: 0-6 | 800 | 800 | 2 | 2 | 2 | 2 | 1:04 | ✓ | ✓ | - | ✓ | ✓ |
| Allergy Care | 60°C | 60-90°C | Default:3 Range: 0-6 | 1200 | 1400 | 4 | 4.5 | 4.5 | 5 | 2:03 | ✓ | ✓ | - | ✓ | ✓ |
| Sanitize Wash | 40°C | 40- 90°C | Default:2 Range: 0-6 | 1200 | 1400 | 6 | 6.5 | 6.5 | 7 | 1:47 | ✓ | ✓ | ✓ | ✓ | ✓ |
| Drum Clean | 90°C | - | Default:1 | 800 | 800 | 0 | 0 | 0 | 0 | 2:18 | - | - | - | ✓ | ✓ |

✓** When you adjust rinse times, you can add softener.

Singapore (water label)

Models applicable: FWEB8002GW, FWEB9002GW and FWEB10502GW

Eco cotton This is the recommended programme at rated load capacity. Test wash cycles in compliance with regulations IEC 60456. These are the reference programmes for the water label. Set this wash cycle with a temperature of 60°C. It is the most efficient programme in terms of water consumption. The actual water temperature may differ from the declared one.

For all Test Institutes

Long wash cycle for cottons: set wash cycle Eco cotton with a temperature of 60°C.

This data may differ in your home due to changing conditions in inlet water temperature, water pressure etc. Approximate programme duration values refer to the default setting of the programmes, without options.

DOOR

To open the door, pull the handle.

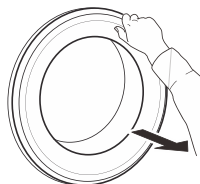



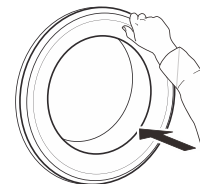

To close the door, hold the handle and push so that you can hear it click shut.



HOW TO USE THE APPLIANCE

ACCESSORIES

Contact our After-Sales Service to check if the following accessories are available for your washing machine (and dryer) model

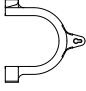
| Instruction manual | Lid | Water Supply Hose | Spanner | Warranty Card (optional) | U-shape holder (optional) |
|---|---|---|---|---|---|
|  |  |  |  |  |  |

STACKING KIT SHELF

By which your dryer can be fixed on top of your washing machine to save space and to facilitate loading and unloading your dryer in the higher position.

DAILY USE

PREPARING THE LAUNDRY



Empty pockets

- Coins, paper clips, etc. could damage the load and the washing machine components.
- Tissues will break down during the wash cycle, and the fragments will have to be subsequently removed by hand.



Close all zippers, buttons, and hooks. Tie all ribbons or belts

- Insert the smaller garments (e.g. nylon hosiery, belts, etc.) and garments with hooks (e.g. braziers) into a fabric bag or a pillowcase with a zipper. Remove any rings from curtains, or else place the curtains inside a fabric bag together with the rings.



HOW TO USE THE WASHING MACHINE

1. Load laundry



Open the door and load the laundry. Load the articles one at a time loosely into the drum, without overfilling. Observe the load sizes given in the "PROGRAMME CHART" table. Overloading the machine will result in unsatisfactory washing results and creased laundry

2. Close door





Make sure that no laundry gets stuck between door glass and rubber seal. Close the door so that you can hear it click shut.

3. Open water tap



Make sure that the washing machine is connected to the water mains. Open the water tap.

Switch on washing machine

Press the "ON/OFF" , the "Start/Pause"  lamp flashes slowly. The programme setting which you used last will appear on the control panel.

4. Set the desired programme

Select the required programme with the "Programme" button. The display will show the duration of the cycle. Adjust the temperature and/or spin speed settings if needed with the relative buttons.

Fabric type / Symbol on the wash label

- Cottons, mixed fibres, easy care/synthetics, wool, handwash items.
- Colour
Separate coloured and white items. Wash new coloured articles separately.
- Size
Wash items of different sizes in the same wash load, to improve washing efficiency and distribution of the articles in the drum.
- Delicates
Wash delicate items separately; they require gentle treatment.

Change temperature, if needed

Press "Temp" button once, for the programme default temperature to be displayed on screen. Press "Temp" again to switch the temperature within temperature range.

Change spin speed, if needed

Press "Speed" button once, default speed display on screen. Continue to press "Speed" button, speed increasing to maximum. Press "Speed" again, minimum speed display on screen. Continue to press "Speed" button to increase speed continuously.

Change rinse times, if needed

Press "Rinse" button once, default rinse time display on screen. Continue to press "Rinse" button, rinse time increasing to maximum. Press "Rinse" again, nothing display on screen, to show rinse time zero. Continue to press "Rinse" button to increase rinse time continuously.

Change the wash duration, if needed

Press the "Time Wash" button, for the programme default time to be displayed on screen. Press "Time Wash" again to switch the duration within duration range.

Select options, if needed

Press the button to select the option. The programme parameter will be displayed on the screen.

 If the selected option is incompatible with the programme set, the incompatibility will be signalled by a buzzer (2 beeps)

5. Add detergent



Pull out the detergent dispenser and add detergent (and additives/softener) into the relative compartments as described in section "DETERGENT DISPENSER". Observe the dosing recommendations on the detergent pack.

Correct dosing of detergent / additives is important, because:

- it optimizes the cleaning result
- it avoids irritating residues of surplus detergent in your laundry
- it saves money by avoiding waste of surplus detergent
- it protects the washing machine by avoiding calcification of components
- it respects the environment by avoiding unnecessary environmental burden.

6. Delaying the ending time of a programme

- When long press time wash button for 3s you can set the end time of the programme.

7. Start programme

- The LED light at the left side will turn on after the user selects the programme, then pressing the "▶" the door will be locked.
- To avoid overflow, do not open the detergent dispenser during a running programme.
- The remaining programme duration which is indicated on the display can vary. Factors like unbalance in the wash load, or foam formation, can have an effect on the programme duration.

8. Change the settings of a running programme, if needed

You can still change the settings while a programme is running.

To change the settings of a running programme:

- Press "Start/Pause" ▶ to put the running programme on pause.
- Change your settings.
- Press "Start/Pause" ▶ again to continue the programme.

If you have changed the programme, do not add detergent for the new programme.

To prevent that a running programme is changed by accident (for instance by children), use the "Key lock" —○ (see section "FUNCTIONS").

Pause a running programme and open the door, if needed

- Press "Start/Pause" ▶ to pause a running programme.
- Provided water level is not too high, water temperature below 50°C. the "🔒" lights off, you can open the door, for example to add more laundry, or to remove laundry which was loaded by mistake.
- Press "Start/Pause" ▶ to proceed with the programme.

9. Cancelling a running programme, if needed





- Press and hold the "ON/OFF" ⏻ button until the washing machine stops.
- If the water level and temperature are low enough, the door unlocks and may be opened.
- The door remains locked if there is water in the drum. To unlock the door, switch the washing machine on, select the spin programme and turn the spin option off by setting the spin speed to "--".
- The water is emptied and the door unlocks at the end of the programme.

10. Switch off the washing machine after programme End

- At the end of the cycle, after the washing cycle ends, in the default state, the washing machine buzzes to prompt user. If the buzzer prompt is not required the setting can be canceled. (press "ON/OFF" button, after confirming that the machine is powered on, long press "Start/Pause" button, when you hear the prompt tone for the second time, the buzzer prompt is canceled).
- The door can only be opened when the "🔒" lights off.
- Check that the door unlocked symbol is lit, then open the door and take out the laundry.
- Press "ON/OFF" ⏻ to switch the washing machine off.

To save energy, if the washing machine is not switched off manually with the button, it turns off automatically approximately 10 minutes after the end of the programme. Leave the door ajar to let the interior of the washing machine dry.

INDICATORS

| | | |
|---|--------------|--|
|  | Child Lock | This indicator will lights up: Child lock function activated, all buttons (except for power button) locked. |
|  | Anti-wrinkle | This indicator will lights up: Anti wrinkle function activated. |
|  | Delay end | This indicator will lights up: Delay end function activated. |
|  | Door lock | This indicator will lights up: 1. Machine is running a programme. 2. High Temperature in drum. 3. High Water level. |
|  | Add clothes | This indicator will lights up: Door can be opened to add or remove clothes. |





HINTS AND TIPS

RULES FOR SEPARATING LAUNDRY

- Fabric type / indications on label (cotton, mixed fibres, synthetic, wool, handwash items)
- Colour (separate coloured garments from whites, wash new coloured items separately)
- Size (wash items of different sizes in the same load to improve washing efficacy and weight distribution in the drum)
- Delicates (place small items – such as nylon stockings – and garments with clasps – such as braziers – in a laundry bag or in a pillow case with a zip).

WASH SYMBOLS ON GARMENT LABELS

The value given in the tub symbol is the maximum temperature possible for washing the garment.

-  Normal mechanical action
-  Reduced mechanical action
-  Much reduced mechanical action
-  Hand wash only
-  Do not wash

CLEAN THE WATER FILTER REGULARLY

- This is needed to prevent the filter from blocking and preventing the water from draining correctly.

SAVING ENERGY AND PROTECTING THE ENVIRONMENT

- Keeping within the load limits indicated in the "PROGRAMME CHART" will optimise energy, water and detergent consumption and reduce washing times.
- Do not exceed the detergent quantities recommended by the detergent manufacturer.
- Save energy by using a 60 °C instead of a 90 °C wash programme, or by using a 40 °C instead of a 60 °C wash programme. We recommend using "Eco Cotton" programme, which is longer, but uses less energy.
- To save energy and time when washing, select highest spin speed available for the programme to reduce the residual water remaining in the garments at the end of the wash cycle.
- Pretreat any stains with an appropriate stain remover, or else dampen any dried-on stains with water prior to washing, as this will reduce the need to use a high temperature watch programme.
- Quick programme applicable to quick washing of a small load with lightly soiled.

CLEANING & MAINTENANCE

**For any cleaning and maintenance, switch off and unplug the washing machine.
Do not use flammable fluids to clean the washing machine.**

CLEANING THE OUTSIDE OF THE WASHING MACHINE

Use a soft damp cloth to clean the outer parts of the washing machine.

Do not use glass or general purpose cleaners, scouring powder or similar to clean the control panel – these substances might damage the printing.

CHECKING THE WATER SUPPLY HOSE

Check the inlet hose regularly for brittleness and cracks. If damaged, replace it by a new hose available through our After-Sales Service or your specialist dealer. Depending on the hose type:

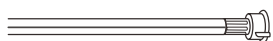

If the inlet hose has a transparent coating, periodically check if the colour intensifies locally. If yes, the hose may have a leak and should be replaced.

CLEANING THE MESH FILTERS IN THE WATER SUPPLY HOSE

1. Close water tap and unscrew the inlet hose.

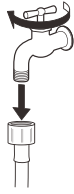

2. Clean the mesh filter at the hose's end carefully with a fine brush.



3. Now unscrew the inlet hose on the back of the washing machine by hand. Pull out the mesh filter from the valve on the back of the washing machine with pliers and carefully clean it.

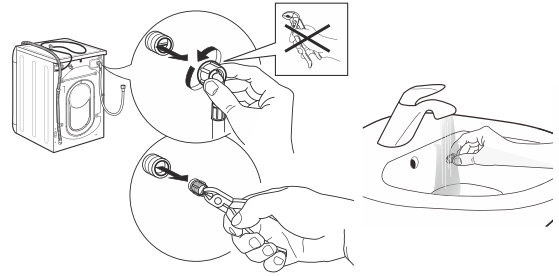

4. Insert the mesh filter again. Connect the inlet hose to water tap and washing machine again. Do not use a tool to connect the inlet hose. Open the water tap and check that all connections are tight.

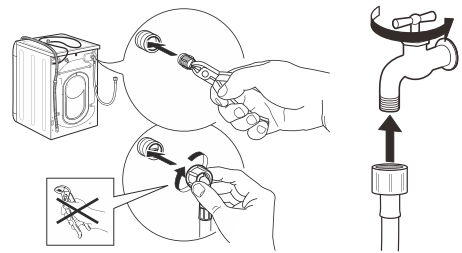

CLEANING THE DETERGENT DISPENSER

1. Remove the detergent dispenser by pressing on the release button and at the same time pulling out the detergent dispenser.

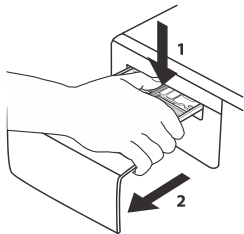

2. Remove the insert from the softener compartment.

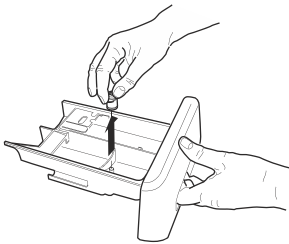

3. Clean all parts under running water, removing all detergent or softener residues.

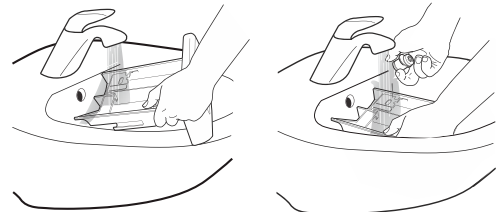

4. Wipe the parts dry with a soft cloth.



5. Reinstall the detergent dispenser and push it back into the detergent compartment.

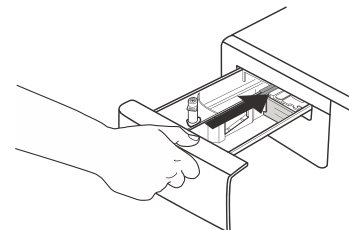

CLEANING THE WATER FILTER / DRAINING RESIDUAL WATER

Switch off and unplug the washing machine before cleaning the water filter or draining residual water. If you used a hot wash programme, wait until the water has cooled down before draining any water. Clean the water filter regularly, to avoid that the water cannot drain after the wash due to obstruction of the filter. If the water cannot drain, the display indicates that the water filter may be clogged.

Cleaning the drain pump filter / draining residual water

1. Power Off and unplug the washing machine from the electrical outlet.
2. Gently press the top area of the filter cover to open.

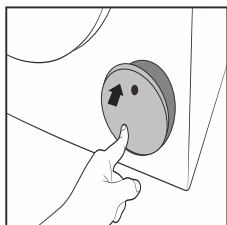

3. Place a container close to the pump to collect any spillage.
4. Stretch the "emergency drain hose" to the container.

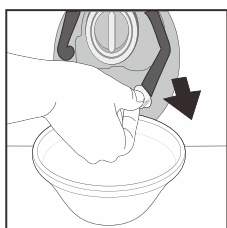

5. When the container is full with water, plug the stopper to the hose end and empty the container. Repeat this procedure until no more water flows out. Afterwards firmly close the emergency drain hose with the stopper and reinsert the hose in the washing machine's base.

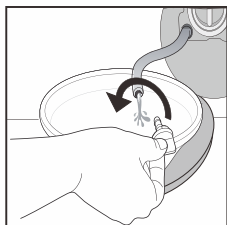

6. **Remove filter:** Lay a cotton cloth beneath the drain pump filter, which can absorb a small amount of water. Then remove the drain pump filter by turning it out anticlockwise.

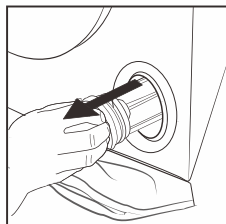
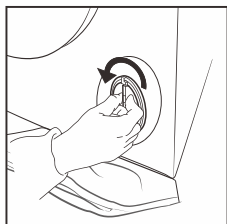

7. Clean the drain pump filter: remove residues in the filter and clean it under running water.

8. Insert the drain pump filter: Reinsert the drain pump filter again by turning it in clockwise direction. Make sure to turn it in as far as it goes; the filter handle must be in vertical position. To test water tightness of the drain pump filter, you can pour about 1 liter of water into the detergent dispenser.

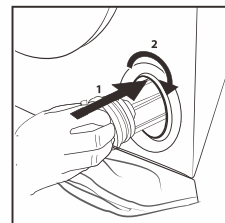

TROUBLESHOOTING

The washing machine may sometimes not work properly for certain reasons. Before calling the Support Centre, it is recommended to check to see if the problem can be easily resolved using the following list.

| Anomalies | Possible causes / Solution |
|--|---|
| The washing machine does not turn on. | <ul style="list-style-type: none"> • The plug is not inserted into the electrical outlet, or not enough to make contact. • There has been a power failure. Press the ON/OFF button to reset programme. • The door is not fully closed. |
| The wash cycle does not start. | <ul style="list-style-type: none"> • The ON/OFF button has not been pressed. • The START/PAUSE button has not been pressed. • The water tap is not open. • A start delay has been set. |
| The washing machine does not fill with water. | <ul style="list-style-type: none"> • The water intake hose is not connected to the tap. • The hose is bent. • The water tap is not open. • The mains water supply has been shut off. • There is not enough pressure. |
| The washing machine loads and drains water continuously. | <ul style="list-style-type: none"> • The START/PAUSE button has not been pressed. • The drain hose has not been installed at 65 to 120 cm from the ground. • The end of the drain hose is immersed in water. • The drain connector on the wall does not have an air vent. <p>If the problem persists after having performed these checks, close the water tap, shut off the washing machine, and call the Support Centre. If the dwelling is located on one of the uppermost floors of a building, a siphon effect can sometimes occur, thus causing the washing machine to load and drain water continuously. Special anti-siphon valves are available on the market to prevent these types of problems.</p> |
| The washing machine does not drain or does not spin. | <ul style="list-style-type: none"> • The programme does not include the draining function: with certain programmes it must be activated manually. • The drain hose is bent. • The drain line is obstructed. |
| The washing machine vibrates excessively during the spin cycle | <ul style="list-style-type: none"> • At the time of installation, the drum was not properly unlocked. • The washing machine is not level. • The washing machine is squeezed between furniture and the wall. |
| The washing machine leaks water. | <ul style="list-style-type: none"> • The water intake hose has not been tightened properly. Please check your hose regularly and in case of any damage or leakage have it replaced. • The detergent dispenser is clogged. • The drain hose has not been properly fastened. |
| The display shows an error code. | <ul style="list-style-type: none"> • Shut off the machine, disconnect the plug from the outlet, and wait about 1 minute before turning it back on. If the problem persists, call the Support Centre. |
| Too much foam is formed. | <ul style="list-style-type: none"> • The detergent is not compatible with the washing machine (it must bear the wording “for washing machines”, “for hand washing and washing machines”, or something similar). • The dosage was excessive. |
| Abnormal sound during spin | <ul style="list-style-type: none"> • The power cord or other objects touch the cabinet. • Transport bolts have not been removed. • Foreign objects such as coins or hairpins are in the drum. |

| Fault code | Description | Possible causes | Solution |
|------------|----------------------|--|--|
| No display | out of operation | <ul style="list-style-type: none"> ● Whether the outlet have electricity ● Whether the plug is plugged in power cut or not ● Whether there is a power failure ● Whether the fuse has blown in the mains plug | |
| E11 | No water | <ul style="list-style-type: none"> ● Tap turn on/off? ● Whether the water inlet hose is frozen ● Whether the mesh filter is clogged ● Water stopped or not | Press the Start/ Pause button |
| E12 | undrained | <ul style="list-style-type: none"> ● Ensure the drain pipe in the right place ● Drain height too high or not ● Whether the drain hose is blocked ● Ensure the drain-pipe length | Press Start/Pause Button |
| H | Door can't be opened | <ul style="list-style-type: none"> ● Make sure don't use hot water ● The water temperature or water level is high when washing | Automatic unlocking Until the temperature drops to safety |
| U3 | No dehydration | <ul style="list-style-type: none"> ● Ensure the machine is level ● Avoid overloading with few single heavy items ● Avoid rolling blanket up into machine | Add 2 pieces of cloth and Press the Start/pause |
| U4 | Door not closed | | Close the door, until the "locked" light on, confirm it then press "Start/Pause" to reoperation |
| Other code | Alarm | | Press "Start/Pause" to reoperation, If still can't solve the problem, please contact the service center. |

AFTER-SALES SERVICE

BEFORE CALLING THE AFTER-SALES SERVICE

1. See if you can solve the problem by yourself with the help of the suggestions given in the **TROUBLESHOOTING**
2. Switch the appliance off and back on again to see if the fault persists.

IF AFTER THE ABOVE CHECKS THE FAULT STILL OCCURS, GET IN TOUCH WITH THE NEAREST AFTER-SALES SERVICE

When contacting our Client After-sales service, always specify:

- a brief description of the fault;
- the type and exact model of the appliance;

- your full address;
- your telephone number.

If any repairs are required, please contact an authorised after-sales service (to guarantee that original spare parts will be used and repairs carried out correctly).

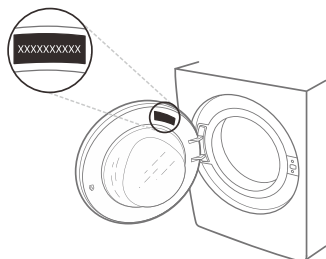

Whirlpool

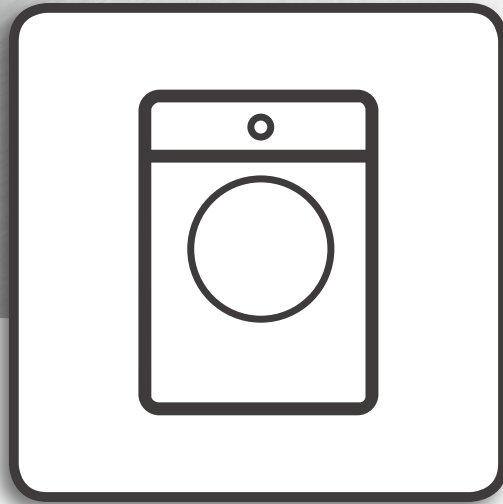

產品安全指引、使用說明、安裝指南及
網上登記保養資料

產品型號:

FWEB8002GW

使用說明書



感謝閣下購買惠而浦產品。



請仔細閱讀產品說明書。

索引

| | |
|----------------------|-------|
| 健康及安全指引 | 3-4 |
| 安全指引 | 3-4 |
| 使用說明書 | 5 |
| 安裝指引 | 5-6 |
| 產品介紹 | 7 |
| 洗衣劑盒 | 7 |
| 連接供水資料表 | 7 |
| 控制面板 | 8 |
| 程序 | 8 |
| 選項及功能 | 9 |
| 程序表 | 10 |
| 機門 | 10 |
| 配件 | 10 |
| 如何使用洗衣機 | 11 |
| 日常使用 | 11-12 |
| 顯示屏圖標 | 13 |
| 提示與貼士 | 13 |
| 清潔與保養 | 14 |
| 清潔洗衣機外部 | 14 |
| 檢查供水管 | 14 |
| 清潔進水軟管中的網狀過濾器 | 15 |
| 清潔洗滌劑盒 | 15 |
| 清潔濾水器/排出殘留的水 | 16 |
| 疑難排解 | 17-18 |
| 售後服務 | 19 |

安全指引

請仔細閱讀下列安全指引

使用洗衣機前請先細閱產品安全指引。請妥善保存此產品安全指引及使用說明作將來參考。本手冊和洗衣機本身提供重要的安全警告，請按需要隨時讀取及查察。不當的使用及不當的操作可能會導致的風險，製造商將不負任何責任。

⚠ 除非得到持續監視，否則幼兒(0-3歲)和兒童(3-8歲)應遠離洗衣機。洗衣機可由8歲以上之兒童及身體、感官或精神障礙或經驗知識不足的人士操作，前提是此等人士已接受洗衣機的安全指導及指引，且瞭解使用洗衣機的相關危險。

兒童不可胡亂玩弄洗衣機。未經指導，兒童不可進行洗衣機的清潔及保養工作。

切勿強行打開機門或以它作為踏板使用。

允許使用

⚠ 注意：此洗衣機不能透過外部控制器或遙控裝置進行操作。

⚠ 此洗衣機設計只適用於家居或下列之類似環境：如一般商店、辦公室及其他工作環境的職員專用廚房；農莊；供入住酒店、汽車旅館及其他住宅式旅店之顧客使用；提供簡單住宿及早餐服務之旅舍。

⚠ 請確保負載不超過最大洗衣量。(請參閱程序表中的指示)。

⚠ 洗衣機禁止作為商業用途。洗衣機不適合戶外使用。

⚠ 切勿使用任何溶劑(如鬆節油、汽油等)、含有溶劑、去污粉、玻璃或通用清潔劑、易燃液體洗滌劑；請勿以洗衣機清洗經溶劑或易燃液體處理過的衣物。

安裝

⚠ 此洗衣機建議由兩個或更多的人進行安裝處理，避免受傷風險。使用防護手套來執行所有拆封和安裝操作，避免割傷風險。

如果要在洗衣機頂部放置乾衣機，請首先聯繫我們的售後服務中心或您的經銷商，以確認是否可行。只允許使用我們的售後服務中心或您的經銷商提供的專業疊裝工具將乾衣機固定在洗衣機上。

⚠ 請勿提拉頂板來移動洗衣機。

⚠ 安裝，包括供水(如有任何接駁電線)，必須由合資格的技術人員按照製造商的說明和本地標準安全法規進行維修。除非在用戶手冊特別聲明，切勿維修或更換任何洗衣機的部件。兒童應遠離洗衣機安裝地點。拆開洗衣機後，確認它沒有在運輸過程中損壞。在出現問題時，請聯絡經銷商或售後服務中心。當完成安裝後，包裝棄掉的材料(如塑膠、發泡膠件等)，應置於幼童無法取得的地方，避免意外的風險。此洗衣機進行安裝前，必先斷開它的電源連接避免觸電危險。進行安裝時，確保洗衣機電源線沒有損壞，避免火災或觸電危險。只有當安裝步驟完成後才可啟動洗衣機。

⚠ 不要在極端的情況下安裝洗衣機，如：通風不良，溫度低於5°C或高於35°C。

⚠ 確保洗衣機的四隻腳穩固坐落在地面上，如需，可作調整，並檢查洗衣機是否完全處於水平位置(利用水平尺量度)。

⚠ 如果是木地板或所謂的「浮隔地板」(例如某些鑲木或層壓地板)，請將機器放在至少寬/深為60x60厘米以及厚度至少3厘米的一塊夾板上。

⚠ 根據本地供水公司的法規將進水喉管連接到水龍頭上。

⚠ 設計只能使用冷水的型號：切勿連接有熱水供應的水龍頭上。

⚠ 對於帶有熱水供水的型號：熱水進水的溫度絕對不能超過50°C。

⚠ 本洗衣機用運輸螺栓作固定，以防止運輸途中對其內部造成任何損壞。使用機器前必須拆除運輸螺栓。然後，請使用4個附帶的塑膠蓋把開口蓋好。

⚠ 安裝完成後等待數小時使其恢復適合室內的環境，才可開始使用。

⚠ 確保地毯或其他材料不會阻塞洗衣機底部的通風孔(如您的型號適用)。

⚠ 必須使用新水喉將洗衣機連接到水源。用過的水喉絕對不能重新使用。

⚠ 水壓必須於0.03 -1 MPa內。

電器警告

⚠ 插座必須能夠拔掉，以切斷電源，或安裝設有開關鍵的插座及按照本地的電器安全標準法連接地線。

⚠ 請勿使用接駁電線或多頭插座，安裝後電線部份不可被使用者易於接觸。手濕或赤腳接觸到水時請勿使用本產品。若本產品的電源線或插頭有損壞，不能正常運作，或受損，請勿操作。

⚠ 如果電源線損壞，必須根據相同產品更換電源線。電源線只能由符合製造商指導和現行的安全法規合格的技術人員更換以避免觸電的危險。

清潔和保養

⚠ 注意：執行任何維修或清潔操作之前，請先關閉及拔下電源插頭。切勿使用蒸氣清洗本產品。

處理包裝物料

包裝材料完全可回收，並設有可回收標誌♻️：

包裝的各個部分必須根據當前本地廢品處理法規進行處理。

廢棄家用電器

必須根據當前本地廢品處理法規進行處理。有關處理、修復和回收本產品的詳細資訊，請聯繫售後服務中心、家庭廢品處理服務中心或您購買本產品的商店。

本洗衣機依照有關廢棄電器和電子設備(WEEE)的歐盟標準2012/19/EU標示。確保以正確的方式廢棄本產品，可避免因不當的廢棄處理方式而對環境和人體健康造成潛在的負面影響。

這符號  表示此機器不能作為家庭廢品處理。應將它交給回收電器和電子設備的適用收集點。

安裝指引 - 搬運

搬運時，務必由兩個人進行。在洗衣機兩側分別手握洗衣機腳進行搬運。

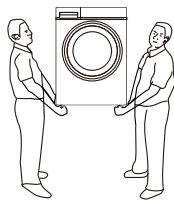

正確放置洗衣機

洗衣機須安裝在地面上或專用洗衣機底座上，地面必須堅固、平坦且防滑，切勿將洗衣機放置在地毯或木質地板上。禁止將洗衣機放在除了洗衣機專用底座外的地臺及支架上。

洗衣機必須與牆壁或擋板保持至少10厘米的距離。

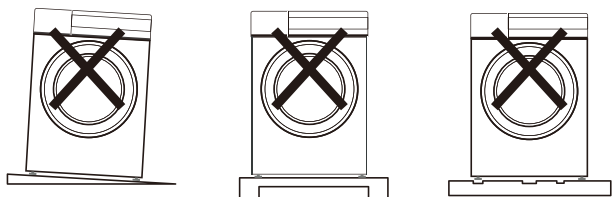

1. 在傾斜的地面上 2. 在地臺及支架上 3. 在凹凸的地面上

拆除運輸固定用螺栓及底座保護裝置

爲了在運輸時保護洗衣機，洗衣機背面裝有運輸固定用螺栓，使用之前須將其全部拆除。(否則，洗衣機在脫水時會出現強烈震動、噪音及功能異常)

1. 用工具擰鬆運輸固定螺栓(4個)。
2. 將螺栓左右晃動後拔出。
3. 使用提供的塑膠蓋對準孔的位置按進去，直到位置吻合爲止。

- 產品的安裝必須由合資格的技術人員進行。
- 請妥善保管好拆卸下來的運輸固定用螺栓，如果需要將本機移到另一個地方，您將需要再次使用它們。
- 使用前務必確認如圖所示的底座保護裝置沒有卡在洗衣機底部，否則將影響洗衣機的運作。

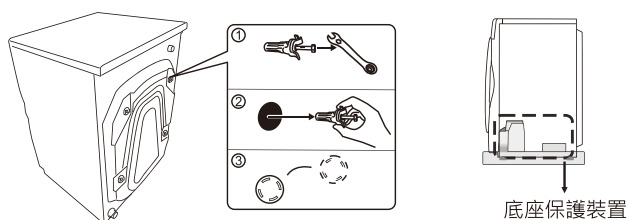

水平放置洗衣機

如果洗衣機安裝不水平，使用時可能會發生異常噪音、震動或功能異常，請根據下列步驟調節洗衣機腳，使洗衣機水平放置：

1. 用工具沿順時針方向鬆開洗衣機底部機腳的螺絲帽，轉動機腳可以調節高度令洗衣機水平放置。
2. 使用水平儀檢查洗衣機的調準狀態，確保正確調平洗衣機。
- 注意：四個底腳必須與地面貼著，穩固立在地面上。**
3. 用工具逆時針將螺絲帽擰緊，鎖定機腳。
4. 調整好之後，用兩隻手分別按住洗衣機上蓋的對角，稍稍用力按壓、晃動，以確認洗衣機是否已經水平放置。

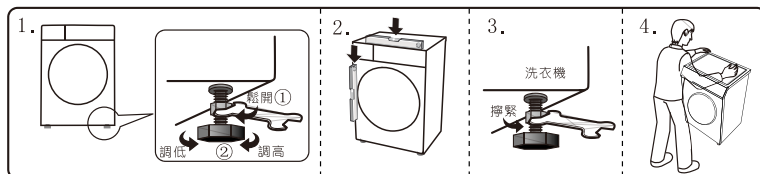

選擇水龍頭類型

水龍頭類型：(水龍頭開口要平整)

A型：最爲合適

B型：水龍頭長度須大於16毫米，否則無法安裝進水管。

C型：如圖所示的部位可能會出現漏水現象。

注意：

請勿連接50°C的熱水水源。

如果您使用的水龍頭不合適，請更換合適的水龍頭。



連接進水軟管

注意：請使用跟機配備的全新喉管。

連接進水軟管與進水閥口

1. 鬆開4個螺絲並滑動進水管接頭至水龍頭(圖1)。接著，用螺絲批擰緊該4個螺絲以確保進水管接頭緊密連接到水龍頭。
 2. 撕下進水管接頭上的封條。
 3. 順時針旋轉進水管接頭(圖2)以確保水龍頭已經緊密連接。
- 注意：如果水龍頭外徑大於接頭的口徑，鬆開四顆螺絲，取下接頭的環。



圖1

圖2

連接進水管至洗衣機

將進水管口對準進水閥口，順時針旋轉進水軟管上的旋緊螺帽，直至旋轉不動為止。
逆時針旋轉螺帽，就可以取下進水軟管。

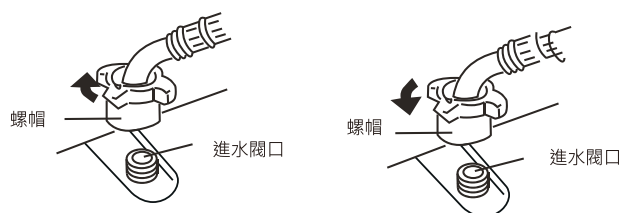

連接排水軟管

1. 當未使用洗衣機時，請將排水管放在洗衣機背後。(圖1)
 2. 當使用洗衣機時，請將排水管放入排水池(圖2)；也可將排水管另一端插入下水道口內，但請確保排水管口與排水道保持適當距離，以免影響排水。
 3. 定期清理水泵過濾器可以保持洗衣機正常運行。
- 注意：請確保排水管固定扣不會掉下，否則會造成排水故障。

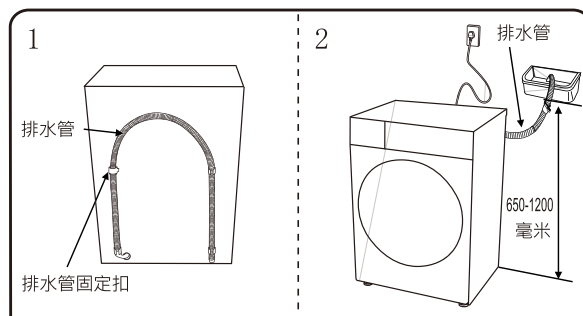

產品參數

| | | |
|--------------|---|---|
| 洗衣量(公斤) | 8.0/9.0/9.5kg | 10.5kg |
| 電流(安培) | 10 | |
| 電壓/頻率(伏特/赫茲) | 220/60, 220-240/50 | |
| 額定功率(瓦特) | 1750 | |
| 洗衣聲音(分貝) | 62 | 62 |
| 脫衣聲音(分貝) | 73 | 79 |
| 水壓(MPa) | 0.03-1.0 | 0.03-1.0 |
| 產品尺寸(毫米) | 600x599x850 (包括門框) 600x544x850 (不包括門框) | 600x635x850 (包括門框) 600x580x850 (不包括門框) |

產品介紹

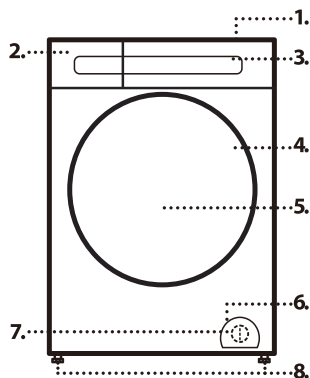

1. 頂板
2. 洗衣劑盒
3. 控制面板
4. 機門門把
5. 機門
6. 底座後面的排水泵
7. 底座
8. 可調機腳(4)

洗衣劑盒

衣物消毒液格

- 用於放置衣物消毒液。建議使用含有氯甲基二醇成分的衣物消毒液。必須根據消毒液使用份量指引放入消毒液，以避免對衣物造成損害。

柔順劑格

- 柔順劑將會於最後一次過水時自動注入滾筒內。
- 請根據產品說明書的規定使用柔順劑。

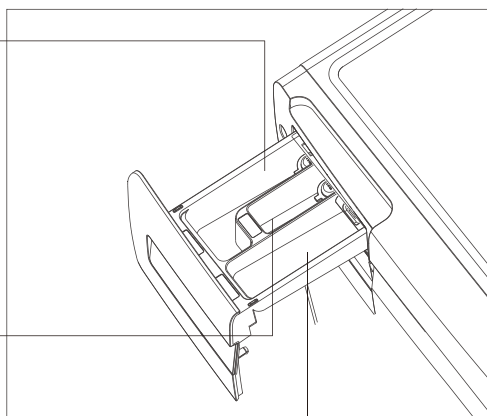

主洗格

- 用於放置主洗用的洗衣劑。可使用液體洗衣劑或粉狀洗衣劑。
- 對於不易溶解的如粉狀皂片，請預先充分溶解皂片後再倒入洗衣粉格內。

- 請使用專用於前置式洗衣乾衣機的洗衣劑。
- 使用合適劑量的洗衣劑可達至良好洗滌效果，同時避免過多泡沫或洗衣劑殘留於衣物上。
- 請按照洗衣劑包裝上的說明，並根據所洗的衣物種類、顏色、水溫及污漬程度等使用合適的洗衣劑。

連接供水資料表

連接供水

| 供水 | 冷水 |
|-------|-------------------|
| 最低的水壓 | 30 kPa (0.3bar) |
| 最高的水壓 | 1000 kPa (10 bar) |

控制面板

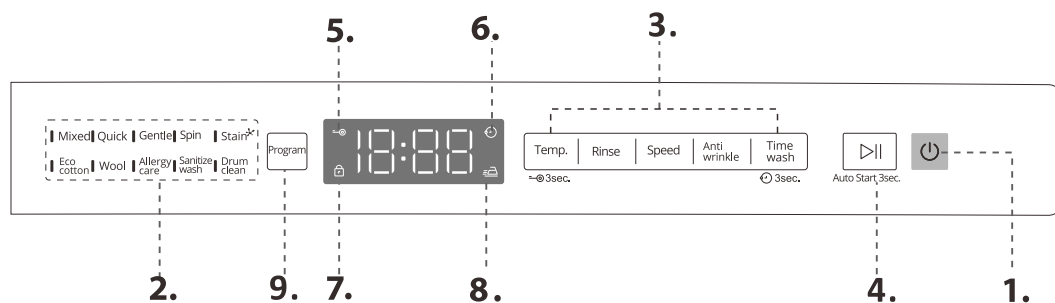

1. 電源「開/關」鍵
2. 「程序」顯示燈
3. 「功能選項」鍵
4. 「啟動/暫停」鍵
5. 兒童安全鎖顯示燈
6. 延遲關機時間顯示燈
7. 門鎖顯示燈
8. 除皺功能顯示燈
9. 「程序」鍵

程序

請根據衣物標籤上的指示，選擇合適用於您的衣物種類的洗滌程序。標籤中會標示出您的衣物可接受的最高洗滌溫度。

混合洗

- 適用於由棉、麻、人造纖維及其混合織物製成的輕微或一般骯髒的彈性衣物。
- 此程序下可點選功能選項鍵選擇溫度、轉速及深層過水次數。

15'極速洗

- 用於快速清洗少量輕微骯髒的衣物。
- 此程序下可點選功能選項鍵選擇溫度、轉速及深層過水次數。

輕柔洗

- 用於質料纖細的衣物。建議清洗前先將衣物內側反轉向外。
- 此程序下可點選功能選項鍵選擇溫度、轉速及深層過水次數。

脫水

- 旋轉脫水以移除衣物水份。
- 此程序下可點選功能選項鍵選擇轉速及深層過水次數。調節過水次數後，則可用於「過水及脫水」。

高效除漬

- 用於一般至非常骯髒的衣物。
- 此程序下不可點選功能選項鍵選擇溫度、轉速及深層過水次數。

棉質節能洗

- 用於清洗普通的棉質衣物，在水溫60°C下是標準的棉質程序，屬能源標籤的參考程序。
- 此程序下可點選功能選項鍵選擇溫度、轉速及深層過水次數。

羊毛

- 用於可機洗的羊毛類衣物。若想達到最佳清洗效果，建議使用適用於羊毛衣物的洗衣劑，並且不要超過最大洗衣量。
- 此程序下可點選功能選項鍵選擇溫度、轉速及深層過水次數。

過敏防護

- 有效去除塵蟎、花粉、毛皮等過敏原。此程序下可點選功能選項鍵選擇溫度、轉速及深層過水次數。

高效殺菌

- 此程序需要加入衣物消毒劑於指定的衣物消毒液格，從而最有效地移除及防止細菌滋生。
- 此程序下可點選功能選項鍵選擇溫度、轉速及深層過水次數。

清潔滾筒

- 只適用於清潔滾筒，利用高溫對滾筒進行有效消毒，移除污漬及細菌。
- 此程序下不可點選功能選項鍵選擇溫度、轉速及深層過水次數。

選項

溫度

- 每個程序都有預設溫度。若想改變溫度，按「溫度」鍵。數值會顯示在顯示屏上。
- 長按3秒此鍵可啟動兒童安全鎖。

脫水轉速

- 每個程序都有預設脫水轉速。若想改變脫水轉速，按「脫水轉速」鍵。數值會顯示在顯示屏上。

隨心洗

- 您可根據喜好選擇不同的預設洗滌時間，操作既有彈性又省時。
- 長按此鍵3秒可設定程序結束時間。當此功能啟動時，圖標  的燈會出現於顯示屏上。若想取消延遲關機選項，請再次長按3秒此鍵。

深層過水



- 根據實際需要設定過水次數，提升過水效能，減少殘留。
- 特別適用於處理皮膚敏感人士衣物。

除皺

- 此選項可去除異味並有助於衣物除皺。抗皺選項在程序結束後啟動，緩慢轉動滾筒以達至除皺效果。最長持續時間為8小時，您可以隨時按控制面板上的  鍵中斷它。

功能

開/關

- 啟動洗衣機：請按「開/關」鍵 
- 於程序結束後關閉洗衣機：長按「開/關」鍵  直至顯示燈熄滅。
- 為了節約能源，當洗衣機沒有由人手操作關閉，洗衣機於程序完畢後10分鐘會自動關閉。

啟動/暫停

- 完成點選功能及選項後，可按此鍵啟動洗衣機。在程序運行中需要暫停程序，可再次按下暫停鍵。
- 於關機狀態下，長按此鍵3秒可啟動「一鍵啟動」程序。最大洗衣量為7公斤。可以選擇轉速及深層過水次數。

 不建議用於羊毛或絲質衣物。

程序選擇

- 當洗衣機開機後，您可以根據衣物的多少及骯髒程度選擇洗衣程序。
- 長按程序按鍵可以跳過程序直至想要的程序出現。

兒童安全鎖

- 你可啟動兒童安全鎖以防止程序被更改，特別是當洗衣機附近有兒童。功能啟動後，機門及控制面板都會自動鎖上。當功能解除後，機門將會解鎖。
- 啟動洗衣機後，長按「溫度」功能鍵3秒直至有提示音響起，兒童安全鎖將會被啟動，重複以上步驟就可關閉兒童安全鎖。

添加衣物

- 洗衣程序開始後，機門將會鎖上。若想中途添加衣物，可按「啟動/暫停」鍵，待門鎖顯示燈關閉後，門鎖將會解除(於水位不會過高，水溫低於50°C的情況下)。當顯示屏顯示「Add」，就可從滾筒內打開機門添加或拿走衣物。添加衣物後，關上機門並按「啟動/暫停」鍵之後，洗衣機將會繼續運作。
- 如果强行打開機門可能會對機件造成損害及造成危險。

程序表

| 程序 | 溫度 | | 過水次數 | 最高脫水轉速 (轉/分鐘) | | 最大洗衣負載量 (公斤) | | | | 程序 時間 | 随心洗 | 除皺 | 洗衣劑和添加劑 | | |
|--------|------|----------|------------------|------------------|------------------|-----------------|-----|-------|--------|----------|-----|----|-----------|-----------|-----|
| | 預設 | 溫度範圍 | | 8公斤 | 9/9.5/ 10.5公斤 | 8公斤 | 9公斤 | 9.5公斤 | 10.5公斤 | | | | 衣物 消毒劑 | 主洗 洗衣劑 | 柔順劑 |
| 混合洗 | 30°C | ☼ - 60°C | 預設：2 可調範圍：0-6 | 1200 | 1400 | 6 | 6.5 | 6.5 | 7 | 1:02 | ✓ | ✓ | - | ✓ | ✓ |
| 棉質節能洗 | 60°C | ☼ - 60°C | 預設：2 可調範圍：0-6 | 1200 | 1400 | 8 | 9 | 9.5 | 10.5 | 1:27 | - | - | - | ✓ | ✓ |
| 15'極速洗 | ☼ | ☼ - 30°C | 預設：1 可調範圍：0-4 | 1000 | 1000 | 1 | 1 | 1 | 1 | 0:15 | ✓ | ✓ | - | ✓ | ✓ |
| 輕柔洗 | 30°C | ☼ - 40°C | 預設：3 可調範圍：0-6 | 1000 | 1000 | 2 | 3 | 3 | 4 | 1:31 | ✓ | ✓ | - | ✓ | ✓ |
| 脫水 | - | - | 預設：0 可調範圍：0-6 | 1200 | 1400 | 8 | 9 | 9.5 | 10.5 | 0:11 | ✓ | ✓ | - | - | ✓ |
| 高效除漬 | 40°C | - | 預設：2 | 800 | 800 | 3 | 3.5 | 3.5 | 4 | 1:30 | - | ✓ | - | ✓ | ✓ |
| 羊毛 | ☼ | ☼ - 40°C | 預設：2 可調範圍：0-6 | 800 | 800 | 2 | 2 | 2 | 2 | 1:04 | ✓ | ✓ | - | ✓ | ✓ |
| 過敏防護 | 60°C | 60-90°C | 預設：3 可調範圍：0-6 | 1200 | 1400 | 4 | 4.5 | 4.5 | 5 | 2:03 | ✓ | ✓ | - | ✓ | ✓ |
| 高效殺菌 | 40°C | 40-90°C | 預設：2 可調範圍：0-6 | 1200 | 1400 | 6 | 6.5 | 6.5 | 7 | 1:47 | ✓ | ✓ | ✓ | ✓ | ✓ |
| 清潔滾筒 | 90°C | - | 預設：1 | 800 | 800 | 0 | 0 | 0 | 0 | 2:18 | - | - | - | ✓ | ✓ |

✓ 當你調整過水次數時，你可添加柔順劑。

新加坡/香港

棉質節能洗 □ 這是在額定負載下清洗一般髒污的衣物的推薦程序，根據IEC 60456標準的測試洗滌週期。這是能源標籤的參考程序。將此洗滌週期設置為 60°C。就洗滌一般髒污的棉布衣物而言，它們是能源和水消耗最有效的程序。實際水溫可能與聲明的水溫不同。

適用於所有測試機構

適用於棉質衣物時間較長的程序：設定60°C的「棉質節能洗」程序。

進水溫度、水壓等條件或會有變化，導致您家中的數據可能會有不同。近似的程序持續時間值是指程序的默認設置，沒有選項。

機門

拉動手柄以打開機門。

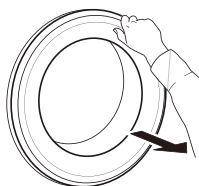

要關閉機門，請握著手柄推動機門直至聽見「咔嚓」一聲。

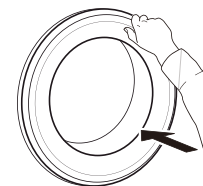

配件

聯繫我們的售後服務，檢查以下配件是否適用於您的洗衣機（和乾衣機）型號。

| 使用說明書 | 運輸螺栓塑膠蓋 (4個) | 進水軟管組件 | 板手工具 | 產品保用資訊 (印於說明書內) | U型管 |
|-------|--------------|--------|------|-----------------|-----|
| | | | | | |

固定架：可將您的乾衣機固定在洗衣機的頂部，以節省空間及便於裝載及卸載您的乾衣機於較高的位置。

如何使用洗衣機

日常使用

準備衣物

清空衫袋



- 硬幣、萬字夾等可能會對衣物及洗衣機造成損壞。
- 紙巾會於洗衣過程中散落於衣物上，碎屑隨後需要用人手移除。



拉上及扣上所有拉鏈、衫鈕及勾。綁好所有絲帶或腰帶。



- 將細件衣物（例如尼龍襪、腰帶等）及有勾的衣物（例如胸圍）放入洗衣袋或帶有拉鏈的枕頭套。從窗簾上取下任何掛環，或者將窗簾與環一起放在布袋中。

使用步驟

1. 放入衣物



打開機門並放入衣物。一次一件地將鬆開了的衣物放入滾筒中，不要裝得太滿。檢視「程序表」中的負載量。放入過量衣物會導致清洗效果未如理想及弄皺衣物。

2. 關閉機門



請確保沒有衣物卡在機門玻璃及塑膠圈之間。關上機門時應該可聽見「咔嚓」一聲。

3. 打開水龍頭



請確保洗衣機已連接供水系統，之後打開水龍頭。

啟動洗衣機

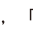
按下「開/關」按鍵 ，「啟動/暫停」顯示燈  會徐徐閃爍。控制面板上將會顯示你上一次最後使用的程序設定。

4. 選擇所需程序

按下「程序」按鍵選擇所需程序。顯示屏上會顯示出對應的程序時間。若有需要，可點選既定的按鈕調節溫度及脫水轉速。

衣物類型 / 衣物標籤上的圖標

- 棉、混合纖維、簡易護理/合成纖維、羊毛、手洗物品。
- 顏色衣物
分開清洗有色及白色衣物。
單獨清洗新的有色衣物。
- 衣物尺寸
在相同洗衣負載量下洗滌不同尺寸的衣物，可提升洗衣效果及滾筒內的衣物分佈。
- 精緻衣物
分開清洗精緻衣物；精緻衣物需要溫和處理。

設定溫度（若需要）

點選「溫度」按鍵一下，顯示屏上將會顯示出程序所預設的溫度。再次點選「溫度」按鍵可於既定範圍內選擇不同溫度。

設定脫水轉速（若需要）

點選「脫水轉速」按鍵一下，顯示屏上將會顯示出程序所預設的轉速。再次點選「脫水轉速」按鍵可於既定範圍內選擇不同轉速。

設定過水次數（若需要）

點選「過水」按鍵一下，顯示屏上將會顯示出程序所預設的過水次數。繼續點選「過水」按鍵直至顯示最多可設定次數，之後再點選「過水」按鍵，顯示屏上沒有任何顯示，表示過水次數為零。

設定清洗時間（若需要）

點選「隨心洗」按鍵一下，顯示屏上將會顯示出程序所預設的清洗時間。再次點選「隨心洗」按鍵可於既定範圍內選擇不同清洗時間。

選擇其他功能（若需要）

點選按鈕選擇選項。程序參數將顯示在屏幕上。

 如果所選選項與程序不兼容，則將通過蜂鳴器（2聲蜂鳴）發出不兼容信號。

5. 加入洗衣劑

 拉出洗滌劑分配器並將洗滌劑（和添加劑/柔順劑）添加到相關間隔中，如「洗衣劑盒」部分所述。遵守洗滌劑包裝上的劑量建議。

加入正確分量的洗衣劑/添加劑是很重要的，因為：

- 它優化了洗滌效果
- 它可以避免您的衣物上殘留多餘具刺激性的洗滌劑
- 避免浪費洗衣劑以節省金錢
- 通過避免組件鈣化來保護洗衣機
- 避免多餘的殘留為環境帶來不必要的負擔

6. 延遲關機時間

- 長按「隨心洗」鍵3秒可設置程序結束時間。

7. 開始洗衣程序

- 用戶選擇洗衣程序後，左側LED燈會亮起，按「▶|||」，機門會被鎖上。
- 為避免溢出，在程序運行期間不要再打開洗衣劑盒。
- 顯示屏上顯示的剩餘程序時間可能會有所不同。洗滌負荷不平衡或泡沫形成等因素會影響程序時間。

8. 改變運行中的程序設定 (若需要)：

在程序運行過程中，你依然可以修改設定：

- 按「啟動/暫停」鍵 ▶||| 暫停運行中的程序。
- 修改設定。
- 按「啟動/暫停」鍵 ▶||| 繼續運行程序。

若你修改了程序，請不要重新為新程序添加洗衣劑。

為防止運行中的程序被意外修改（例如被兒童），請啟用「兒童安全鎖」=O（請參考「功能」篇章）。

暫停運行中的程序並打開機門 (若需要)：

- 按「啟動/暫停」鍵 ▶||| 暫停運行中的程序。
- 當水位不是太高，水溫低於50°C，顯示屏上顯示的門鎖燈  會熄滅，你可以打開機門，例如添加更多衣物，或拿出錯誤放入的衣物。
- 按「啟動/暫停」鍵 ▶||| 繼續運行程序。

9. 取消運行中的程序設定 (若需要)：



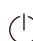

- 按住「開/關」鍵  直至洗衣機停止運作。
- 當水位及水溫足夠低，機門會解鎖，你可以打開機門。
- 若洗衣機滾筒內依然有水，機門會保持鎖上。若想解鎖機門，請開啟洗衣機，點選脫水程序，將脫水轉速調至「--」以將脫水轉速調至0。
- 當滾筒內水已清空，機門會於程序結束時解鎖。

10. 程序結束後關閉洗衣機

- 於最後階段，洗滌程序結束後，在默認狀態下，洗衣機會發出蜂鳴聲提示用戶。如果不需要蜂鳴器提示，可以取消設置（按下「開/關」鍵開啟洗衣機後，長按「啟動/暫停」鍵當第二次聽到蜂鳴聲時，即表示蜂鳴提示已關閉。
- 當顯示屏上顯示的門鎖燈  熄滅，你可以打開機門。
- 檢查門解鎖符號是否亮起，然後打開門取出衣物。
- 按「開/關」鍵  關閉洗衣機。

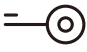
為節省能源，如果洗衣機未通過手動關閉，則在程序結束約 10 分鐘後自動關閉。請讓門半開，讓洗衣機內部乾燥。

顯示屏圖標

| | | |
|---|--------|--|
|  | 兒童安全鎖 | 圖標會亮起來： 當兒童安全鎖啟動。所有按鍵（電源鍵除外）將會上鎖。 |
|  | 除皺 | 圖標會亮起來： 當除皺功能啟動。 |
|  | 延遲關機時間 | 圖標會亮起來： 當延遲關機時間功能啟動。 |
|  | 門鎖 | 圖標會亮起來： 1. 當洗衣程序運行中。 2. 滾筒內溫度很高。 3. 滾筒內水位高。 |
|  | 添加衣物 | 圖標會亮起來： 當機門可被打開以添加或拿走衣物。 |





提示與貼士

衣物分類的規則

- 織物類型/標籤上的說明（棉、混合纖維、合成纖維、羊毛、手洗物品）
- 顏色（將有色衣服與白色衣服分開，單獨清洗新的有色衣服）
- 尺寸（在同一負載下洗滌不同尺寸的物品，以提高洗滌效率和滾筒內的重量分佈）
- 精緻物品（將小件物品 - 如尼龍襪和帶扣的衣服 - 如胸圍，放在洗衣袋或帶拉鍊的枕套中。）

服裝標籤上的洗滌符號

符號中寫的數值是指洗滌衣物的最高溫度。

-  一般機洗
-  一般機洗（請使用較溫和的程序）
-  一般機洗（請使用非常溫和的程序）
-  只可手洗
-  不可洗

定期清洗過濾器

- 這是防止過濾器堵塞和令殘留水正確排出所必需的。

節約能源及保護環境

- 遵循「程序表」中的指示，將衣物負載限制在指示內，以優化能源、水和洗滌劑的消耗並減少洗滌時間。
- 不要超過洗滌劑製造商推薦的洗滌劑用量。
- 通過使用 60°C 代替 90°C 洗滌程序或使用 40°C 代替 60°C 洗滌程序來節省能源。我們建議使用「棉質節能洗」程序，它的時間更長，但耗能更少。
- 為了在洗滌時節省能源和時間，請為程序選擇可用的最高脫水速度，以減少洗滌程序結束時衣物中殘留的水份。
- 使用合適的去污劑預處理任何污漬，或者在洗滌前用水沾濕任何干燥的污漬，因為這可減少使用高溫程序的需要。
- 15'極速適用於快速洗滌帶有少量污漬的少量衣物。

清潔與保養

若要進行清潔及保養，請先關閉洗衣機並拔掉電源。
請不要用易燃液體清潔洗衣機。

清潔洗衣機外部

使用柔軟的濕布清潔洗衣機的外部部件。

請勿使用玻璃或通用清潔劑、去污粉或類似物質清潔控制面板 - 這些物質可能會損壞印字。

檢查供水管

定期檢查進水軟管是否易脆和有裂紋。如果損壞，請使用我們的售後服務或您的專業經銷商提供的新軟管更換。

根據軟管類型：



如果進水軟管有透明塗層，請定期檢查局部顏色是否變深。如果是，則軟管可能有洩漏，應更換。

清潔進水軟管中的網狀過濾器

1. 關閉水龍頭並擰下進水軟管。

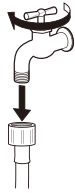

2. 用細刷仔細清潔軟管上的網狀過濾器。

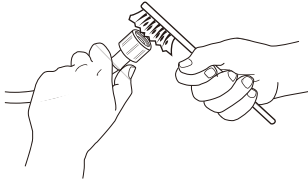

3. 現在用手擰下洗衣機背面的進水軟管。用鉗子從洗衣機背面的閥門中拔出網狀過濾器並仔細清潔。

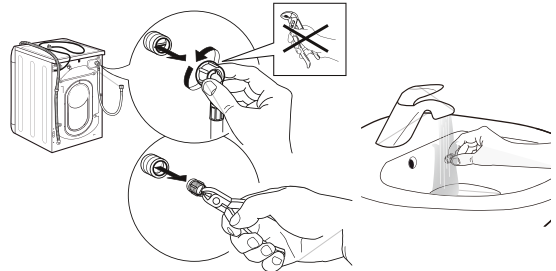

4. 再次插入網狀過濾器。將進水軟管連接到水龍頭和洗衣機。請勿使用工具連接進水軟管。打開水龍頭並檢查所有連接是否緊固。

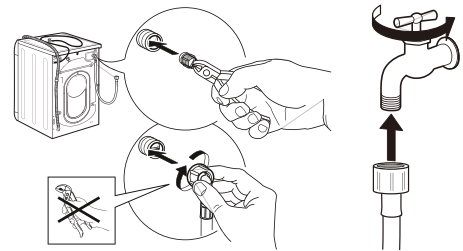

清潔洗滌劑盒

1. 按一下並拉出洗衣劑盒。

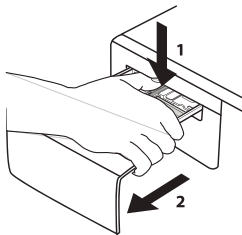

2. 從柔順劑隔間中取出插件。

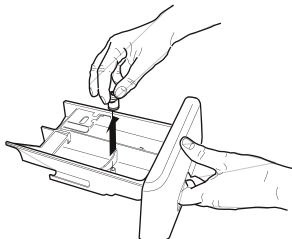

3. 用水沖洗所有部件，去除所有殘餘的洗衣劑或柔順劑。

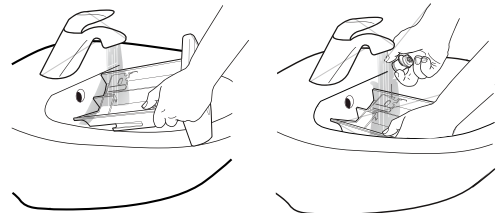

4. 用軟布擦乾洗衣劑盒。



5. 重新安裝洗衣劑盒並將其推回原位。

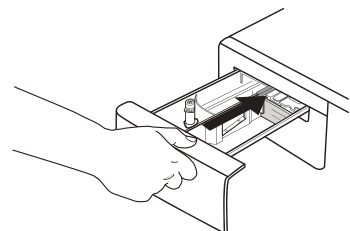

清潔濾水器/排出殘留的水

在清潔濾水器或排出殘留水之前，請關閉洗衣機並拔下電源插頭。如果您使用了熱洗程序，請等到水冷卻後再進行排水。定期清洗濾水器，避免濾水器堵塞導致洗後水無法排出。如果水不能排出，顯示屏上會顯示代碼表示未能排水。

1. 關閉電源並從電源插座上拔下洗衣機的插頭。

2. 輕輕按下過濾器蓋的頂部扣將其打開。

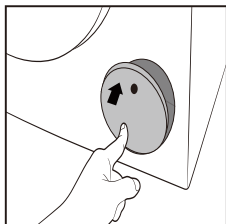

3. 在泵附近放置一個容器以收集任何溢出物。

4. 將「緊急排水軟管」拉到容器上。

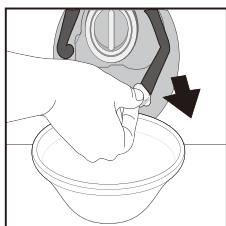

5. 轉動過濾器手柄並將其拉出。轉動軟管末端「緊急排水軟管」的塞子，讓水流入容器。當容器裝滿水時，將塞子塞到軟管末端，然後將軟管重新插入洗衣機底座。之後，清空容器。

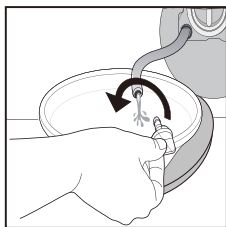

6. 移除過濾器：在附近放置一條毛巾以收集溢出水，逆時針轉動過濾器手柄並將其拉出。

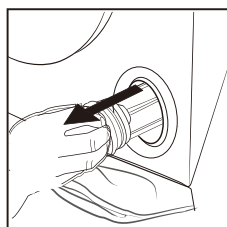
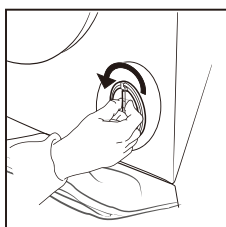

7. 清潔排水泵過濾網：移除過濾網上的殘餘物並用水沖洗。

8. 插入排水泵過濾器：順時針方向轉動排水泵過濾器，將其重新插入。確保盡可能地將擰緊；過濾器手柄必須處於垂直位置。要測試排水泵過濾器的緊密程度，您可以將大約 1 升的水倒入洗衣劑盒中。

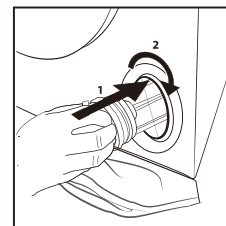

疑難排解

洗衣機可能因為不同原因無法正常運作。聯絡售後服務中心之前，建議先自行進行檢查，看問題是否可以下列的簡易方法解決。

| 異常問題 | 原因 / 解決方法 |
|----------------|--|
| 洗衣機無法啟動 | <ul style="list-style-type: none"> - 插頭沒有正確插在插座內。 - 插座供電異常，按「開/關」鍵重設洗衣機。 - 機門未正確關閉。 |
| 洗衣程序無法啟動 | <ul style="list-style-type: none"> - 未按下「開/關」鍵。 - 未按下「啟動/暫停」鍵。 - 水龍頭未打開。 - 已設定延遲關機時間。 |
| 洗衣機無法進水 | <ul style="list-style-type: none"> - 進水管未連接到水龍頭。 - 進水管被壓扁或扭結。 - 水龍頭未打開。 - 自來水未有供應。 - 水壓過低。 |
| 洗衣機不停入水和排水 | <ul style="list-style-type: none"> - 未按下「啟動/暫停」鍵。 - 排水管未正確安裝於離地面65至120厘米的位置。 - 排水管末端位置低於水面。 - 排水管未正確導入直管內。 <p>進行以上檢查後，如故障仍然存在，請關閉水龍頭及電源；並聯絡售後服務中心。如居住較高樓層，操作時洗衣機或會出現虹吸現象，並持續入水和排水。建議加配防回流閥以解決回流問題。</p> |
| 排水或脫水故障 | <ul style="list-style-type: none"> - 所選程序並不包括排水，某些洗衣程序需要手動以排水。 - 排水喉管被壓扁或扭結。 - 排水管或洗滌盆阻塞。 |
| 脫水時機身震動過大 | <ul style="list-style-type: none"> - 安裝時運輸螺栓和包裝材料未被正確除下。 - 洗衣機機腳不平。 - 機器被夾於家具和牆壁之間，令其無法平衡擺放。 |
| 洗衣機 / 洗滌劑投放盒漏水 | <ul style="list-style-type: none"> - 進水管未正確擰緊或有所損壞 (需更換喉管)。 - 洗滌劑投放盒阻塞，需要清洗。 - 排水管未正確擰緊。 |
| 顯示屏上出現錯誤代碼 | <ul style="list-style-type: none"> - 關閉電源並拔下電源插頭，約一分鐘後重開洗衣機。如果故障仍然存在，請聯絡售後服務中心。 |
| 泡沫過多 | <ul style="list-style-type: none"> - 洗衣劑不適用於洗衣機(參考洗衣劑的註明，檢查洗衣劑上的標籤是「適合機洗」或「適合手洗」，或其他相關註解)。 - 過量的洗衣劑會造成太多泡沫。 |
| 脫水時出現噪音 | <ul style="list-style-type: none"> - 電源線或其它物件觸碰到機器。 - 安裝時運輸螺栓和包裝材料未被正確除下。 - 滾筒內有硬幣，髮夾等細小物品。 |

| 故障代碼 | 現象 | 檢查項目 | 解決辦法 |
|-------|--------|--|-------------------------------------|
| 無任何顯示 | 停止運作 | <ul style="list-style-type: none"> ● 插座是否有電。 ● 插座是否已經正確接駁。 ● 是否供電異常。 ● 電源保險絲是否熔斷。 | |
| E11 | 未能進水 | <ul style="list-style-type: none"> ● 檢查水龍頭是否已打開。 ● 檢查水管有否結冰。 ● 檢查過濾器是否被堵塞。 ● 檢查停水與否。 | 按「啟動/暫停」鍵。 |
| E12 | 未能進行排水 | <ul style="list-style-type: none"> ● 確保排水管在正確的位置。 ● 排水管高度是否過高。 ● 確保排水管沒有堵塞。 ● 確保排水管長度正確。 | 按「啟動/暫停」鍵。 |
| H | 機門未能打開 | <ul style="list-style-type: none"> ● 確保不要使用熱水。 ● 洗滌時水溫或水位較高。 | 當溫度降至安全水平時，將自動解鎖。 |
| U3 | 未能進行脫水 | <ul style="list-style-type: none"> ● 請確保機器水平放置。 ● 避免同時放置多件重物負載。 ● 避免將毯子捲著放入機器中。 | 重新放置衣物，添加2-3件小衣服，然後按「啟動/暫停」鍵重新開始操作。 |
| U4 | 機門未關 | | 關上門，直到「門鎖顯示燈」亮起，確認後按「啟動/暫停」鍵重新操作。 |
| 其他代碼 | 警報 | | 按「啟動/暫停」鍵重新運行，如仍不能解決問題，請聯繫服務中心。 |

售後服務

在致電售後服務之前

1. 看看能否借助「疑難排解」中給出的建議自行解決問題。

2. 關閉設備再重新打開，看看故障是否仍然存在。

如果以上檢查後故障仍然存在，請與就近的售後服務中心聯繫。

聯繫我們的客戶售後服務時，請務必說明：

- 故障的簡要描述；
- 產品類型和型號；

- 您的完整地址；
- 您的電話號碼。

如果需要維修，請聯繫授權的售後服務（以保證使用原廠零件並正確地進行維修）。

