



Refrigerator Series

WF1D061RXG



Dear User,

Thank you for choosing our products. We are sure you will find your new appliance is pleasure to use. Before you use the appliance, we recommend that you read through these instructions carefully and retain for future reference. Design and specification may change due to product development, no prior notice will be given.

TABLE OF CONTENTS

Refrigerator Safety.....	3-5
Proper Disposal of your Old Refrigerator.....	6
Installation Instructions	
Product Diagram.....	7
Unpacking.....	7
Location requirements.....	8
Electrical requirements.....	9
Product Introduction	
Temperature Control.....	10
Maintenance	
Defrosting and Cleaning Your Refrigerator.....	11
Power Interruptions.....	12
Moving.....	12
Long Term Stop of Refrigerator.....	12
Changing The Reversible Door.....	13
Trouble Shooting.....	14-15
Specification.....	16

REFRIGERATOR SAFETY

Your safety and the safety of the others are very important.

We are provided many important safety messages in this manual and on your appliance.

Always read and obey all safety messages.



This is the safety alert symbol.

This symbol alerts you to potential hazards that can kill or hurt you and others.

All safety messages will follow the safety alert symbol and either the word "DANGER" or "WARNING".

The word means:

⚠ DANGER

You can be killed or seriously injured if you don't immediately follow instructions.

⚠ WARNING

You can be killed or seriously injured if you don't follow instructions.

All safety messages will tell you what the potential hazard is, how to reduce the chance of injury and what can happen if the instructions are not followed.

IMPORTANT SAFETY INSTRUCTIONS

WARNING: To reduce the risk of fire, electric shock, or injury when using your Refrigerator, follow these basic precautions:

- Plug into a grounded 3 prong outlet.
- Keep flammable materials and vapors, such as gasoline, away from refrigerator.
- Do not remove ground prong.
- Do not use an adapter.
- Do not use an extension cord.
- Disconnect power before servicing.
- Remove doors or lid from your old freezer or refrigerator.
- Use nonflammable cleaner.

SAVE THESE INSTRUCTIONS

Please read this product instruction carefully and keep it for future use.

SAFETY INFORMATION:

- This refrigerator is design for 220-240V. Please make sure the voltage is corresponding to your home. The product may be damaged due to the incorrect voltage has been used and the product warranty will not be included.
- This appliance is used for food cooling only. Please do not use for other purpose.
- This appliance is intended to be used in household, it should not be used for other purposes or under other circumstances, such as in non-domestic or commercial environments. Do not use easily-damage power cord or plug. It may cause fire or electric shock. If appliance is damaged or cannot operate in normal condition, please contact customer service center for help.
- As this appliance is very heavy, please move it carefully to prevent hurt.
- This appliance is intended to use in indoor only. (This appliance should not be exposed to rain).
- Before repair or the refrigerator will not be used for long time, please disconnect the power plug. 切
- Keep away from heat source and avoid direct sunlight.
- This appliance is intended to be used for food cooling and ice making.
- To prevent child was locked in refrigerator during disposal the refrigerator, please make sure the refrigerator is out of service and all the door and shelves are in fixed position before disposal.

WARNING:

-
- If the power cord is damaged, please contact customer service centre or qualified personnel to repair or replace to avoid a hazard.
- This appliance is not intended for use by persons (including children) with reduced physical, sensory or mental capabilities, or lack of experience and knowledge, unless they have been given supervision or instruction concerning use of the appliance by a person responsible for their safety.
- Children should be supervised to ensure that they do not play with the appliance.
- WARNING: Keep ventilation openings, in the appliance enclosure or in the built-in structure, clear of obstruction.
- WARNING: Do not use mechanical devices or other means to accelerate the defrosting process, other than those recommended by the manufacturer.
- WARNING: Do not use electrical appliances inside the food storage compartments of the appliance, unless they are of the type recommended by the manufacturer.
- WARNING: Do not store explosive substances such as aerosol cans with a flammable propellant in this appliance.
- WARNING: Do not damage the refrigerant circuit.
- WARNING: When positioning the appliance, ensure the supply cord is not trapped or damaged.
- WARNING: Do not locate multiple portable socket-outlets or portable power supplies at the rear of the appliance.

IMPORTANT NOTICE:

- The operation temperature of this appliance is between 16 ~ 38 Degree Celsius. If the ambient temperature is out of the operation temperature range, the appliance will not operation in normal condition. If the ambient temperature is out of the range for long period, the temperature inside the refrigerator will increase and food may result in food deterioration which may not suitable for eat.
- Wipe the inner and outer surface of the refrigerator and its accessories with a wet cloth. If too dirty, scrub them with neutral detergent, and then clean them with water and dry them with a clean cloth.
- For first time to use the refrigerator or after defrost, please adjust the thermostat setting to maximum for 2 hours, after that adjust the thermostat to normal setting before storage food.
- Please keep 10cm of space between the refrigerator from side to the wall for ventilation.
- This appliance is not built-in refrigerator. Please install the refrigerator in a flat and solid floor. If the refrigerator is not balance, please adjust the adjustable foots.

Proper Disposal of Your Old Freezer or Refrigerator

! WARNING

Suffocation Hazard

Remove doors or lid from your old freezer or refrigerator.
Failure to do so can result in death or brain damage.

IMPORTANT: Child entrapment and suffocation risk. Junked or abandoned freezers or refrigerators are still dangerous... even if they will sit for “just a few days.”

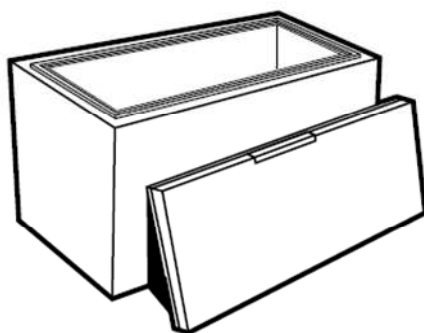

BEFORE YOU THROW AWAY YOUR OLD FREEZER OR REFRIGERATOR REMOVE THE DOORS OR LID.

Product Disposal:

The refrigerator's R600a refrigerant and cyclopentane foam materials are combustible materials and discarded refrigerators should be isolated from the source and cannot be burned. Please transfer the freezer to qualified professional recycling companies for processing to avoid damages to the environment or other hazards.

INSTALLATION INSTRUCTIONS

Name of parts

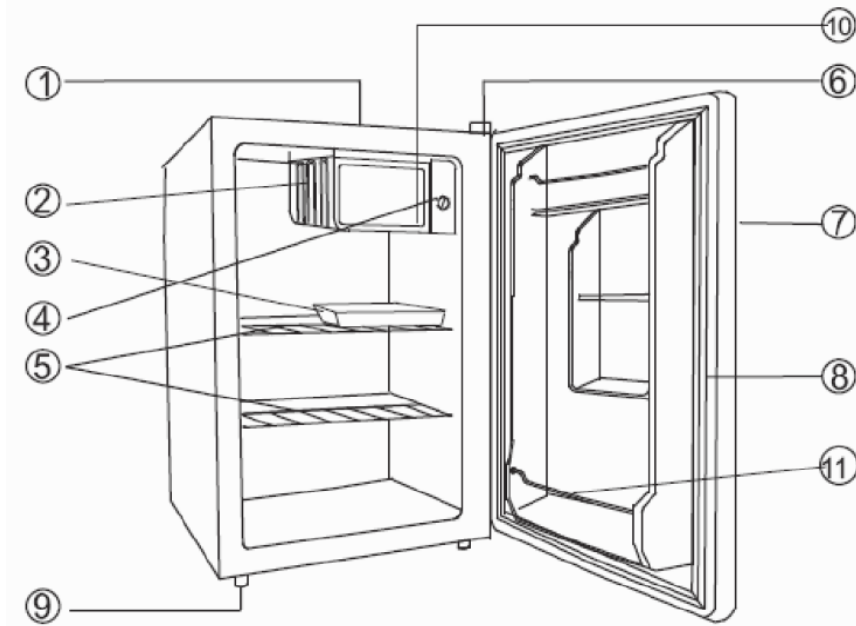

1. Cabinet
2. Evaporator
3. Drip Tray
4. Thermostat Knob
5. Wire Shelves
6. Hinge Cover
7. Door
8. Door Gasket
9. Adjustable Foot
10. Ice Box Compartment
11. Door Bar

UNPACKING

- Unpack all the packing materials including the base and adhesive tape.
- Boiling water, eradicator, acid or alkaline detergent, soap, abrasive powder, gasoline, thinner, alcohol, benzene organic solution and brush are not allowed to use for cleaning.
- It is recommended to clean the refrigerator by neutral detergent before use.

LOCATION REQUIREMENT

! WARNING



Explosion Hazard

Keep flammable materials and vapors, such as gasoline, away from freezer.

Failure to do so can result in death, explosion, or fire.

1. Keep the refrigerator away from flammable materials (e.g. alcohol, gasoline, etc...) strong corrosive acids and alkalis. Do not put microwave oven, plug socket, voltage regulator, thermos, electric furnace, candles, fish tank etc...on top of the refrigerator.
2. Before installing the refrigerator, please check whether the intensity of the floor is sufficient to support the weight of the refrigerator after being filled with food.
3. To let the door close firmly, the refrigerator should be kept at the same level. Please put the refrigerator on the mat if necessary.
4. Please keep 10cm of space from the side to the wall, at least 10cm from the back to the wall and enough space to ensure the door can open.
5. The refrigerator should be placed on a flat and solid floor. If the refrigerator is not stable, adjusting the adjustable feet can fix the problem.
6. Do not place the refrigerator in humid or watery place such as garage or cellar to prevent rust or reduction of insulating effect.
7. Keep away from heat sources and avoid direct sunlight.

ELECTRICAL REQUIREMENT

⚠ WARNING



- Plug into a grounded 3 prong outlet.
- Do not remove ground prong.
- Do not use an adapter.
- Do not use an extension cord.

Failure to follow these instructions can result in death, fire, or electrical shock.

- Please read the following information in order to ensure safety.
WARNING: This appliance must be connect to electrical ground
- Operation voltage 220-240V AC, 50 Hz, 13A UK plug.
- If power cord is damaged, please contact customer service center or qualified personnel to repair or replace to avoid a hazard.

PRODUCT INTRODUCTION

Using the Control

Thermostat Knob:

The thermostatic knob is installed in front of the Ice Box Compartment to regulate the temperature in the refrigerator.

TEMPERATURE SETTING

Thermostat setting range from 1 to 5. 1 denotes “low cool” setting and 5 indicates “high cool” setting. In normal condition, it is suggested to set to thermostat knob to “3”. When set at “0”, the refrigerator is off but cannot disconnect the power supply. If need to disconnect the power supplier, must disconnect the power cord.

If want to resume the refrigerator after disconnect the power plug, please wait at least 5 mins, otherwise, the refrigerator will not operate.

Fridge compartment temperature will be affected by

- Compartment temperature setting
- No. of times for door open & close
- Storage food quantity
- Refrigerator location

Please adjust the thermostat according to the ambient conditions.

Using the Ice Box compartment

Ice box compartment is not a freezer compartment or fridge compartment. It cannot cool ice cream or food.

The temperature of ice box compartment is not suitable for food cooling. It can be set to the lowest temperature, but other food in the refrigerator will also be affected.

MAINTENANCE

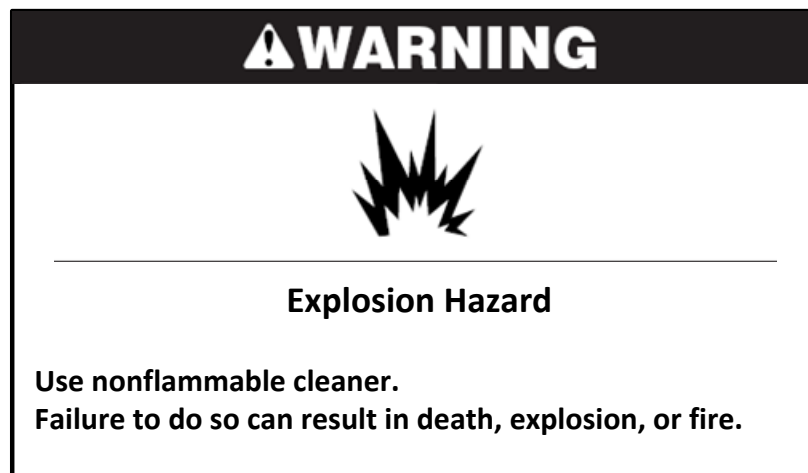

DEFROSTING AND CLEANING YOUR REFRIGERATOR

Water contained in food or in the air inside the refrigerator may form a layer of frost inside. This will weaken the cooling when the frost is thick. Therefore you should defrost manually when the ice is thick. When defrosting, a pan should be put under the evaporator for collecting the defrost water.

Defrosting procedure

Disconnect the power plug and put a pan under the ice box compartment. Throw out the water inside the drip tray after defrost process completed. Please clean the refrigerator after defrost. After cleaning, connect the power plug.

Cleaning procedure

- Unplug or disconnect power before cleaning.
- It is recommended to use a wet cloth with warm water or neutral detergent to wipe the refrigerator and then use dry cloth to clean.
- Please dry the refrigerator before storing the food back.
- Exterior Cleaning: Please use soapy water to clean the exterior of refrigerator.
- There may be sharp edges on the bottom of the product. Be careful when cleaning.

POWER INTERRUPTION

If the power interruption happened, use up the food as soon as possible, and take care of the food is fresh.

MOVING

Please follow the below steps before moving the refrigerator

1. Please remove all the foods inside the refrigerator
2. Disconnect the power plug
3. Remove and seal all the accessories inside the refrigerator and use sticker to fix it.
4. Clean the refrigerator
5. Use sticker to fix the door to ensure door will not open and no parts collision, friction, falling during transportation.

LONG TERM STOP OF REFRIGERATOR

If the refrigerator will not be used for long time, please

1. Disconnect the power plug
2. Clean & dry the refrigerator
3. Leaving a little gap when close the door, and place the refrigerator in a dry and ventilated place.

CHANGING THE REVERSIBLE DOOR

The door of this refrigerator can be changed from the left or right side. Should you desire to reverse the opening direction, please follow below instructions

NOTE:

Before reversing the door, the power must be shut off.

All parts removed must be saved for the reinstallation of the door.

1. Remove the upper hinge cover (6)
2. Remove the two screw (1) which hold the upper hinge (5) (right side) to the frame. Take away the upper hinge.
3. Lift the door and place it on a padded surface to prevent scratching.
4. Remove the two screws (8) that hold the lower hinge (2) and make sure you remove the lower hinge (2).
5. Remove the left front leg (4) and transfer it to right side.
6. Remove the hole cover plate (7) to the right side.
7. Before placing this lower hinge (2), remove the bolt-pin (9) and reverse the direction of the lower hinge (2). Then install the lower hinge (2) onto the left side of the lower frame with two screws (8).
8. Insert the bolt-pin (9) to the lower hinge (2).
9. Set the door to its place make sure the door seat at the lower hinge (2).
10. While holding the door in the closed position secure the upper hinge (5) in the top frame of left side with two screws (1). Please remember not to tighten the two screws (1) until the top of the door is leveled with the counter top.

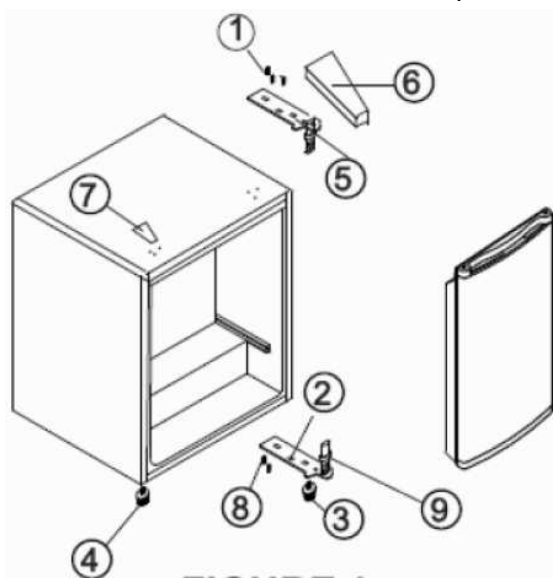

FIGURE 1

Door opening from left side

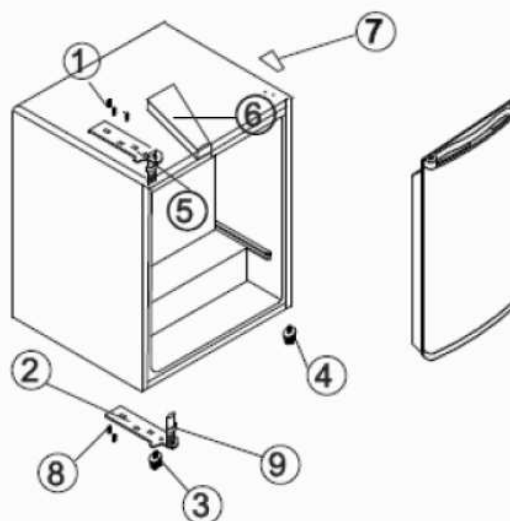

FIGURE 2

Door opening from right side

TROUBLE SHOOTING

For following troubles, check if the possible cause and solution. If the problems still cannot be solved, please contact Whirlpool service centre.

1. Refrigerator does not work:

- Check if there is a power failure
- Check if the power plug is plugged into the power outlet.
- Check that the fuse has not blown.

! WARNING



■ Plug into a grounded 3 prong outlet.

■ Do not remove ground prong.

■ Do not use an adapter.

■ Do not use an extension cord.

Failure to follow these instructions can result in death, fire, or electrical shock.

2. The refrigerator is cooling excessively:

- If you place foodstuff containing a lot of moisture directly under the cool air outlets, they will freeze easily. This does not indicate a malfunction.

3. The refrigerator is not cooling sufficiently:

- The food may be packed too tightly together which will block the flow of cool air.
- Check if there is too many hot or a lot of foodstuff into the refrigerator.
- Check if the door close properly
- Check if the door gasket is damaged or deformed
- Check if the refrigerator may not be ventilated.
- Check if insufficient clearance between the refrigerator and the surface.
- Check if the thermostat knob set in proper setting.

4. Condensation forms on the outside of the refrigerator

Check if the humidity is high like during a wet season. This is the same kind of condensation that forms when cilled water is poured into a glass. If yes, wipe it with dry cloth.

5. Refrigerator with sound like water flowing

A sound like water flowing is the refrigerant flowing. It does not indicate a malfunction.

6. The cabinet's side panel heats up:

The side panel of the cabinet will heat up when the door is opened or closed frequently, when starting the unit and when the unit operates in summer with high ambient temperature outside. In such a case, do not touch the panel, as it results from the dissipation of heat from inside the cabinet, and it does not mean that something is wrong with the refrigerator.

SPECIFICATION

Model	WF1D061
Total Net Capacity (L)	68
Dimension (W*D*H)(mm)	440(W)X510(D) X 640(H)
Rated Voltage (V)	220-240
Frequency (Hz)	50
Net Weight (kg)	17
Refrigerant	R600a
Refrigerant amount (g)	15
Energy consumption (kwh/24h)	0.223 kwh/24h
Energy Efficiency Class	1