



---

洗衣乾衣機  
Washer Dryer

操作指南  
Instructions for use

**AWI75141**

**7<sup>+5</sup>**  
KG

---

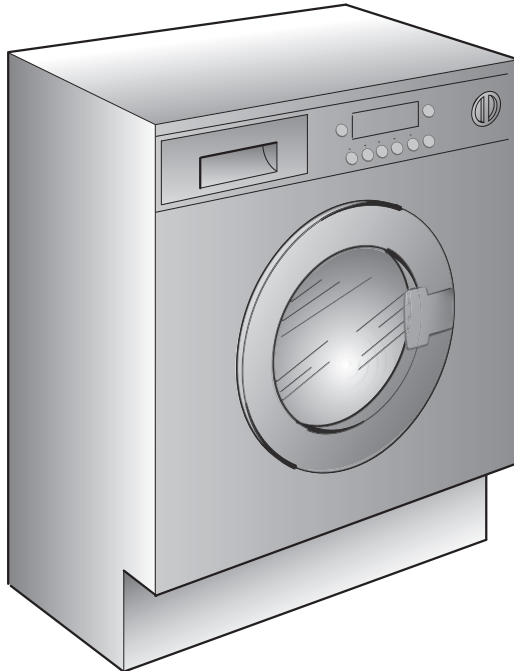

## 概述

請仔細閱讀本操作指南及所有隨本洗衣機提供的資料。  
請妥善保存本操作指南，以備日後供其他使用者參考。



### 本產品設計只適用於家居或下列之類似環境：

- 一般商店、辦公室及其他工作環境的職員專用廚房；
- 農莊；
- 供入住酒店、汽車旅館及其他住宅式旅店之顧客使用；
- 提供簡單住宿及早餐服務之旅舍。

即使在上述環境下，本產品亦只適合作家居或一般酒店房間管理的操作目的(包括由專家或有經驗用家作商業用途)，而不適合作任何其他用途。

假如本產品在不符合以上描述的條件下進行操作，產品的壽命有可能因而縮短，同時產品之保養服務將會失效。

任何因為不符合家居操作用途(即使本產品被安置於家居環境中)，導致產品本身損壞或造成其他傷害或毀壞，本製造商將根據法律授予的一切權利，不承擔任何相關責任。

### 棄置本產品應注意事項

本產品所有包裝物料均使用環保及可循環再用物料所製。請以符合環保的方式棄置包裝物料。

**您的產品供應商或當地相關議會組織應可為您提供有關現行棄置方法的詳情。**

透過廢物循環再造的步驟，便可從舊機中回收有價值的物料。

**注意：**  
**棄置舊機前，請先將電源插頭拔除，並剪斷電線。請將電源插頭與舊機一併棄置。**

當棄置舊洗衣機時，請將洗衣機門鎖弄壞，並確保不能上鎖，以避免小童意外被關在產品之內。

# 目錄

# 頁數

概述	2
有關運送的一般注意事項	4
安全事項	4
<b>快速啟動操作</b>	5
控制說明	6
程序表	14
程序選擇鈕	16
洗衣劑格	19
洗衣劑、助洗劑及使用份量	20
有用建議	22
主洗	23
乾衣	25
自動洗衣/乾衣操作	26
乾衣操作	27
清潔及日常保養	29
故障診斷	30
技術規格	32
設定及安裝	33

開動本產品前，請確保產品經已正確安裝，並檢查清楚所有搬運安全螺絲已按第33頁的指示拆除。

## 有關運送的一般注意事項

當貨品運抵時，請檢查清楚以下物品經已隨產品一併附上：

- 操作指南
- 保用證書
- 螺孔保護塞
- 進水管
- 液體洗衣劑或漂白劑格

同時檢查產品於運送途中是否受損，如發現損毀，請聯絡最近的授權技術支援服務代理。

## 安全事項

### 注意：有關洗衣機的清潔或保養程序

- 1) 拔除電線插頭
- 2) 關上水龍頭
- 3) **惠而浦**所有產品的電線均配有地線的插頭。請確保電源供應配備地線設計，假如沒有，請向合資格專業人士求助。
- 4) 切勿以沾濕的手腳接觸本產品。赤足時切勿操作產品。
- 5) 不建議使用萬能插蘇、轉換插座及/或拖板。

### 注意： 洗衣程序操作時，水溫可高達攝氏+°度

- 6) 打開機門前，檢查清楚洗衣桶內沒有積水。
- 7) 除非有負責人身安全的人士提供適當監督及指示，否則本產品的設計並非為患有身體、知覺、心理功能障礙、或缺乏有關操作經驗及知識的人士(包括兒童)使用。請看管兒童，切勿讓兒童玩弄洗衣機。
- 8) 拔除插頭時，切勿拉扯電線：應緊握電線插頭本身。
- 9) 切勿將本產品放置於露天環境下(包括會被雨淋、太陽直射等地方)。
- 10) 如搬運本產品時，切勿把持控制面板上的按鈕或洗衣劑格。在運送過程中，切勿讓機門壓向小車，同時切勿在沒有安裝機座軟墊的情況下搬運產品。

### 11) 重要事項！

假如要將產品安放在地毯上，必須確保機底排氣孔不被阻塞。

12) 遇有產品操作不正常或出現毀壞，請馬上關機、關上水龍頭，並不要操作洗衣機。請向授權技術支援服務代理查詢有關維修安排，並要求代理使用原廠零件。假如沒有依照上述說明操作洗衣機，將有機會危及產品的安全。

13) 假如產品的電源線需要更換，請向授權技術支援服務代理查詢。

## 快速啟動操作

### 洗衣

- 用門把手“A”打開機門(請參閱第6頁，圖1)
- 選擇衣物並放入洗衣機
- 關上機門
- 按照本操作指南之程序指引將洗衣劑注入洗衣劑格
- 選擇程序
- 顯示屏上將顯示出所選程序之設定
- 如有需要可調校洗衣水溫

### 乾衣

假如需要在洗衣程序結束後自動開始乾衣程序，請以乾衣選擇按鈕選取所需之程序。

亦可選擇在洗衣程序結束後，自行選擇乾衣程序並放入衣物。

### 按輔助功能按鈕(如有需要)

- 按「啟動/暫停」鍵(請參閱第7頁)
- 程序開始

### 完成洗衣後

- 顯示屏上將顯示「END (結束)」字樣。
- 等候片刻待門鎖可供開啟 (程序完成後約2分鐘)  
「機門上鎖」指示燈會關掉。
- 將程序選擇鈕轉到「關機」位置以關掉洗衣機。
- 打開機門，拿出衣物。

請參閱第33頁的指示正確安裝洗衣機。

# 控制說明

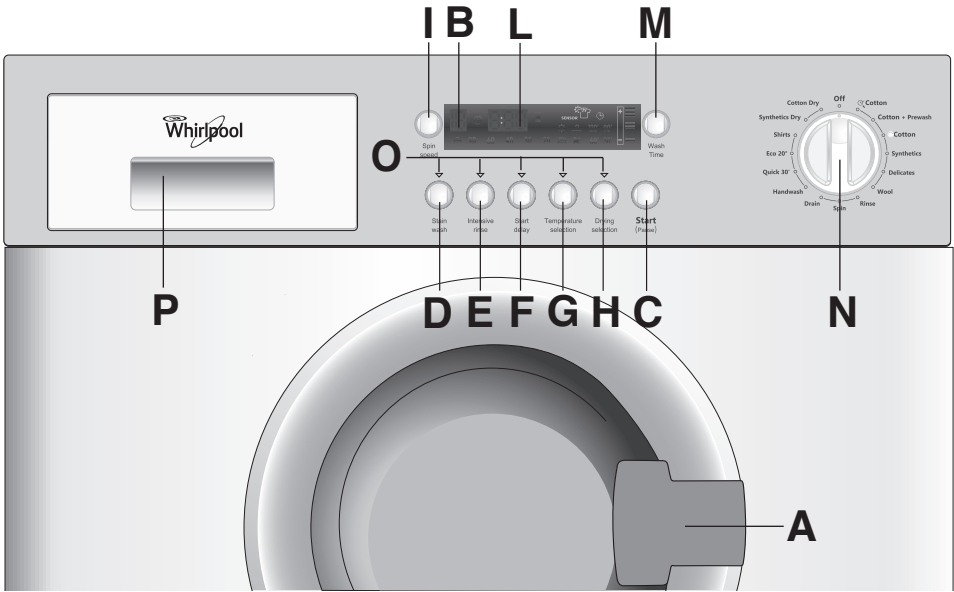

門把手

「機門上鎖」指示燈

「啟動/暫停」鍵

「除污洗衣」鍵

「深層過水」鍵

「預校開機時間」鍵

「水溫選擇」鍵

「乾衣選擇」鍵

「脫水轉速」鍵

數位顯示屏

「洗衣時間」鍵

程序選擇鈕附「關機」位置

按鍵指示燈

洗衣劑格

A

B

C

D

E

F

G

H

I

L

M

N

O

P

## 門把手

以指頭按壓門把手內側的推桿打開洗衣機門。

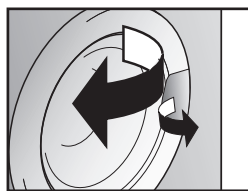

**A**

## 「機門上鎖」指示燈

**B**

當機門妥善關上，同時洗衣機正在操作時，「機門上鎖」指示燈將會亮著。假如在機門打開的情況下按「啟動/暫停」鍵，指示燈會瞬間閃爍，然後熄滅。

如機門沒有關妥，指示燈將不停閃爍。

本產品備有獨特的安全設計，防止機門在操作結束後即時打開。請待洗衣程序完成後約2分鐘，同時「機門上鎖」指示燈熄滅後，方行打開機門。在程序結束後，請將程序選擇鈕轉到「關機」位置。

## 「啟動/暫停」鍵

**C**

按鍵啟動所選操作程序。

**注意：**  
當按下「啟動/暫停」鍵，產品會在數秒後才開始操作。

### 在程序開始後(暫停)更改設定

持續按下「啟動/暫停」鍵約2秒，選項鍵指示燈和操作剩餘時間指示燈會同時閃爍，表示洗衣機已暫停操作。按所需更改設定，再按「啟動/暫停」讓指示燈停止閃爍。

假如需要在洗衣操作過程中加入或取走衣物，請等候約2分鐘待安全設計為機門解鎖。

當閣下完成所需動作後，請關上機門，按「啟動/暫停」，產品將接續未完成的操作。

### 取消程序

如需取消程序，請將選擇鈕轉到「關機」位置。

重新選擇其他程序。

將程序選擇重設於「關機」位置。

請在按下「啟動!暫停」鍵前選擇所需之輔助功能鍵。

## 「除污洗衣」鍵

D

只需按下僅限在棉質程序下可供選用的「除污洗衣」鍵，本產品具備的感應器設計將發揮功效。感應器能夠在洗衣操作過程中，同時調整水溫和維持於理想水平，並管理洗衣桶的機械操作。

洗衣桶於特定的時刻會以兩種不同的速度旋轉。在洗衣劑進入衣物的一刻，洗衣桶的旋轉速度將有助洗衣劑平均分佈於衣物上；當進入洗衣及過水程序，洗衣桶的轉速將會加快以提升清潔的效能。全賴這套全新系統，洗衣過程的效率得以提升，**同時不會增加程序操作所需時間。**

## 「深層過水」鍵

E

只需按下本功能鍵，全新的感應系統設計將為閣下啟動一套全新的洗衣操作程序。而本功能僅限在棉質和混合衣物程序下可供選用。本輔助功能充份照顧衣物中的微細纖維，並呵護皮膚。

當選用本功能，清洗衣物所需的耗水量將會增加，再結合洗衣桶在注水和排水時採用全新的複合式轉速設計，確保令閣下的衣物徹底清洗和過水。為了清除殘留在衣物纖維中的洗衣劑，當選用本功能後，過水時耗用的水量將會增加。本功能是特別為幼嫩及敏感皮膚人士而設，以免受到即使是極微量的洗衣劑殘留物刺激，引致出現各種痕癢或敏感徵狀。

我們亦建議閣下利用本功能，清洗小孩衣服及其他維幼細的衣物，以及毛巾或類似衣物，原因是上述衣物的纖維較易吸收大量洗衣劑。為確保閣下操作洗衣機時獲得最佳效果，在選擇纖幼、羊毛及手洗衣物時，本功能將自行啟動。

## 「預校開機時間」鍵

F

利用本功能鍵，閣下可預先設定洗衣程序並讓洗衣操作延遲最多至24小時後才開始。要延遲啟動洗衣程序，請按以下步驟：  
設定所需程序。

按鍵一次啟動本功能(顯示屏上將出現“h00”字樣)，再按鍵一次將延遲啟動時間設定為一小時之後(顯示屏上將出現“h01”字樣)；每按鍵一次，預設延遲啟動時間將增加一小時。直至顯示屏上出現“h24”字樣，此時再按鍵一次將令延遲啟動時間重設為零。

按「啟動!暫停」鍵確認設定(顯示屏上的燈號會開始閃爍)。倒數計時隨即開始，當完成計時，預選的程序將會自動啟動。

如需取消延遲啟動功能，請按以下步驟：

持續按鍵5秒，直至顯示屏上顯示已選程序的各項設定。

這時候，可按「啟動/暫停」鍵直接啟動已選程序，或可將選擇鈕轉到「關機」位置取消已選程序，然後重新選擇程序。

### **警告：**

在洗衣機操作過程中，假如電源突然中斷，洗衣機的一組記憶系統會記下已選程序的設定，並在恢復電源時，接續未完成的操作。

---

## **「水溫選擇」鍵**

# **G**

每當選定一項程序之後，相關的指示燈將會亮起，以表示建議的洗衣溫度。

「水溫選擇」鍵作用是提高或降低閣下已選洗衣程序的水溫。

每按鍵一次，洗衣溫度指示屏將顯示新的溫度水平。

如需以冷水洗衣，必須讓所有指示燈關上。

---

## **「乾衣選擇」鍵**

# **H**

當程序選擇鈕並非處於「關機」位置，便可按本功能鍵選擇所需之乾衣程序；每按鍵一次，一組指示燈將亮起以表示已選的乾衣效果。

如需在乾衣程序啟動前取消選項，請重複按鍵直至指示燈熄滅，或可將選擇鈕轉到「關機」位置。

如需在乾衣程序進行期間取消操作，持續按下本鍵2秒，直至散熱指示燈亮起；由於洗衣桶在操作期間溫度相當高，我們建議閣下先讓乾衣機完成整個散熱過程後，才將程序選擇鈕轉回「關機」位置，同時取出衣物。

## 「脫水轉速」鍵

脫水操作的作用是盡可能將衣物中的水份弄走，同時不破壞衣物纖維。閣下可根據需要自行調校洗衣機的脫水轉速。

閣下除可按本鍵調減最高的脫水轉速，更可取消整個脫水操作。如需重新啟用脫水操作，請按鍵直至閣下所需要設定的轉速出現。而為保護衣物本身，系統不容許讓轉速設定超過在已選程序下自動設定的數值。調校脫水轉速，毋須暫停洗衣機操作。

### 注意：

本洗衣機設有一組獨特的電子系統，當洗衣桶內的衣物分佈不平均時，可防止脫水操作進行。這設計可減低洗衣機操作的噪音和震動，同時有助延長閣下洗衣機的壽命。

## 「數位」顯示屏

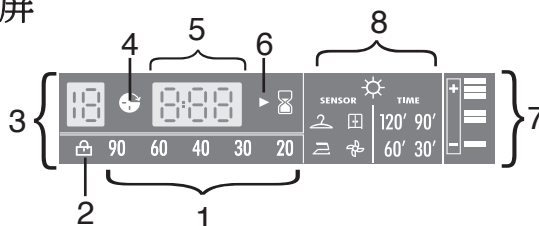

本顯示屏的指示設計可讓閣下持續讀取有關洗衣機操作情況的資訊：

### 1) 洗衣溫度

選定程序後，相關的指示燈將亮起並顯示建議的洗衣溫度。「水溫選擇」鍵作用是提高或降低閣下已選洗衣程序的水溫。每按鍵一次，洗衣溫度指示屏將顯示新的溫度水平。如需以冷水洗衣，必須讓所有指示屏關上。

### 2) 門燈

當按下「啟動/暫停」鍵後，此燈將首先閃爍，隨後停下並維持亮著，直至洗衣程序結束為止。待洗衣程序結束後2分鐘，燈號將熄滅，顯示機門可以打開。

### 3) 脫水轉速

當選定程序後，顯示屏上將顯示在已選程序下，系統可容許的最高轉速。每按脫水轉速鍵一次，轉速將減少每分鐘100轉。系統最低轉速設定為每分鐘400轉，閣下亦可重複按鍵直至取消脫水操作。

### 4) 預校開機時間燈

當設定「預校開機時間」功能後，此燈將閃爍。

### 5) 操作時限

當選定程序後，顯示屏上自動顯示程序操作時限，有關時限會因為選用輔助選項而有所不同。當程序啟動後，閣下可持續讀取距離洗衣操作結束的剩餘時間。假如已選擇自動洗衣/乾衣程序，當完成洗衣程序後，顯示屏上將顯示距離乾衣操作結束的剩餘時間。

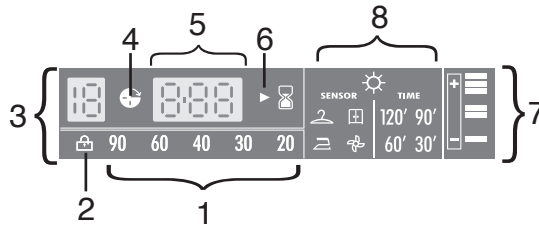

## 6) 啟動程序燈

當按下啟動鍵，此燈將亮起。

## 7) 洗衣時間

當選定程序後，本指示器屏自動顯示已選程序所需的洗衣時間。如選擇不同的洗衣時間，相關指示燈將亮起。

## 8) 乾衣程序指示燈

不同的指示燈代表不同的乾衣程序選擇：

本洗衣乾衣機內置自動感應乾衣功能，令計算乾衣所需時間更加準確。閣下只需選擇所需的衣物烘乾程度，當系統感應到衣物已達預設的烘乾程度，乾衣機即自行關掉。為方便使用，系統更提供三種預設的感應乾衣程度選擇：

 = 額外乾衣程序

 = 一般乾衣程序

 = 熨燙乾衣程序

### 實用提示：

當選定程序後，按下啟動/暫停鍵。洗衣機將按滿載衣物量的情況，計算出距離已選程序結的剩餘時間。而在操作進行期間，洗衣機將按實際載入的衣物量和衣物濡濕程度，重新計算並更正實際所需時間。

### 限時程序：

閣下亦可為乾衣程序自行預設操作時間。限時乾衣程序可供設定的時間如下：  
120分鐘 — 90分鐘 — 60分鐘 — 30分鐘

### 散熱程序：

每次乾衣操作結束後，系統將進行為時10分鐘的散熱程序，目的是避免乾衣操作結束後取出衣物時，衣物過熱。

## 「洗衣時間」鍵

# M

選用本鍵(僅限在棉質和混合衣物程序下可供選用)，可助閣下按衣物骯髒的程度，從3個不同級別的洗衣操作，挑選出最合適的一個。當選定程序後，已選程序預設的所需洗衣時間指示燈將會自動亮起。如選擇不同的洗衣時間，相關的指示燈將會亮起。

## 程序選擇鈕附「關機」位置

# N

當轉動程序選擇鈕時，顯示屏上將顯示出現已選程序的相關設定資料。

注意：如需關掉洗衣機，請將選擇鈕轉到「關機」位置。

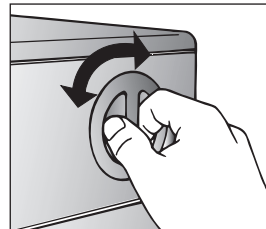

現時，大多數洗衣劑的成份經已改良，即使在低溫環境下仍可發揮理想的洗衣效果。因此，我們將所有程序的預設洗衣溫度均調低，目的是節省能源，同時減少閣下洗衣機的碳足跡。

閣下可利用洗衣溫度鍵自行調高洗衣溫度。

有關個別程序的洗衣溫度上限設定，請參照程序指南。

按「啟動/暫停」鍵啟動已選程序。

當選定程序後，程序選擇鈕將維持於已選程式的位置，直至操作結束。

請將選擇鈕轉到「關機」位置，以關掉洗衣機。

注意：

當每次洗衣機操作結束後，或當要進行下一次洗衣操作，在選擇並啟動任何程序之前，必須先將程序選擇鈕轉回「關機」位置。

## 按鍵指示燈

# O

指示燈在按下相關功能鍵時將會亮起。

假如個別功能選項不適用於已選程序，其按鍵指示燈將首先閃爍，隨後熄滅。



## 程序表

程序適用衣物種類	程序選擇鈕 標示	建議 衣量 (公斤)	建議溫度 (攝氏)	最高溫度 (攝氏)	大概時間 (小時/分鐘) <sup>2)</sup>	CHARGE DETERGENT		
							⊗	
<b>耐洗衣物</b> 棉質、亞麻織物	1) *  <b>Cotton</b>	7	60°	最高 90°	3:00	●	●	
棉質、混合耐洗、顏色衣物	1) * <b>Cotton + Prewash</b>	7	40°	最高 60°	3:20	●	●	●
<b>耐洗衣物</b> 棉質	1) * <b>eCotton**</b>	7	40°	最高 60°	4:00	●	●	
<b>混合衣物及合成纖維</b> 棉質、混合衣物、合成纖維	<b>Synthetics</b> *	3.5	40°	最高 60°	2:00	●	●	
<b>極纖細衣物</b>	<b>Delicates</b>	2.5	40°	最高 40°	1:05	●	●	
「可機洗」羊毛	<b>Wool</b>	2	40°	最高 40°	1:00	●	●	
過水	* <b>Rinse</b>	-	-	-	0:25	△	●	
快速脫水	* <b>Spin</b>	-	-	-	0:10			
排水	<b>Drain</b>	-	-	-	0:04			
手洗	<b>Handwash</b>	1.5	30°	最高 30°	1:00	●	●	
<b>耐洗衣物</b> 混合衣物及合成纖維 30分鐘速洗	* <b>Quick 30'</b>	2.5	30°	最高 30°	0:30	●	●	
<b>耐洗衣物</b> 混合衣物及合成纖維	* <b>Eco 20°</b>	7	20°	最高 20°	1:50	●	●	
棉質 – 混合	* <b>Shirts</b>	3.5	30°	最高 30°	2:00	●	●	
合成纖維 – 乾衣	<b>Synthetics Dry</b>	3.5	-	-	2:20			
棉質 – 乾衣	<b>Cotton Dry</b>	5	-	-	3:10			

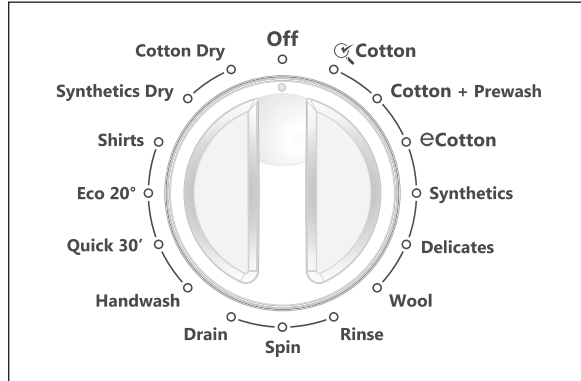
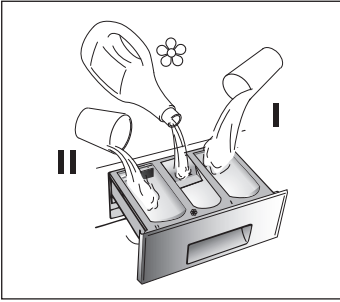

## 請閱讀下列注意事項

### 實驗室參考資料

(參考EN 50229 標準)

#### 洗衣

選擇程序\*\* 時，按骯髒程度最高的衣物、最大脫水轉速及攝氏60度洗衣溫度為準。  
建議程序同時適用於以較低溫度進行測試。

#### 乾衣

首次乾衣操作載入5公斤衣物(衣物包括：枕袋及抹手巾)，並選用棉質乾衣程序(**Cotton Dry**)  
下之一般乾衣程序(☐)。

第二次乾衣操作載入2公斤衣物(衣物包括：床單2張及抹手巾)，並選用棉質乾衣程序  
(**Cotton Dry**)下之一般乾衣程序(☐)。

脫水轉速可因應衣物標籤上的建議而減少，或當清洗極纖細衣物時，可完全取消脫水操作。請使用脫水轉速鍵選取有關功能。

■ 按洗衣溫度鍵可自行設定洗衣溫度，惟自行設定之溫度不可超出最高溫度限制。

\* 可與自動乾衣操作併用的程序。

1) 可與自動乾衣操作併用的程序。

△ 假如只有少量衣物需特別以漂白劑清除表面污漬，可以利用洗衣機的特設功能，為部份需要特別處理的衣物進行預先清除污漬的程序。  
先將漂白劑注入特設的漂白劑容器，然後將容器放入洗衣劑格內標示為“II”的儲存格，然後選用特設的「過水」程序。

當操作完成後，先關掉洗衣機，再放入其餘衣物，然後選用合適的程序如常進行操作。

2) 洗衣時間會受衣物載入量、衣物種類、水壓和溫度等這些因素影響。

## 程序選擇鈕

本洗衣機因應衣物的類型和骯髒程度，已根據洗衣過程、溫度和過程操作所需時間，預設不同類型的洗衣程序(請參閱洗衣程序表)。

### 棉質

棉質程序能提供最高的洗衣及過水效能。程序中包含多次脫水操作，可確保衣物徹底過水。最後一次脫水操作轉速可達脫水轉速上限，目的是令衣物獲得最佳的脫水效果。

棉質程序包括一次預洗步驟。這一選項是針對非常骯髒的衣物，而且可與主洗程序獨立操作。如選用預洗功能，請將額外份量的洗衣劑注入洗衣劑格內以“P”字標示的儲存格(請參閱本指南中題為「洗衣劑」的章節)。我們建議預洗操作的洗衣劑用量為主洗程序所需之20%。

 Cotton

Cotton +  
Prewash

eCotton

### 混合及合成纖維衣物

洗衣桶的旋轉規律和注水量經過精心計算和安排，令主洗及過水操作發揮出最佳的洗衣效果。

溫和的脫水轉速可減少衣物起皺。

Synthetics

### 特別纖細衣物

此一全新洗衣操作採用洗衣、浸泡相間步驟，建議用作處理十分纖細的衣物。

洗衣及過水會配合較高注水量進行操作，以確保達至最佳的效果。

Delicates

### 羊毛程序

這項獨特的洗衣操作，既可徹底清洗衣物，又不破壞衣物的纖維。整個操作過程中夾雜停頓的空檔。程序採用的最高洗衣溫度為攝氏40度，過程最後包括3次過水及一次短脫水步驟。

Wool

### 特別「過水」程序

本程序包括三次過水操作及一次中途脫水操作(操作時間可透過適當按鍵步驟自行縮短甚至取消)。本程序適用於處理任何類型的衣物，例如用於手洗衣物之後。

此程序亦可用作漂白處理步驟(請參閱洗衣程序表)。

Rinse

### 特別「脫水」程序

本「脫水」程序會以最高轉速操作(亦可透過適當按鍵步驟自行調減)。

**Spin**

### 排水

本程序僅將水排出洗衣機。

**Drain**

### 特別「手洗」

本洗衣機另具備柔和的手洗操作程序。本程序的操作是專為標明「只可以手洗」的衣物而設。程序採用的洗衣溫度為攝氏30度，過程最後包括3次過水及一次短脫水步驟。

**Handwash**

### 30分鐘速洗

本30分鐘速洗程序的整個操作時間約為30分鐘，衣物載入量最多為2.5公斤，洗衣溫度為攝氏30度。

**Quick 30'**

請注意，如選用速洗程序，我們建議閣下採用的洗衣劑量應為洗衣劑產品包裝上建議份量的20%。

### 慳電洗20°

這項創新的程序可讓閣下將多種不同類型和顏色的衣物，例如棉質、合成纖維和混合衣物，以攝氏20度一同清洗，而且效果出眾。

**Eco 20°**

使用本程序的耗電量，僅為一般以攝氏40度使用棉質程序所需的40%。

### 「襯衣」程序

本程序適用於清洗襯衣。

**Shirts**

洗衣桶的旋轉規律和注水量經過精心計算和安排，令主洗及過水操作發揮出最佳的洗衣效果。

程序採用的最高洗衣溫度為攝氏30度，過程最後包括3次過水及一次短脫水步驟。

## 乾衣

注意：假如使用儲放濃縮洗衣粉或洗衣液的洗衣球，在啟動烘乾程序之前，請先將洗衣球從洗衣桶取出。

在乾衣操作過程中，洗衣桶會改變旋轉方向，目的是避免衣物纏結在一起，從而帶來平均的乾衣效果。而在整個乾衣程序最後10分鐘，洗衣機會利用涼風以令衣物減少起皺。

## 低溫乾衣

低溫乾衣程序適用於合成纖維及混合衣物，有關衣料成份請參閱衣物上之標籤。

**Synthetics  
Dry**

## 高溫乾衣

高溫乾衣程序適用於棉質及尼龍衣物，有關衣料成份請參閱衣物上之標籤。

**Cotton Dry**

## 洗衣劑格

P

洗衣劑格分成三個儲存格：

- 以“Ⅰ”字標示的儲存格用作存放預洗程序用洗衣劑；
- 以“⊗”圖形標示的儲存格用作存放專用添加劑、衣物柔順劑、芳香劑、衣漿粉、亮白劑等；
- 以“Ⅱ”字標示的儲存格用作存放主洗程序用洗衣劑。

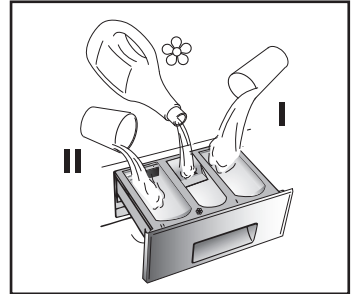

如使用洗衣液，請將隨機附上的特製容器放入洗衣劑格中標示為“Ⅱ”的儲存格內。該容器可確保洗衣液在洗衣過程中適當的時間，讓洗衣液進入洗衣桶。

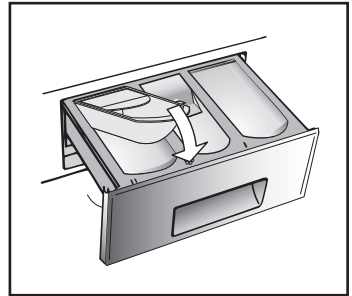

該特製容器必須安裝到洗衣劑格中標示為“Ⅱ”的儲存格內。假如閣下利用「過水」程序進行漂白操作，也需要用上該特製容器。

**注意：**

個別洗衣劑使用較困難。如洗衣劑生產商建議注入洗衣球使用，請遵照有關建議。

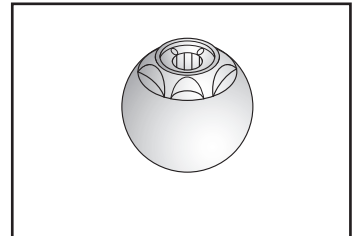

**注意：**

只可將液體用品注入以“⊗”圖形標示的儲存格。本洗衣機已預設程序，不論在選用任何洗衣操作程序的情況下，均於最後一次過水步驟時自動取用添加劑。

# 洗衣劑、助洗劑及使用份量

## 洗衣劑選擇

### 一般用途洗衣劑

- **洗衣粉**，具備徹底清潔及漂白功效，特別適用於高溫洗衣程序(攝氏60度或以上)，能有效處理非常骯髒的衣物。
- **洗衣液**，適用於處理含油脂的污漬，例如皮膚油脂污漬、化妝品及油份。  
這類洗衣劑不適宜用於清洗染有污漬的衣物，因為洗衣液不含有漂白劑成份。
- **生物性洗衣劑**，有部份無法提供真正徹底的清潔功效。

## 洗衣添加劑

- **軟水劑**在水的硬度被界定為硬至極硬時，可發揮減少使用洗衣劑的功效。
- **預洗用品**適合在主洗程序前，配合針對污漬的處理程序一起使用。  
使用預洗用品令後續的洗衣程度能以低溫或配合不含漂白成份的洗衣劑進行。
- **衣物柔順劑**可幫助減少合成纖維衣物中形成靜電，同時令衣物變得柔順。  
如閣下採用烘焙式乾衣機，即使不使用衣物柔順劑，衣服亦同樣柔軟。

### 請勿將含溶劑成份物品放入洗衣機！

請將洗衣劑及其他洗衣添加劑儲放於小童不可觸及之處。

當準備注入洗衣劑前，請檢查清楚洗衣劑當中不含任何外來物。洗衣劑用量一般顯示在洗衣劑包裝之上。使用時請參照有關指示。

## 洗衣劑量

僅使用適合洗衣機用之洗衣劑。

儘可能減少用化學用品，以獲取最佳的洗衣效果。若按衣物骯髒程度及洗衣劑種類作考慮，愈少使用化學用品可令衣物獲得最好的呵護。

洗衣劑量取決於：

- 水的硬度：視乎水的硬度和洗衣劑的種類，某些情況下可減少洗衣劑用量。
- 骯髒程度：可按衣物的骯髒程度減少洗衣劑用量。
- 洗衣量：假如只清洗少量衣物，可減少洗衣劑用量。

## 洗衣粉用量

**一般及低濃縮洗衣粉**：如清洗一般骯髒衣物，請選擇不設預洗的程序。

將洗衣粉倒入以“**II**”字標示的儲存格。

假如清洗非常骯髒衣物，請選擇附設預洗的程序。

將1/4的洗衣粉倒入以“**I**”，字標示的儲存格，再將餘下3/4的洗衣粉倒入以“**II**”字標示的儲存格。

使用衣物柔順劑時，請先放入洗衣粉，然後再放入柔順劑至以“**II**”字標示的儲存格。

假如使用超濃縮洗衣粉份量不足一份，請按產品包裝指示上所示的衣服類型和份量使用。取出洗衣粉時，為免卻量度適當份量的麻煩，可用隨產品提供的專用量杯。

## 洗衣液用量

洗衣液的用量可參照相關產品的包裝上指示。所有不包括預洗操作的程序，可使用能放於滾桶內而特別設計的儲存器(需外購)或某些附有該儲存器的洗衣機型號，來注入洗衣液。

## 不同洗衣溫度下使用洗衣劑的建議

當清洗非常骯髒的白色衣物時，我們建議使用攝氏60度或以上的棉質洗衣程序，配合能在中溫/高溫使用並含有漂白成份的普通洗衣粉，能令洗衣效果更佳。在攝氏40度至60度的洗衣溫度下，選擇洗衣劑時需因應該種衣物物料和衣物骯髒程度，普通洗衣粉適用於清洗較骯髒的白色衣物和不易染色的衣物，而洗衣液或護色洗衣粉適用於清洗一般骯髒而易染色的衣物。在攝氏40度以下的洗衣溫度下，我們建議使用專為較低洗衣溫度而設的洗衣液或洗衣劑。當清洗羊毛或絲質物料時，需使用適合清洗該物料的洗衣劑。洗衣劑的份量請參考洗衣劑包裝上的指示標籤。

## 給使用者的有用建議

以下建議可助閣下在使用家庭電器時，獲得最具環保效益和經濟成效。

### 每次以全機洗衣量進行洗衣操作

為了盡可能減省耗電、耗水和洗衣劑用量，我們建議閣下洗衣時應放入全機洗衣量，但不要超出建議的洗衣量上限。以全機洗衣量進行一次洗衣操作，比較以一半洗衣量的分兩次進行洗衣操作，可節省高達50%耗電量。

### 什麼情況下才真正需要進行預洗？

僅當衣物非常骯髒時！

按一般骯髒的衣物為例，不使用預洗操作較使用此選項，可節省5至15%耗電量。

### 應如何選擇合適的洗衣溫度？

在進行機洗衣前先用除污劑處理衣物，可減少以攝氏60度洗衣的需要。

使用攝氏60度洗衣比較攝氏90度洗衣，可節省多達50%耗電量。

### 使用乾衣程序之前

在使用乾衣操作前，利用高速脫水操作減少衣物的水份，既省電也省時間。

# 主洗

## 將衣物分類

- 建議閣下只清洗可配合水和洗衣劑進行的可供機洗衣物，當中不包括只適宜乾洗的物品。
- 假如閣下需要清洗地毯、床單或其他重物，盡可能避免進行脫水操作。
- 請按照衣物的類別、骯髒程度及適用洗衣溫度分類。任何時候，應遵照衣物標籤上的建議處理衣物，以確保衣物得到最適當的呵護及保障。

可以高溫清洗衣物 

顏色、容易處理衣物   

纖細及羊毛  

手洗 

標籤上如有以下圖案的衣物則不適宜機洗：

乾洗 

假如清洗極纖細物品如窗簾、內衣、內褲等，建議使用洗衣網或洗衣袋。

- 羊毛物品必須標明為「全羊毛」，同時標明「防皺褶」或「可機洗」。
- 新買顏色物品常會出現脫色情況。

這樣會導致其他一同清洗的淺色物品被染色。

因此我們建議首次清洗顏色物品時，應與其他物品分開處理。

往後清洗時，不脫色物品如跟白色物品一同清洗，洗衣溫度不可高於攝氏40度。

## 注意：當進行衣物分類時

- 請確保衣物沒有藏有金屬物件(例如萬字夾、扣針、胸針、硬幣等)；
- 如有枕袋，請將枕袋的鈕扣扣好；其他拉鍊、鎖扣、魚眼鈕扣、皮帶扣及長袍衣物的索帶，亦請加以適當整理；
- 移除窗簾上的掛鉤
- 請仔細閱讀衣物上的洗滌標籤；
- 假如為衣物分類時，發現部份衣物上有頑固污漬，請取出衣物，並安排以特效洗衣劑或除污劑清洗。

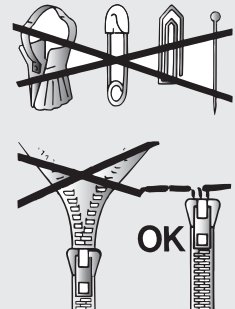

- 我們建議閣下如清洗毛巾類型衣物時，不要放入最大洗衣量，因為這類衣物吸水性較強，在洗衣過程中重量會明顯增加。

## 正確洗衣操作

### 為衣物作準備

1) 將衣物分類。

### 將衣物放入洗衣機

2) 打開洗衣機門。

3) 將衣物放入洗衣機。

關上機門，同時檢查沒有衣物阻礙機門關閉並上鎖。

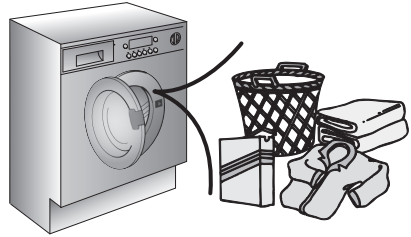

### 將洗衣劑注入洗衣機

4) 拉出洗衣劑格，選定洗衣劑並按產品生產商指示及本操作指南第20頁的建議，注入適當份量。

注入其他洗衣添加劑(請參閱第20頁)。關上洗衣劑格。

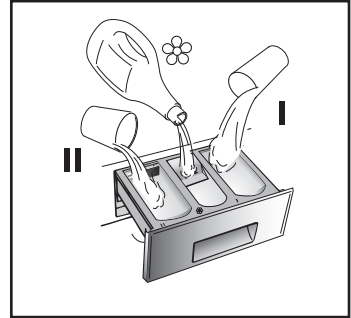

## 選擇洗衣程序

請參閱程序表或洗衣機上的程序描述，以選擇最合適的程序。

轉動程序選擇鈕至所需程序，讓洗衣機進入備用狀態。

如有需要可調校洗衣溫水。

按下輔助功能鍵(如有需要)。

檢查水龍頭經已打開，並確保排水管安放位置妥當。

按「啟動/暫停」鍵。

當按下「啟動/暫停」鍵後，洗衣機將按所選程序完成各步驟操作。

洗衣機操作期間，程序選擇鈕將一直停留在已選程序的位置上，直至程序操作完成。

**警告：**在洗衣機操作過程中，假如電源突然中斷，洗衣機的一組記憶系統會記下已選程序的設定，並在恢復電源時，接續未完成的操作。

## 當程序操作完成

顯示屏上將顯示「END(結束)」字樣。

等候片刻待門鎖可供開啟(程序完成後約2分鐘)。

「機門上鎖」指示燈將會熄滅。

將程序選擇鈕轉到「關機」位置以關掉洗衣機。打開機門，取出衣物，並關上水龍頭。

## 乾衣

請勿為塑膠製或易燃衣物進行乾衣。

### 重要事項：

本乾衣功能只適用於已清洗及經排走水份之衣物。

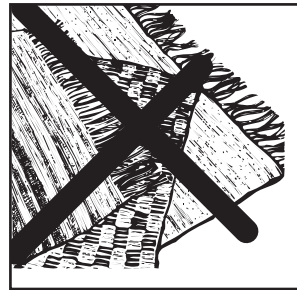

### 警告：

衣物標籤上指示的乾衣時間可視作一般情況下適用，為了獲取最佳的乾衣效果，我們建議在首次時間，可設定較標籤指示為低的乾衣時間，目的是幫助掌握所需程度的乾衣效果。我們建議不要為易破損的衣物進行乾衣。一些長毛絨織物，由於在處理過程中容易造成氣管阻塞，也應避免作乾衣操作。

用作乾衣的水會經由密封的排水管道排走，因此操作時洗衣機不會冒出蒸汽。

### 重要事項：

切勿在乾衣操作開始後打開機門；請等待程序中的散熱步驟結束後，方行打開機門。

只為已經排走水份之衣物進行乾衣。

本洗衣/乾衣機具備兩種乾衣功能：

1 棉質、毛巾類衣物、亞麻織物、大麻布等...程序選擇鈕上以 **Cotton Dry** 作標示。

### 建議事項

在乾衣操作期間，洗衣桶速轉將高於正常，目的是讓衣物平均分佈，以提升乾衣功效。

2 混合衣物(合成纖維/棉質)、合成纖維衣物，程序選擇鈕上以 **Synthetics Dry** 作標示。

# 自動洗衣/乾衣操作

**警告：最多可放入5公斤乾衣物，否則可能影響乾衣效果。**

## 洗衣：

拉出洗衣劑格，選定洗衣劑並注入適當份量。

根據所需清洗之衣物類型(例如非常骯髒棉質衣物)，先參考洗衣程序表選擇程序，但不要觸按啟動鍵，按下列步驟為洗衣作準備：

轉動程序選擇鈕至所需程序，讓洗衣機進入備用狀態。

顯示屏上將顯示已選程序的設定。



如有需要可調校洗衣溫度。

按附加功能鍵(如有需要)。

檢查水龍頭經已打開，並確保排水管安放位置妥當。

## 乾衣：

選擇所需之乾衣程度。

乾衣程度選擇包括適用於毛巾及浴袍之額外乾衣(  )、乾衣後可免於熨燙衣物適用之一般乾衣(  )，以及乾衣後適宜熨燙的衣物適用之熨燙乾衣(  )。

假如閣下希望為乾衣操作設定時限，請按「乾衣選擇」鍵直至所需時間之指示燈號亮起。

按「**啟動/暫停**」鍵。

當按下「**啟動/暫停**」鍵後，洗衣機將按所選程序完成各步驟操作。

洗衣機操作期間，程序選擇鈕將一直停留在已選程序的位置上，直至程序操作完成。

當完成洗衣操作後，顯示屏上將顯示乾衣操作所剩餘時間。

洗衣乾衣機將繼續完成整個乾衣程序。

乾衣操作期間，乾衣程序指示燈將保持亮著，直至進入散熱步驟，以“”作標示的指示燈將亮起。

## 當程序結束

顯示屏上將顯示「END(結束)」字樣。

等候片刻待門鎖可供開啟(程序完成後約2分鐘)。

「機門上鎖」指示燈將會熄滅。



將程序選擇鈕轉到「關機」位置以關掉洗衣機。打開機門，取出衣物，並關上水龍頭。

# 乾衣操作

## 正確乾衣操作

- 打開洗衣機門。
- 放入最多重5公斤的乾衣物；假如清洗大面積物品(如床單)或吸水性較強物品(如毛巾或牛仔褲)，建議減少載入衣物量。
- 關上機門。轉動程序選擇鈕至 **Cotton Dry** 位置。

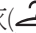
選擇所需之乾衣程度。

乾衣程度選擇包括適用於毛巾及浴袍之額外乾衣(  )、乾衣後可免於熨燙衣物適用之一般乾衣(  )，以及乾衣後適宜熨燙的衣物適用之熨燙乾衣(  )。

假如閣下希望為乾衣操作設定時限，請按「乾衣選擇」鍵直至所需時間之指示燈號亮起。

## 隔熱機門設計

由於乾衣操作會令機門玻璃溫度上升，因此機門玻璃之外特設保護層，以防止雙手觸及機門玻璃釀成危險。

在一般情況下使用，毋須將保護層從機門上移除。



## 警告：不要隨意觸摸機門。

- 請確保進水單向閥已開啟。
- 請確保排水位置妥當。

## 警告：

切勿為羊毛衣服或附軟墊的物品(例如縫製被、縫製外套等)進行乾衣。

假如屬纖細衣物，請以晾乾處理，並載較少量衣物清洗，以防起皺。

按啟動/暫停鍵。

乾衣操作期間，程序選擇鈕將一直停留在 **Cotton Dry** 程序的位置上，直至乾衣操作完成。

乾衣期間，乾衣程序指示燈將保持亮著，直至進入散熱步驟，以“”作標示的指示燈將亮起。

## 當程序結束

顯示屏上將顯示「END(結束)」字樣。

等候片刻待門鎖可供開啟(程序完成後約2分鐘)。

「機門上鎖」指示燈將會熄滅。

將程序選擇鈕轉到「關機」位置以關掉洗衣機。打開機門，取出衣物，並關上水龍頭。

## 乾衣時間表(按分鐘計)

程序	棉質		混合衣物	
	最小衣量 1公斤	最大衣量 5公斤	最小衣量 1公斤	最大衣量 3.5 公斤
額外乾衣 (Extra)	由30分鐘	至 230分鐘	由30分鐘	至 170分鐘
一般乾衣 (Cupboard)	由30分鐘	至 220分鐘	由30分鐘	至 150分鐘
熨燙乾衣 (Iron)	由30分鐘	至 170分鐘	由30分鐘	至 80分鐘

當洗衣操作剛開始時，顯示屏會顯示整個程序按全機衣量計算所需的執行時間。而操作進行期間，洗衣機會根據衣物實際多寡，以及衣服沾濕的情況，重新計算並進行更改。

### 有用建議:

請勿將未清洗的衣物放入洗衣乾衣機內。

衣物如沾上煮食油、阿司通、酒精、石油、火水、除漬劑、松節油、蠟或除蠟劑，請先以熱水並加入額外份量的洗衣劑清洗，然後才放入洗衣乾衣機進行乾衣。

請勿將下列物件放入洗衣乾衣機進行乾衣，包括發泡膠、浴帽、防水衣料、橡膠襯裡衣物，以及附軟墊之衣物及枕頭。

各種衣物柔順劑或同類用品，使用時均應遵照產品生產商的指示。

乾衣程序中最後階段的操作不會產生高熱(散熱程序)，目的是避免衣物因過熱而受到損壞。

### 警告：

切勿在乾衣程序結束前終止洗衣乾衣機之操作，如有必要，則應盡快將所有衣物從洗衣機內取出並攤開，以讓熱力釋放。

# 清潔及日常保養

切勿將含有酒精成份的沙布及/或稀釋劑用於洗衣機表面，只需以濕布加以清潔便可。洗衣機所需的日常保養項目非常有限：

- 清潔洗衣劑格
- 清潔過濾器
- 清潔機門玻璃

## 清潔洗衣劑格

儘管非必然，但應定時清潔用作存放漂白洗衣劑及添加劑之儲存格。

- 1) 先抽出儲存格，過程中可能要稍加力度，但應避免強行抽出。
- 2) 打開水龍頭，徹底清潔儲存格。
- 3) 將儲存格妥善放回原位。

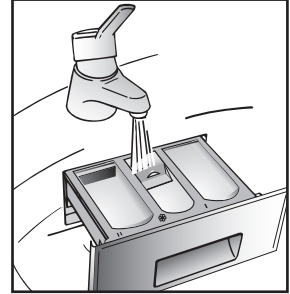

## 清潔過濾器

本洗衣機設有專用的過濾器，作用是阻隔一些體積較大、容易造成排水管淤塞之沉澱物或雜物(如硬幣、衣鈕等)，同時方便取走該些沉澱物或雜物。

我們建議過濾器應最少每一個月清潔一次。

清潔步驟如下：

- 1) 取出過濾器之前，請先將一條吸水力強的毛巾放置於過濾器下方，以便吸走可能積存在排水泵內的少量積水。
- 2) 按逆時針方向轉動過濾器直至固定於垂直位置，便可將過濾器取出並加以清潔。
- 3) 完成清潔後，將過濾器放回原位，並按順時針方向轉動直至固定，然後按相反次序完成其餘上述步驟。

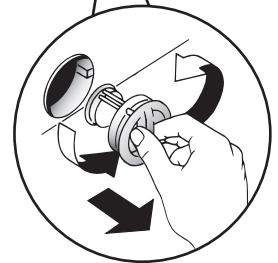

## 清潔機門玻璃

請定時用濕布清潔機門的玻璃。假如水中的沉積物和雜質積聚於玻璃表面，可能會導致機門漏水。

切勿利用含侵蝕性的清潔劑進行清潔，這樣會令玻璃出現損蝕。

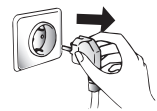

## 洗衣機如需搬遷或長期間置

假如洗衣機需要搬遷或將長期間置於溫度較低的地方，必需先將洗衣機所有喉管的積水完全排走。

確保切斷主電源，讓喉管垂下並置於盤內，直至所有水被排出。完成後，請按相反次序完成上述步驟。

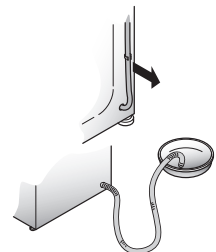

## 故障診斷

### 什麼原因導致... 各種可自行解決的事故

故障說明	可能原因	排解方法
1. 無法啟動任何程序	沒有連接上電源 沒有開啟電源 電力中斷 保險絲燒掉 洗衣機門沒有完全關上	接上電源 按下啟動/暫停鍵 檢查供電來源 檢查保險絲 關妥洗衣機門
2. 洗衣機沒有進水	參閱第一項故障 水龍頭被關上 程序選擇鈕未有轉到正確位置 進水管扭曲	進行相關檢查 打開水龍頭 將程序選擇鈕轉到所需及正確位置 保持進水管暢通
3. 洗衣機沒有排水	排水管淤塞或扭曲 家中排水通道受阻 排水泵過濾器淤塞	保持排水管暢通 清理家中排水通道 檢查排水泵過濾器
4. 洗衣機附近地板有積水	水龍頭與進水管之間密封圈出現滲漏 家中排水通道受阻 洗衣劑格被沉積物阻塞	更換密封圈，並妥善接駁水龍頭與喉管 清理家中排水通道 清潔洗衣劑格
5. 洗衣桶沒有旋轉	洗衣機內積水未排走 選擇了「停止旋轉」(只限於個別型號)	等候數分鐘待洗衣機的水排走 按重設鍵或轉動「停止旋轉」旋鈕取消
6. 洗衣桶轉動時，機身劇烈震動	洗衣機放置水平不理想 沒有拆除運送用的保護設計 洗衣桶內衣物分佈不平均	調整機腳高度 拆除運送用的保護設計 將衣物重新平均分佈於洗衣桶內
7. 無法打開機門	程序結束後兩分鐘上鎖時限未解除	等候兩分鐘待系統解除上鎖
8. 顯示屏出現0, 1, 5, 7, 8, 9 故障代號	-	請聯絡客戶服務中心
9. 顯示屏出現故障代號 2	沒有入水	檢查入水供應
10. 顯示屏出現故障代號 3	沒有泵走積水	檢查排水通道是否暢通 檢查排水喉管沒有扭曲
11. 顯示屏出現故障代號4	洗衣機內積水過量	關掉洗衣機的供水，聯絡客戶服務中心

在乾衣操作期間，洗衣桶速轉將高於正常，目的是讓衣物平均分佈，以提升乾衣功效。

當洗衣機的洗衣桶轉動時，會發出有別於正常的聲響，原因是洗衣機裝配了有刷電機，以提升操作表現。

如察覺洗衣桶內的水位水平偏低，原因是新款的洗衣機設計能以較少耗水量，達至等同以往的洗衣及過水效果。

## 注意事項：

操作洗衣機時使用不含磷酸鹽的環保洗衣劑可能會產生下列現象：

- 過水操作後排走的水呈較混濁狀態，原因是水中含有懸浮的沸石，但這現象並不會影響過水的效果；
  - 清洗後的衣物表面會出現白色粉末(沸石)，原因是沸石不會被衣物纖維吸收，但這些粉末不會影響衣物的顏色。
  - 最後一次過水操作中出現泡沫並不代表過水效果欠佳。
  - 有證據顯示，洗衣劑成份中的負離子表面活性劑難以從衣物中清除的情況經常會發生，在這種情況下，即使衣物中的負離子表面活性劑含量極少，也能造成大量泡沫。
  - 即使重複進行過水程序，亦無法杜絕上述情況出現。
-

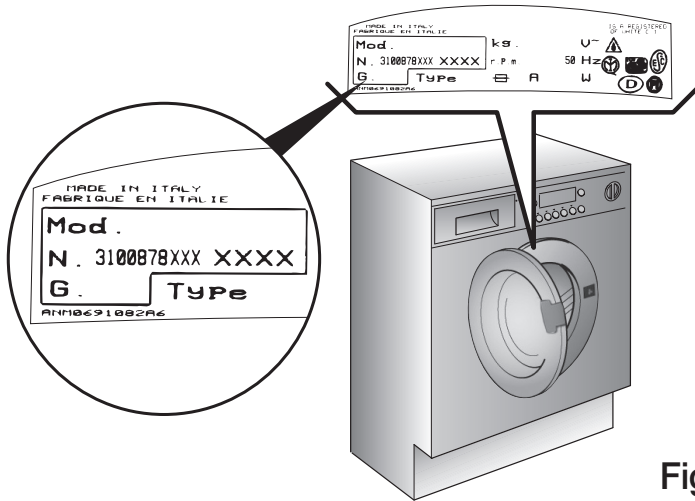

Fig. 2

## 技術規格

- 最大衣量
- 最大乾衣量
- 水壓

淨機身尺寸(不包括機門及按鈕)

- 闊
- 深
- 高

7 公斤  
5 公斤  
0.05 ÷ 0.8 MPa

60 厘米  
54 厘米  
82 厘米

備注：有關電子規格的技術內容，請參閱張貼於洗衣機正面(機門位置)的技術規格表  
— 如上圖示。



本產品符合73/23/EEC及89/336/EEC指令(其後為指令2006/95/EC及2004/108/EC)及其後繼的安全標準。

## 擺放及安裝

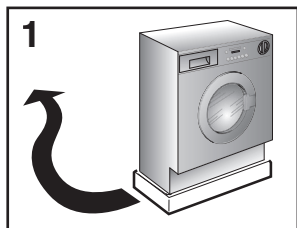

取走聚苯乙烯機腳保護墊，並將洗衣機放置於接近日後長期擺放之地方(圖1)。

小心剪掉將喉管固定於機身背部的索帶(圖2)。

拆除3顆固定螺絲(標記A)及3個定位膠墊(標記B)(圖3)。

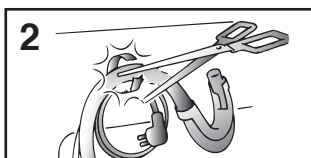

拆除螺絲(標記C)。

另一個定位膠墊將跌落在機身內側。將機身傾斜，便可取走上述定位膠墊。

利用附帶於操作指南包裝內的4個螺孔保護塞，覆蓋機身背部4個螺絲孔(圖4)。

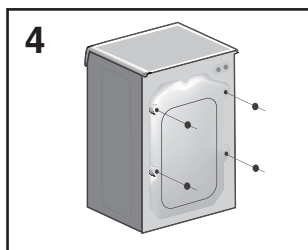
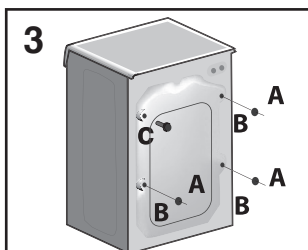

### 警告：

切勿將包裝棄置於小童可觸及的地方，以免造成危險並釀成意外。

如圖所示，將隔音墊放置於機腳下方。

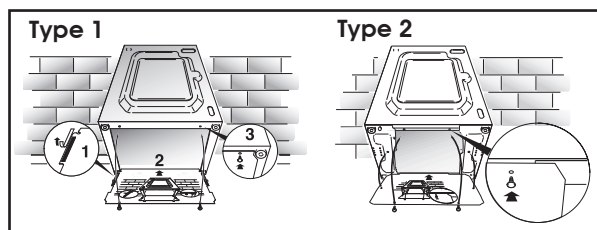

調校機腳以保持機身與地面成水平：

- 按順時針方向鬆開螺帽以便調校機腳。
- 以旋扭方法調整機腳高度，直至機身固定於地面上。
- 按逆時針方向轉動前方機腳螺帽，直至螺帽緊貼機身底部。

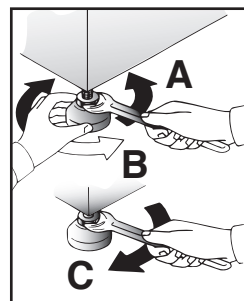

注意：

我們建議閣下保留固定螺絲以便日後搬遷之用。對於任何沒有依照本產品製造商所訂立指示安裝本產品而帶來任何損失，產品製造商將不會負責。同時，產品用家必需負擔所有安裝費用。

### 接駁水管

本產品必須使用全新的喉組接駁主要供水裝置。

老舊的喉組不應重複使用。

本洗衣機所用進水管接駁洗衣機進水部份和冷水供應裝置的接頭，採用3/4吋直徑的氣密螺紋管規格。

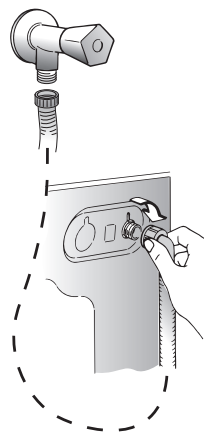

本洗衣機只利用冷水供應，因此只需利用一條喉管接駁冷水供應裝置。請勿將進水管接駁上熱水供應裝置。冷水供應系統具備良好的能源效益。只有用作洗衣的水需要加熱。不論需要供水的裝置是熱水壺、熱水煲，或本洗衣機，使用時都不會導致供水管道產生熱量流失。

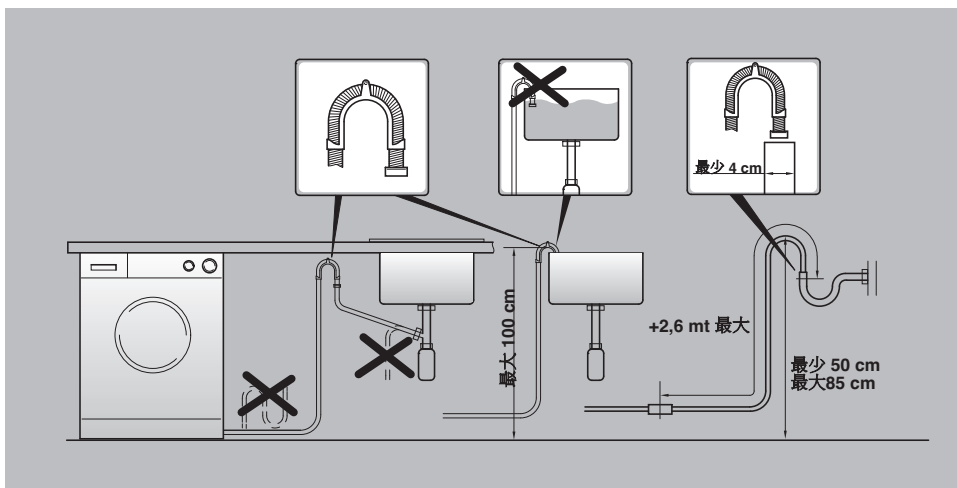

**注意：**建議每次完成洗衣後都關掉水龍頭，以確保洗衣機與供水裝置徹底分隔。

切勿將本洗衣機安裝於可上鎖的門後，同時門不能向本產品所處位置推開。

而為確保洗衣機正常操作，排水管的排水末端(接水口)的離地距須介乎最少50至最大85厘米。

### 接駁電線

安裝完成後，必須保留足夠空間確保電源線頭伸手可及。

假如我們提供的電源插頭並不適用

**請剪斷電線並將之妥善銷毀！**

閣下切勿將電源插頭用在其他電器之上，假如將剪掉的插頭連接到插座，外露的電線將有機會構成危險。更換合適插頭，請按以下步驟：

#### 接駁

黃、綠色線

#### 至插頭的插腳

以英文字母“E”標示，

或標以標記，  
或塗上綠色，  
或塗上黃、綠兩色

藍色線

以英文字母“N”標示，  
或塗上黑色

啡色線

以英文字母“L”標示，  
或塗上紅色

#### 警告

本產品必須接上設有地線的電源

#### 保險絲及電源插頭

使用此產品時，應使用具有最少13安培保險絲的插頭。

產品預設的電源插頭備有BS 1362ASTA認可的13安培保險絲，更換時必須採用相同設計。

假如遺失保險絲封蓋，請勿使用插頭直至重新裝上合適的封蓋。合適的封蓋(可向當地的零售商選購)必須與插頭底部導入部份的顏色或標示文字相同。

## 安裝洗衣機門板指示

按照紙板樣板在門板上鑽孔(參考右圖)，根據你的需要將鉸鏈和磁貼安裝在門板的右邊或左邊位置。門鉸的位置在上方。

用4粒螺絲 (A) 將鉸鏈上緊。  
用螺絲 (C) 將磁貼 (B) 上緊。

根據你的需要，將板塊(D)安裝於右邊或左邊。將橡膠圈 (E) 放在板塊底部，然後用螺絲(G)上緊。  
卡扣式安裝帽(H)安放於下方。

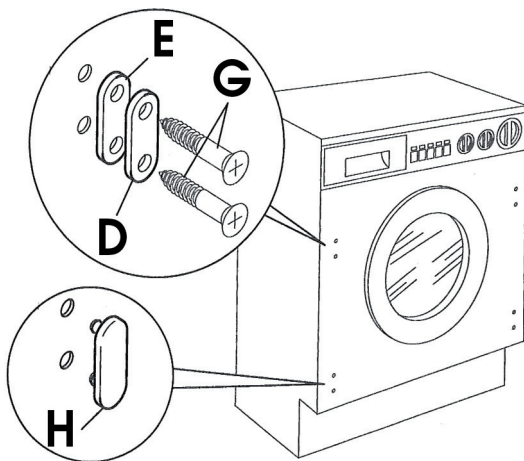
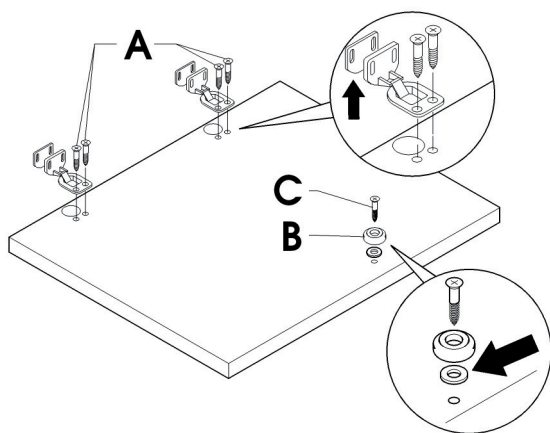
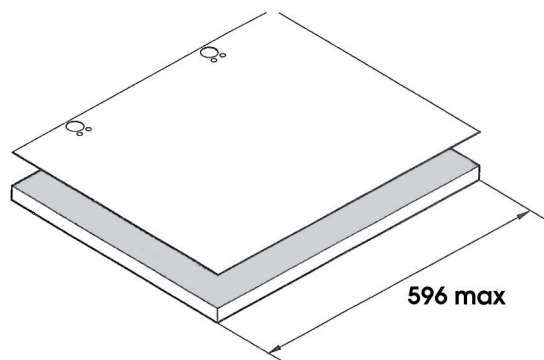

用螺絲(L)將鉸鏈上緊於門板上，然後將門板安裝在洗衣機前方。

**注意：**建議將門板開口朝向左邊，跟洗衣機機門相同方向，以獲取更多空間。

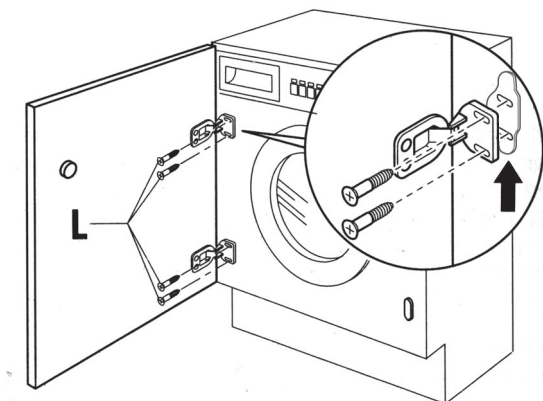

將洗衣機推入一個大小適合的位置。  
下方可加裝壁腳板，但尺寸需在提供的範圍之內。

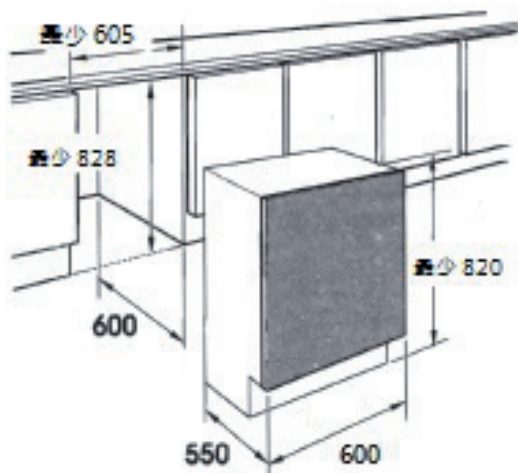

尺寸單位：毫米

洗衣機的四個可調較的腳架可將高度從820毫米(移走提供的螺帽，並以5毫米的螺帽取替)調整至最高840毫米，提高腳架後並鎖緊底板的螺帽。

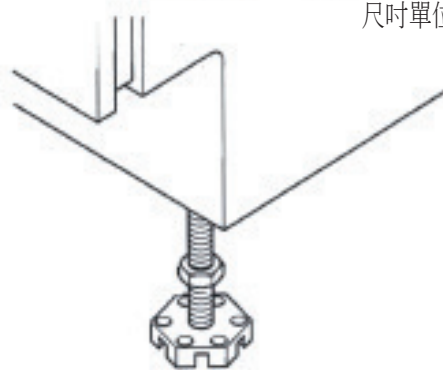



# Introduction

Please read these instructions for use carefully and all other information enclosed with the washing machine.

Keep all documentation in a safe place for future reference or for any future owners.



**This appliances is intended to be used in household and similar applications such as:**

- staff kitchen areas in shops, offices and other working environments;
- farm houses;
- by clients in hotels, motels and other residential type environments;
- bed and breakfast type environments.

A different use of this appliance from household environment or from typical housekeeping functions, as commercial use by expert or trained users, is excluded even in the above applications.

If the appliance is used in a manner inconsistent with this it may reduce the life of the appliance and may void the manufacturer's warranty.

Any damage to the appliance or other damage or loss arising through use that is not consistent with domestic or household use (even if located in a domestic or household environment) shall not be accepted by the manufacturer to the fullest extent permitted by law.

## Notes on disposal

All packaging material used is environmentally-friendly and recyclable. Please help dispose of the packaging via environmentally-friendly means.

**Your supplier or local council will be able to give you details of current means of disposal.**

Valuable materials can be salvaged from an old appliance via scrap reprocessing.

**Note: pull out the mains plug from any old appliance. Cut the power cable and dispose of it, together with the plug.**

When disposing of an old washing machine, please ensure that the door lock is rendered inoperable to prevent children shutting themselves in the appliance.

# Contents

# Page

Introduction	39
General delivery notes	41
Safety notes	41
<b>Quick start</b>	42
Description of controls	43
Programme Table	50
Programme selector	52
Detergent drawer	55
Detergents, washing aids and amounts to use	56
Useful advice for the user	58
The main wash	59
Drying	61
Automatic washing/drying cycle	62
Drying cycle	63
Cleaning and routine maintenance	65
Investigating malfunctions	66
Technical data	68
<b>Setting up + installation</b>	69

**BEFORE SWITCHING ON THE APPLIANCE MAKE SURE IT IS CORRECTLY INSTALLED AND THAT THE TRANSIT SCREWS ARE REMOVED AS SHOWN IN PAGE 69.**

# General delivery notes

On delivery check that there is the following with the appliance:

- Instruction manual
- Certificate of guarantee
- Caps
- Inlet hose
- Liquid detergent or liquid bleach compartment

and check that no damage has occurred during transit, and if so, call your nearest Authorised Technical Support Service agent (see Customer Service)

## Safety notes.

**Note: for any cleaning or maintenance procedure for the washing machine**

- A) Pull out the plug
- B) Turn off the tap
- C) **Whirlpool** equips all its appliances with earthing. Ensure that the mains supply is earthed, and if it is not, seek assistance from a qualified person.
- D) Do not touch the appliance when hands or feet are wet or damp. Do not use the appliance with bare feet.
- E) The use of adapters, multiple connectors and/or extensions is not recommended.

**Note:  
water temperature can reach 90°C during the wash cycle**

- F) Check there is no water left in the drum before opening the door.
- G) This appliance is not intended for use by persons (including children) with reduced physical, sensory or mental capabilities, or lack of experience and knowledge, unless they have been given supervision or instruction concerning use of the appliance by a person responsible for their safety.  
Children should be supervised to ensure that they do not play with the appliance.
- H) Do not pull the power cable or the appliance itself to remove the plug from the socket.
- I) The appliance must not be exposed to weather conditions (rain, direct sun, etc...)
- J) When moving the appliance never lift it by the controls or by the detergent drawer.  
When in transit never rest the door against the trolley or transport the appliance without the polystyrene base.

**K) N.B!**

If the appliance is installed on a carpeted floor ensure that the ventilation holes on the base of the appliance are not obstructed.

**L) If the appliance is not running properly or breaks down, switch it off, turn off the tap and do not tamper with the appliance.**

Consult only the Authorised Technical Support Service for possible repair and ask them to use original spare parts.

Failure to comply with the above can compromise the safety of the appliance.

**M) If the appliance's power cable should ever need replacing, consult the Authorised Technical Support Service**

## Quick start

### Washing

- Open the door by using the handle "A" (Fig. 1, page 43)
- Select laundry and put it in the machine
- Close the door
- Put detergent in the compartments as indicated in the programme guide in this instruction manual
- Select programme
- The display will show the settings for the programme selected.
- Adjust the wash temperature if necessary.

### DRYING

If you would like the drying cycle to begin automatically after washing, select the programme required using the Drying Selection button.

Otherwise it is possible to finish the wash and then decide on the drying programme and load.

### Press additional function buttons (if required)

- Press the "Start/Pause" button (page 44)
- The programme starts.

### After washing

- The word "End" will appear on the display.
- Wait for the door lock to be released (about 2 minutes after the programme has finished). The "Door Security" indicator light will go out.
- Switch off the washing machine by turning the selector to "OFF" position.
- Open the door and remove the laundry.

Ensure that the machine is correctly installed in line with the instructions found on page 69.

# Description of controls

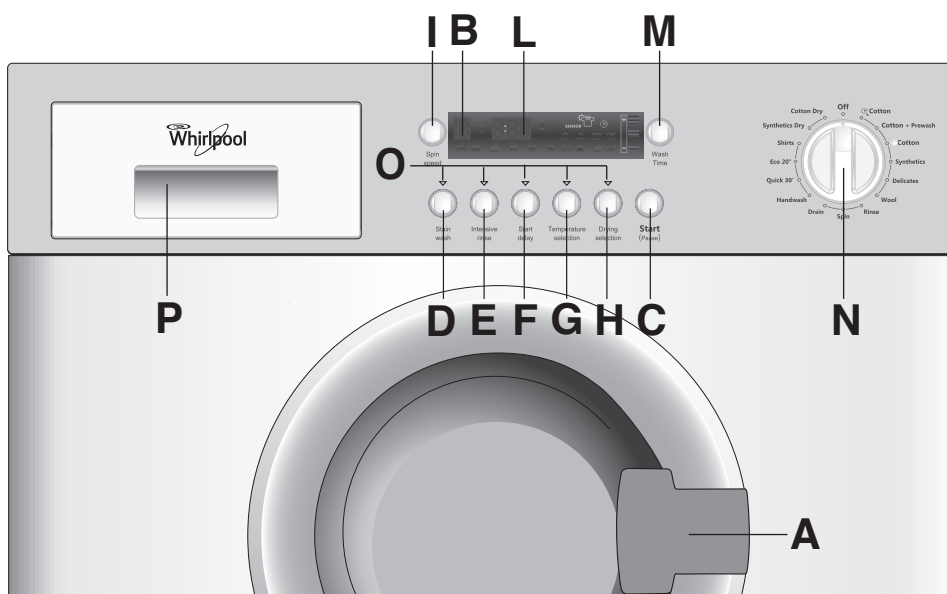

Door Handle	A
"Door Security" indicator light	B
"Start/Pause" button	C
"Stain wash" button	D
"Intensive rinse" button	E
"Start delay" button	F
"Temperature selection" button	G
"Drying selection" button	H
"Spin speed" button	I
Digital display	L
"Wash time" button	M
Programme selector with "OFF" position	N
Buttons indicator light	O
Detergent drawer	P

## Door handle

To open the door turn the handle in the manner illustrated in fig.

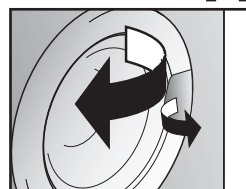

## “DOOR SECURITY” indicator light

**B**

The “Door Security” indicator light is illuminated when the door is fully closed and the machine is ON. When “Start/Pause” is pressed on the machine with the door closed the indicator will flash momentarily and then illuminate.

**If the door is not closed the indicator will continue to flash.**

A special safety device prevents the door from being opened immediately after the end of the cycle. Wait for 2 minutes after the wash cycle has finished and the “Door Security” light has gone out before opening the door. At the end of the cycle turn the programme selector to “OFF”.

## “START/PAUSE” button

**C**

Press to start the selected cycle .

**NOTE: When the “START/PAUSE” button has been pressed, the appliance can take few seconds before it starts working.**

### **Changing the settings after the programmes has started (PAUSE)**

Press and hold the “START/PAUSE” button for about 2 seconds, the flashing lights on the options buttons and time remaining indicator will show that the machine has been paused, adjust as required and press the “START/PAUSE” button again to cancel the flashing lights. If you wish to add or remove items during washing, wait 2 minutes until the safety device unlocks the door.

When you have carried out the manoeuvre, close the door, press “START/PAUSE” button and the appliance will continue working where it left off.

### **CANCELLING THE PROGRAMME**

To cancel the programme, set the selector to the “OFF” position.

Select a different programme.

Re-set the programme selector to the “OFF” position.

The option buttons should be selected before pressing the "START/PAUSE" button.

## “STAIN WASH” button

**D**

By pressing this button, which can only be activated in the **Cotton** cycles, the sensors in the new system come into operation. They affect both the selected temperature, keeping it at a constant level throughout the wash cycle, and the mechanical function of the drum.

The drum is made to turn at two different speeds at crucial moments. When the detergent enters the garments, the drum rotates in such a way that the detergent is distributed in a uniform manner; during the wash and rinse procedures, however, the speed increases in order to maximise the cleaning action. Thanks to this special system, the efficiency of the wash procedure is improved WITHOUT ANY INCREASE IN THE LENGTH OF THE PROGRAM.

---

## “INTENSIVE RINSE” button

**E**

By pressing this button you can activate a special new wash cycle in the **Cotton** and **Mixed Fabrics** programs, thanks to the new Sensor System. This option treats with care the fibres of garments and the delicate skin of those who wear them.

The load is washed in a much larger quantity of water and this, together with the new combined action of the drum rotation cycles, where water is filled and emptied, will give you garments which have been cleaned and rinsed to perfection. The amount of water in the wash is increased so that the detergent dissolves perfectly, ensuring an efficient cleaning action. The amount of water is also increased during the rinse procedure so as to remove all traces of detergent from the fibres. This function has been specifically designed for people with delicate and sensitive skin, for whom even a very small amount of detergent can cause irritation or allergy.

You are advised to also use this function for children's clothing and for delicate fabrics in general, or when washing garments made of towelling, where the fibres tend to absorb a greater quantity of detergent. To ensure the best performance for your wash, this function is always activated on the Delicates and Woollens/Handwash programs.

---

## “START DELAY” button

**F**

This button allows you to pre-programme the wash cycle to delay the start of the cycle for up to 24 hours.

To delay the start use the following procedure:

Set the required programme.

Press the button once to activate it (h00 appears on the display) and then press it again to set a 1 hour delay (h01 appears on the display); the pre-set delay increases by 1 hour each time the button is pressed, until h24 appears on the display, at which point pressing the button again will reset the delay start to zero.

Confirm by pressing the “START/PAUSE” button (the light on the display starts to flash). The countdown will begin and when it has finished the programme will start automatically.

It is possible to cancel the delay start by taking the following action:

Press and hold the button for 5 seconds until the display will show the settings for the programme selected.

At this stage it is possible to start the programme previously selected by pressing the "START/PAUSE" button or to cancel the process by setting the selector to the "OFF" position and then selecting another programme.

**Warning: If there is any break in the power supply while the machine is operating, a special memory stores the selected programme and, when the power is restored, it continues where it left off.**

---

## **"TEMPERATURE SELECTION" button**

# **G**

When a programme is selected the relevant indicator will light up to show the recommended wash temperature.

The Temperature button can be used to decrease or increase the temperature of your chosen wash cycle.

Each time the button is pressed, the new temperature level is shown on the Wash Temperature Indicator.

If you want carry out a cold wash all the indicators must be off.

---

## **"DRYING SELECTION" button**

# **H**

With the programme selector not in the "OFF" position, press the button to select the required drying programme; an indicator will light to display the drying result selected each time you press the button.

To cancel the selection before the start of a drying programme, press the button repeatedly until the indicators go out or return the programme selector to the "OFF" position.

To cancel the cycle during the drying phase, hold the button down for 2 seconds until the cooling indicator lights up; given the high temperature inside the drum, we recommend that you allow the dryer to complete the cool down period before returning the programme selector to the "OFF" position and removing the laundry.

## “SPIN SPEED” button

The spin cycle is very important to remove as much water as possible from the laundry without damaging the fabrics. You can adjust the spin speed of the machine to suit your needs.

By pressing this button, it is possible to reduce the maximum speed, and if you wish, the spin cycle can be cancelled. To reactivate the spin cycle press the button until you reach the spin speed you would like to set. To prevent damage to the fabrics, it is not possible to increase the speed over that which is automatically suitable during the selection of the program.

It is possible to modify the spin speed without to pausing the machine.

### Note:

The machine is fitted with a special electronic device, which prevents the spin cycle should the load be unbalanced. This reduces the noise and vibration in the machine and so prolongs the life of your machine.

## “DIGITAL” Display

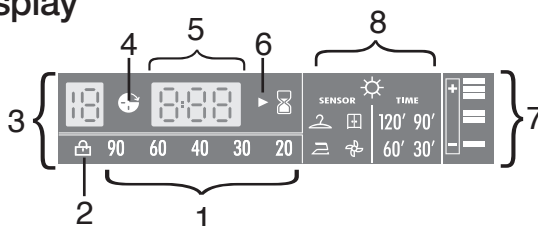

The display's indicator system allows you to be constantly informed about the status of the machine:

### 1) WASH TEMPERATURE

When a programme is selected the relevant indicator will light up to show the recommended wash temperature. The Temperature button can be used to decrease or increase the temperature of your chosen wash cycle. Each time the button is pressed, the new temperature level is shown on the Wash Temperature Indicator.

If you want carry out a cold wash all the indicators must be off.

### 2) DOOR LIGHT

Once the START/PAUSE button has been pressed the light first flashes then stops flashing and remains on until the end of the wash. 2 minutes after the end of the wash the light goes off to show that the door can now be opened.

### 3) SPIN SPEED

Once the programme has been selected, the maximum spin speed allowed for that programme appears on the display. Pressing the spin button will reduce the speed by 100 rpm each time the button is pressed. The minimum speed allowed is 400 rpm, or it is possible to omit the spin by pressing the spin button repeatedly.

### 4) DELAY START LIGHT

This flashes when delay start has been set.

### 5) CYCLE DURATION

When a programme is selected the display automatically shows the cycle duration, which can vary, depending on the options selected. Once the programme has started you will be kept informed constantly of the time remaining to the end of the wash. If is selected the automatic washing/drying, at the end of the wash phase, the drying time remaining to the end will be shown on the display.

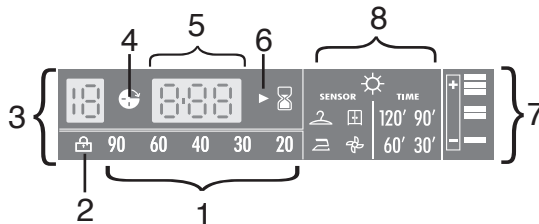

### 6) PROGRAMME START LIGHT

This lights up when the START button has been pressed.

### 7) WASH TIME

Once the programme has been selected the indicator light will automatically show the wash time set for that programme. Selecting a different wash time the relevant indicator will light up.

### 8) DRYING PROGRAMME INDICATORS

The indicators display the type of the drying programme:

The washer dryers incorporate an Automatic Sensor Drying function which takes the guesswork out of setting the drying time. You simply select the degree of dryness you require and the dryer automatically switches off when that level is reached. For added flexibility there are 3 Sensor Drying levels to choose from:

 = Extra dry programme

 = Cupboard dry programme

 = Iron dry programme

### USEFUL TIPS:

Once the programme option has been selected, press the Start/Pause button. The appliance will then calculate the time to the end of the selected programme based upon a full dry load. During the cycle the appliance will update the time to suit the actual load size and dampness of the fabrics.

### Timed programmes:

Alternatively you may select a pre-determined time for the drying cycle. The Timed Drying programmes may be set to the following times:

120 minutes – 90 minutes – 60 minutes – 30 minutes:

### Cool down phase :

A 10 minute cool down phase occurs at the end of each drying cycle to ensure clothes are not too hot to touch when the cycle finishes.

## “WASH TIME” button

**M**

By selecting this button (active only on COTTON and MIXED FIBRES programmes) there is a choice of 3 levels of wash intensity, depending on how much the fabrics are soiled. Once the programme has been selected the indicator light will automatically show the wash time set for that programme. Selecting a different wash time the relevant indicator will light up.

## PROGRAMME selector with "OFF" position

**N**

When the programme selector is turned the display lights up to show the settings for the programme selected.

N.B. To switch the machine off, turn the programme selector to the “OFF” position.

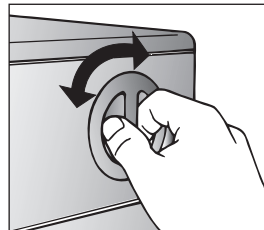

Today, most detergents have been improved to wash efficiently at lower temperatures, therefore we have set the default temperature settings of each programme to a lower level, saving electricity and reducing the carbon footprint of your machine.

you can select an high temperature by pressing the temperature button.

please refer to the programme guide for the maximum temperature to which each programme can be set.

Press the "START/PAUSE" button to start the selected cycle.

Once a programme is selected the programme selector remains stationary on the selected programme till cycle ends.

Switch off the washing machine by turning the selector to "OFF".

### Note:

The programme selector must be returned to the "OFF" position at the end of each cycle or when starting a subsequent wash cycle prior to the next programme being selected and started.

## Buttons indicator light

**O**

These light up when the relevant buttons are pressed.

If an option is selected that is not compatible with the selected programme then the light on the button first flashes and then goes off.

## TABLE OF PROGRAMMES

PROGRAM FOR:	PROGRAMME SELECTOR ON:	RECOMMENDED WEIGHT kg	RECOMMENDED TEMP. °C	MAX TEMP. °C	Duration APPROX. (hours:minutes) 2)	CHARGE DETERGENT		
							☼	
<b>Resistant fabrics</b> Cotton, linen	1)  <b>Cotton</b> *	7	60°	Up to: 90°	3:00	●	●	
Cotton, mixed resistant, Coloureds	1) <b>Cotton + Prewash</b> *	7	40°	Up to: 60°	3:20	●	●	●
<b>Resistant fabrics</b> Cotton	1) <b>eCotton</b> ** *	7	40°	Up to: 60°	4:00	●	●	
<b>Mixed fabrics and synthetics</b> Cotton, mixed fabrics, synthetics	<b>Synthetics</b> *	3.5	40°	Up to: 60°	2:00	●	●	
<b>Very delicate fabrics</b>	<b>Delicates</b>	2.5	40°	Up to: 40°	1:05	●	●	
“MACHINE WASHABLE” woollens	<b>Wool</b>	2	40°	Up to: 40°	1:00	●	●	
Rinse	* <b>Rinse</b>	-	-	-	0:25	△	●	
Fast spin	* <b>Spin</b>	-	-	-	0:10			
Drain only	<b>Drain</b>	-	-	-	0:04			
Hand wash	<b>Handwash</b>	1.5	30°	Up to: 30°	1:00	●	●	
Resistant fabrics Mixed fabrics and synthetics Rapid 30 minute	* <b>Quick 30'</b>	2.5	30°	Up to: 30°	0:30	●	●	
Resistant fabrics Mixed fabrics and synthetics	* <b>Eco 20°</b>	7	20°	Up to: 20°	1:50	●	●	
Cotton - Mixed	* <b>Shirts</b>	3.5	30°	Up to: 30°	2:00	●	●	
Synthetics - Drying	<b>Synthetics Dry</b>	3.5	-	-	2:20			
Cotton - Drying	<b>Cotton Dry</b>	5	-	-	3:10			

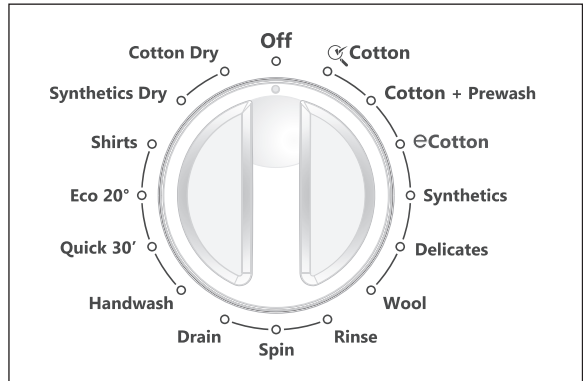
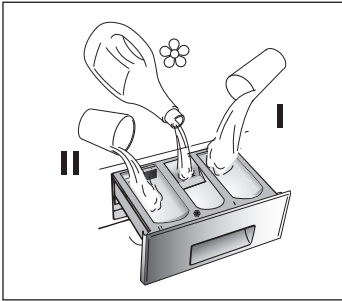

Please read these notes

### Information for the test laboratories (Ref. EN 50229 Standards)

#### Washing

Use the programme \*\* with the maximum stain level selected, maximum spin speed and a temperature of 60°C.  
Programme recommended also for test with a lower temperature.

#### Drying

First drying with 5kg (the load consist: pillowcases and hand-towels) selecting the cotton drying programme ( **Cotton Dry** ) cupboard dry (  $\text{II}$  ).  
Second drying with 2kg (the load consist: 2 sheets and hand towels) selecting the cotton drying programme ( **Cotton Dry** ) cupboard dry (  $\text{II}$  ).

The spin speed may also be reduced, to match any guidelines suggested on the fabric label, or for very delicate fabrics cancel the spin completely this option is available with a spin speed button.

■ Pressing the wash temperature button makes it possible to wash at any temperature below the maximum allowed.

\* Programmes for automatic drying.

1) For the programmes shown you can adjust the duration and intensity of the wash using the Wash Time button.

△ When only a limited number of articles have stains which require treatment with liquid bleaching agents, preliminary removal of stain can be carried out in the washing machine.  
Pour the bleach into the liquid bleach container, inserted into the compartment marked "II" in the detergent drawer, and set the special programme "RINSE".

When this phase has terminated, switch off the appliance, add the rest of the fabrics and proceed with a normal wash on the most suitable programme.

2) The time of the cycle depends on the amount of load, type of fabrics, water pressure and temperature, etc.

# Programme selector

For the various types of fabrics and various degrees of dirt the washing machine has different programme bands according to: wash cycle, temperature and length of cycle (see table of washing cycle programmes).

## COTTONS

The Cottons programme is designed for maximum washing and rinsing efficiency. With spin cycles in between, the programme guarantees the laundry is rinsed perfectly. The final spin cycle ensures laundry is spun dry as much as possible up to the maximum speed.

The Cotton programme includes a Prewash cycle. This option is particularly useful for really dirty loads and can be used independently of the main wash programme. Additional detergent for the Prewash part of the programme should be added to the first compartment of the soap drawer labelled "I" (please refer to the section of this manual entitled "Detergent"). We recommend you use only 20% of the quantity used for the main wash programme.

 Cotton

Cotton +  
Prewash

eCotton

## MIXED AND SYNTHETIC FABRICS

The main wash and the rinse gives best results thanks to the rotation rhythms of the drum and to the water levels.

A gentle spin will mean that the fabrics become less creased.

Synthetics

## SPECIAL DELICATE FIBRES

This is a new wash cycle which alternates washing and soaking and is particularly recommended for very delicate fabrics.

The wash cycle and rinses are carried out with high water levels to ensure best results.

Delicates

## WOOL PROGRAMME

The special cycle enables to thoroughly wash garments without damaging them. The cycle comprises of alternate periods of activity and pauses. The programme has a maximum temperature of 40°C and concludes with 3 rinses and a short spin.

Wool

## SPECIAL "RINSE" PROGRAMME

This programme carries out three rinses with a intermediate spin (which can be reduced or excluded by using the correct button). It can be used for rinsing any type of fabric, eg. use after hand-washing.

Rinse

This program can be also used as cycle of Bleaching (see table of washing cycle programmes).

### **SPECIAL “SPIN” PROGRAMME**

Programme “SPIN” carries out a maximum spin (which can be reduced by using the correct button).

**Spin**

### **DRAIN ONLY**

This programme drains out the water.

**Drain**

### **SPECIAL “HAND WASH”**

This washing machine also has a gentle Hand Wash programme cycle. This programme allows a complete washing cycle for garments specified as “Hand Wash only” on the fabric care label. The programme has a temperature of 30°C and concludes with 3 rinses and a slow spin.

**Handwash**

### **RAPID PROGRAMME**

The 30 minute rapid programme allows a complete washing cycle to be carried out in approximately 30 minutes, with up to a maximum load of 2,5 kg and a temperature of 30°C.

When selecting the “**Quick 30’**” programme, please note that we recommend you use only 20% of the recommended quantities shown on the detergent pack.

**Quick 30’**

### **ECO 20°C**

This innovative programme, allows you to wash different fabrics and colours together, such as cottons, synthetics and mixed fabrics at only 20°C and provides an excellent cleaning performance.

Consumption on this program is about 40% of a conventional 40°C cottons wash.

**Eco 20°**

### **“SHIRTS” PROGRAMME**

This programme allows a complete washing cycle for shirts.

The main wash and the rinse gives best results thanks to the rotation rhythms of the drum and to the water levels.

The programme has a maximum temperature of 30°C and concludes with 3 rinses and a short spin.

**Shirts**

## **DRYING**

**Note: Dispensers used for concentrated powders and liquid detergents must be removed from the drum before commencing the tumble drying programmes.**

The drum changes direction during the drying cycle to prevent the laundry from tangling and hence produce even drying. Cool air is used during the last ten minutes of the drying cycle to minimise creasing.

### **LOW HEAT**

Low temperature drying programme for synthetics and mixed fibres, always refer to the care label.

**Synthetics  
Dry**

### **HIGH HEAT**

High temperature drying programme for Cottons and linen items, always refer to the care label

**Cotton Dry**

# Detergent drawer

P

The detergent drawer is split into 3 compartments:

- the compartment labelled "I" is for prewash detergent;
- the compartment labelled "☼" is for special additives, fabric softeners, fragrances, starch, brighteners etc;
- the compartment labelled "II" is for main wash detergent.

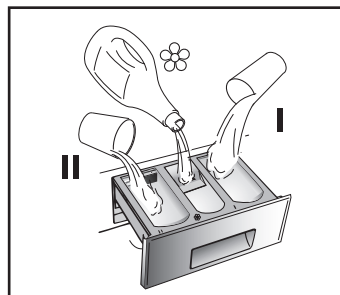

If liquid detergents are used, please insert the special container supplied into the compartment marked "II" in the detergent drawer. This ensures that the liquid detergent enters the drum at the right stage of the wash cycle.

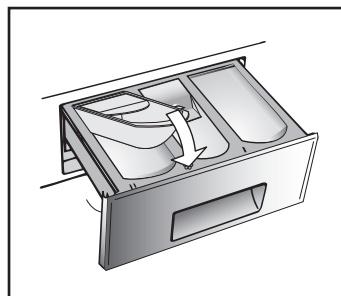

This special container must be inserted into the compartment marked "II" in the detergent drawer, also when you wish to use the "RINSE" programme as BLEACHING cycle.

## NOTE:

Some Detergents are Difficult to utilise. Ensure to use an in drum dispenser if recommended by the detergent Manufacturer.

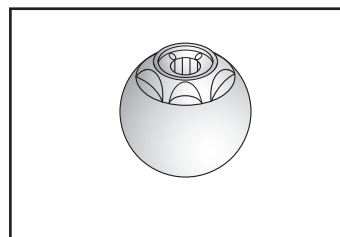

Note: only put liquid products in the compartment labelled "☼". The machine is programmed to automatically take up additives during the final rinse stage for all wash cycles.

# Detergents, washing aids and amounts to use

## Choice of detergent

### General purpose detergents

- **Powder detergents**, for a thorough wash, with bleaching agent, particularly suitable for use in hot wash programmes (60°C and over), for heavily soiled and stained laundry.
- **Liquid detergents**, particularly suitable for grease stains, such as greasy skin marks, cosmetics and oil.  
These detergents are not suitable for washing stained laundry, as they do not contain bleach.
- **Biological detergents**, not all the products available give a really thorough wash.

### Additional laundry aids

- **Water softener**, means less detergent can be used where water hardness is classed as hard to very hard.
- **Prewash substances**, for the programmed treatment of stains prior to the main wash. Using them means the subsequent wash can be at a low temperature or with bleach-free detergents.
- **Fabric softener**, prevents static build-up in synthetic fabrics and softens fabrics. If you own a tumble dryer, clothes are softened even without the use of a fabric softener.

### Do not put solvents in the washing machine!

Keep detergents and other laundry products out of children's reach.

Before pouring in the detergent check that there are no foreign bodies in the detergent drawer.

Dosage details are usually shown on the detergent packaging. Follow those instructions.

## Dosages

Only use detergents which are suitable for use in a washing machine.

You will obtain the best results from your wash with the minimum use of chemical products and the best care for your laundry if you take into consideration the degree of soiling as well as the type of detergent to choose.

The amount of detergent to use depends on:

- water hardness: depending on the hardness of the water and the type of detergent used, it is possible to reduce the amount of detergent.
- the degree of soiling: it is possible to reduce the amount of detergent used depending on the degree of soiling.
- amount of laundry: it is possible to reduce the amount of detergent when washing only a small amount of laundry.

### Dosage for powder detergent

**For normal and low concentration detergents:** for normally soiled laundry choose a programme without prewash.

Put the detergent in compartment “II” of the drawer.

For heavily soiled laundry, choose a programme with prewash.

Put 1/4 of the detergent in compartment “I”, 3/4 in compartment “II” of the drawer.

When using water softeners, first put in the detergent, then add the softener to compartment “II”.

For highly concentrated detergents not in single dose format, follow what is shown on pack exactly as regards type and amount of dosage.

To avoid the difficulty of checking if the detergent has been taken up, use the dosage aids provided in the detergent packaging.

### Liquid detergent dosage

Liquid detergents may be used in accordance with the instructions on the relevant packaging, for all programmes without prewash, by using the special container which is placed in the drum or, for those models that have it, in the special insert for liquid detergents.

### Recommendations on the use of detergent at various temperatures

When washing heavily soiled whites, we recommend using cotton programs of 60°C or above and a normal washing powder (heavy duty) that contains bleaching agents that at medium/high temperatures provide excellent results. For washes between 40°C and 60°C the type of detergent used needs to be appropriate for the type of fabric and level of soiling. Normal powders are suitable for “white” or colour fast fabrics with high soiling, while liquid detergents or “colour protecting” powders are suitable for coloured fabrics with light levels of soiling. For washing at temperatures below 40°C we recommend the use of liquid detergents or detergents specifically labeled as suitable for low temperature washing. For washing wool or silk, only use detergents specifically formulated for these fabrics. For dosage amounts please follow the instructions on the detergent package label.

# Useful advice for users

Tips on using your domestic appliance in the most environmentally-friendly and economical way

## Do a full load in your washing machine

To prevent any possible waste of energy, water or detergent we recommend that you put a full load in your washing machine, not exceed the recommended maximum load size. Up to 50% energy saving can be made with one full load compared to two half load washes

## When is prewashing really needed?

Only with particularly dirty loads!

Energy savings of 5 to 15% are made by not selecting the prewash option for normal soiled laundry.

## Which wash temperature should you choose?

Using stain removers before machine washing reduces the need to wash at temperatures over 60°C.

Energy savings of up to 50% can be made by using a 60°C wash temperature rather than 90°C

## Before using a drying programme...

SAVE energy and time by selecting a high spin speed to reduce the water content in laundry before using a drying programme.

# Main wash

## Sorting the laundry

- It is recommended you wash only items which are machine washable with water and detergent and not dry-clean items.
- If you need to wash rugs, bedspreads or other heavy items, it is best not to spin them.
- Sort the laundry according to fabric type, degree of soiling and wash temperature: Always follow the wash care advice on the garment label for the most suitable care and treatment of the laundry

**Laundry for hot wash** \ 95° /

**Coloured, easy-care materials** \ 60° / \ 50° / \ 40° /

**Delicates and wool** \ 40° / \ 30° /

**Wash by hand** 

Items labelled with the following symbol are not suitable for machine washing:

**Dry clean** 

For very delicate items, such as net curtains, underwear, tights etc., you are advised to use a laundry net or wash bag.

- Woollen items must be labelled with the "Pure New Wool" symbol to be washed in the machine and must also be labelled "non-matting" or "machine washable".
- Colour often leaks from new coloured items.

This can then colour other lighter items being washed.

We therefore recommend that coloured items should be washed for the first time separately.

For future washes, colourfast items can only be washed with whites up to 40°C.

### Note: when sorting laundry

- check there are no metal objects in the laundry (such as paper clips, safety pins, pins, coins etc...);
- button up pillowcases, fasten zips, hook & eye fasteners, belts and long dressing gown cords;
- remove curtain hooks;
- pay close attention to the labels on items
- if you notice stubborn stains whilst sorting the laundry, remove them using a special detergent or a special stain remover.

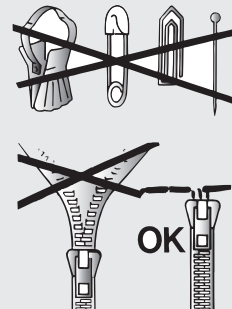

- We recommend that you do not do a full load of towelling items only as these become too heavy since they absorb a lot of water.

## The correct way to wash

### Preparing the laundry

A) Select the laundry.

### Loading the laundry

B) Open the porthole.

C) Put the laundry in the washing machine.

Close the porthole again, ensuring that no items of laundry are obstructing the lock.

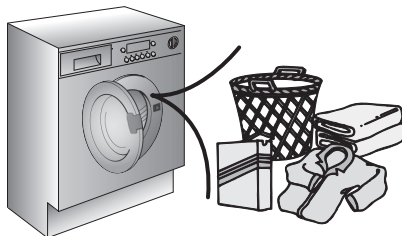

### Putting detergent in machine

D) Open the drawer, choose the detergent and put in the correct amount, according to the manufacturer's instructions and the advice on page 56.

Add any other laundry aids (see page 56). Close the drawer again.

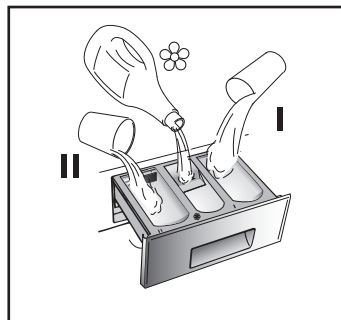

## Selecting the wash programme

Refer to the programme guide or the programme descriptions on the machine to select the most suitable programme.

Turning the selector knob, the required programme is activated.

Adjust the wash temperature if necessary.

Press additional function buttons (if required).

Check that the tap is turned on and that the discharge hose is positioned correctly.

Press the "**Start/Pause**" button.

When the "**Start/Pause**" button is pressed the machine sets the working sequence in motion.

The programme carries out with the programme selector stationary on the selected programme till cycle ends.

**Warning:** If there is any break in the power supply while the machine is operating, a special memory stores the selected programme and, when the power is restored, it continues where it left off.

## When the programme is finished

The word "End" will appear on the display.

Wait for the door lock to be released (about 2 minutes after the programme has finished).

The "**Door Security**" indicator light will go out.

Switch off the machine by turning the programme selector on the "**OFF**" position. Open the door and remove the laundry. Turn off the tap.

# DRYING

**DON'T DRY GARMENTS MADE FROM FOAM RUBBER OR FLAMMABLE MATERIALS.**

**IMPORTANT:  
THIS DRYER CAN ONLY BE USED FOR LAUNDRY  
WHICH HAS BEEN WASHED AND SPIN DRIED.**

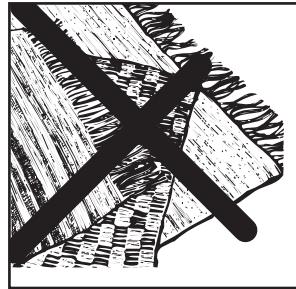

## WARNING:

Indications given are general, therefore some practice is needed for the best drying results. We recommend setting a lower drying time than indicated, when first using, so as to establish the degree of dryness required. We recommend not to dry fabrics that fray easily, such as rugs or garments with a deep pile, to avoid air duct clogging.

The water is then conveyed to the drain circuit, which is sealed and therefore, no steam can be released outside.

## Important

**Never open the door after the drying cycle has begun - wait until the cool down period provided for by the cycle.** 

Only dry pre-spun laundry

The washer/dryer can perform two types of drying:

1 Cotton, terry towelling, linen, hemp fabrics, etc... **Cotton Dry** symbol on programme dial.

Advisory note

**During drying phase the drum will accelerate to a higher speed to distribute the load and to optimize the drying performance**

2 Mixed fabrics (synthetics/cotton), synthetic fabrics **Synthetics Dry** symbol on programme dial.

# Automatic washing/drying

**Warning: only a maximum 5 kg of dry laundry can be loaded otherwise the dried laundry will be not satisfactory.**

## WASHING:

Open the drawer, choose the detergent and put in the correct amount.

Refer to the list of washing programmes according to fabrics to be washed (e.g. very dirty cotton) and without pressing Start button, prepare wash as described:

Turning the selector knob, the required programme is activated.

The display will show the settings for the programme selected.



Adjust the wash temperature if necessary.

Press the option buttons (if required)

Check that the tap is turned on and that the discharge hose is positioned correctly.

## DRYING:

Select the degree of dryness that you require.

This ranges from Extra Dry (  ) for bath towels and bathrobes, through Cupboard Dry (  ) for items that will be put away without ironing, to iron dry (  ) that leaves the laundry suitable for ironing.

If you wish to select a timed drying cycle, press the "drying selection" button until the required time indicator lights up.

Press the "**Start/Pause**" button.

When the "**Start/Pause**" button is pressed the machine sets the working sequence in motion.

The programme carries out with the programme selector stationary on the selected programme till cycle ends.

At the end of the wash phase the display will shown the drying time remaining.

The washer-dryer will then complete the entire drying programme.

The drying programme indicator will be on until the cool down phase will begin and the indicator "" will go on.

## When the programme is finished

The word "End" will appear on the display.

Wait for the door lock to be released (about 2 minutes after the programme has finished).

The "**Door Security**" indicator light will go out.



Switch off the machine by turning the programme selector on the "**OFF**" position. Open the door and remove the laundry. Turn off the tap.

# Drying cycle

## The correct way to dry:

- Open door.
- Fill with up to 5 kg - in case of large items (e.g. sheets) or very absorbent items (e.g. towels or jeans), it is a good idea to reduce the load.
- Close door.
- Turn programme dial to **Cotton Dry** cotton.

Select the degree of dryness that you require.

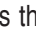
This ranges from Extra Dry (  ) for bath towels and bathrobes, through Cupboard Dry (  ) for items that will be put away without ironing, to iron dry (  ) that leaves the laundry suitable for ironing.

If you wish to select a timed drying cycle, press the “drying selection” button until the required time indicator lights up.

## DOUBLE-SKIN DOOR

The appliance door is fitted with a protective shield to prevent contact with the glass door which can reach high temperatures, during the drying cycle.

It should not be necessary to remove the shield from the machine during the normal course of use.

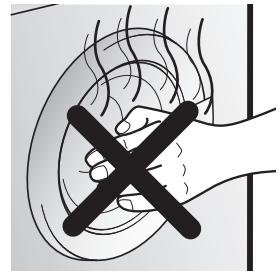

**Warning: do not touch door for any reason.**

- Make sure water inlet valve is open.
- Make sure water drain is correctly positioned.

### Warning:

**do not dry woollen garments or articles with special padding, (e.g. quilts, quilted anoraks, etc.).**

**Delicate fabrics if garments are drip/dry, load less items so as to prevent creasing.**

Press the START button.

The drying phase will begin with the programme dial fixed on the **Cotton Dry** symbol until the end of drying.

The drying programme indicator will be on until the cool down phase will begin and the indicator “” will go on.

## When the programme is finished

The word “End” will appear on the display.

Wait for the door lock to be released (about 2 minutes after the programme has finished).

The “**Door Security**” indicator light will go out.

Switch off the machine by turning the programme selector on the “**OFF**” position. Open the door and remove the laundry. Turn off the tap.

## Table of drying times (in minutes):

PROGRAMME	COTTON		MIXED	
	Min 1 Kg	Max 5 Kg	Min 1 Kg	Max 3.5 Kg
<i>Extra</i>	<i>from 30'</i>	<i>to 230'</i>	<i>from 30'</i>	<i>to 170'</i>
<i>Cupboard</i>	<i>from 30'</i>	<i>to 220'</i>	<i>from 30'</i>	<i>to 150'</i>
<i>Iron</i>	<i>from 30'</i>	<i>to 170'</i>	<i>from 30'</i>	<i>to 80'</i>

The time remaining shown on the digital display will show the time remaining for a full load. However, this will be corrected during the cycle once the appliance assesses the weight and dampness of the laundry.

### USEFUL TIPS:

Do not dry unwashed items in the washer dryer.

Items that have been soiled with substances such as cooking oil, acetone, alcohol, petrol, kerosene, spot removers, turpentine, waxes and wax removers should be washed in hot water with an extra amount of detergent before being dried in the washer dryer.

Items such as foam rubber (latex foam), shower caps, waterproof textiles, rubber backed articles and clothes or pillows fitted with foam rubber pads should not be dried in the washer dryer.

Fabric softeners, or similar products, should be used as specified by the fabric softener instructions.

The final part of a washer dryer cycle occurs without heat (cool down cycle) to ensure that the items are left at a temperature that ensures that the items will not be damaged.

#### WARNING:

Never stop a washer dryer before the end of the drying cycle unless all items are quickly removed and spread out so that the heat is dissipated.

# Cleaning and routine maintenance

Do not use alcohol-based scourers and / or thinners on the outside of your washing machine, just a wipe with a damp cloth will suffice. The washing machine needs very little maintenance:

- Cleaning the drawer compartments.
- Cleaning the filter.
- Cleaning the door glass.

## Cleaning the drawer compartments

Even if it is not strictly necessary, it is good to clean the compartments for bleaching detergents and additives occasionally.

- To do this you just need to pull them out firmly, but without forcing them.
- Clean everything in the compartment under running water.
- Put everything back in its proper place.

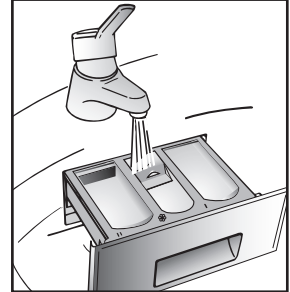

## Cleaning the filter

The washing machine is fitted with a special filter for handling large deposits which could block the discharge hose (coins, buttons etc.) and which can, therefore, be easily retrieved.

**We recommend that the filter be cleaned at least once a month.**

The cleaning operation is as follows:

- Before removing the filter, place an absorbent towel below the filter cap to collect the small amount of water likely to be inside the pump
- Turn the filter anti-clockwise until it stops in the vertical position.  
Remove and clean.
- After cleaning, replace by turning the notch on the end of the filter clockwise.

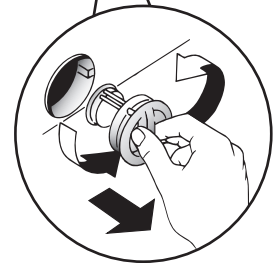

## Cleaning the door glass

Regularly clean the door glass with a damp cloth. A build up of soiling and residues from the water may result in water leaking from the door.

Do not use abrasive cleaners as they can scratch the surface.

## Transporting the appliance or long periods when appliance is not in use

If the appliance is being transported or is out of use for long periods in unheated places, all remaining water must be completely removed from the hoses.

Ensure mains power is off, then unclip the hose and point it downwards into a basin until all the water has emptied out. When finished, repeat the operation in the reverse order.

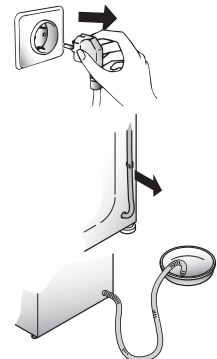

# Investigating malfunctions

## What might be the cause of... Defects you can remedy yourself

MALFUNCTION	CAUSE	REMEDY
1. Does not work on any programme	Plug not in socket. Not switched on. Power failure. Fuse blown. Door open.	Plug it in. Switch on. Check. Check. Close door.
2. Does not fill with water	See cause 1. Tap turned off. Programme selector not correctly positioned. Fill hoses are kinked	Check. Turn on tap. Position programme selector correctly. Straighten fill hoses
3. Water does not drain away	Kink in discharge hose. House drain is blocked Foreign bodies in filter	Straighten discharge hose. Clean drain Examine filter
4. Water on floor around the washing machine	Leaking gasket between tap and water inlet hose. House drain is blocked Soap drawer blocked with soap residues	Replace gasket and tighten hose and tap well. Clean drain Clean soap drawer
5. Does not spin	Water has not yet drained away. "No spin" selected (certain models only).	Wait a few minutes for machine to empty. Reset button or turn "no spin" knob.
6. Machine vibrates a lot during spin	Washing machine not completely level. Transit brackets not removed yet. Load not distributed evenly.	Adjust the special adjustable feet. Remove transit brackets. Rearrange the laundry evenly.
7. Door will not open	Two minutes have not elapsed since the programme finished.	Wait two minutes.
8. Display reads error 0, 1, 5, 7, 8, 9	–	Call service.
9. Display reads error 2	No water fill.	Check water supplies are on.
10. Display reads error 3	No pump out.	Check drain is clear. Check drain hose is not kinked.
11. Display reads error 4	Machine overfilled with water.	Turn off water supply to machine. Call service.

**During drying phase the drum will accelerate to a higher speed to distribute the load and to optimize the drying performance**

The machine makes a different noise when spinning! This is because it has a brush motor for better performance.

Only a small level of water can be seen in the drum! This is because new machines do not use much water, yet achieve the same standard of washing and rinsing.

**Note:**

The use of environmentally-friendly, phosphate-free detergents can have the following effects:

- waste water from rinsing may be cloudier because of the presence of zeolites held in suspension, without the rinse performance being adversely affected;
  - presence of white powder (zeolites) on laundry after washing, which is not absorbed by the fabric and does not alter the colour of the fabric.
  - The presence of foam in the final rinsing water is not necessarily an indication of poor rinsing.
  - Anionic surfactants used in washing detergent formulae often prove to be difficult to remove from the laundry itself and, even in small quantities, can still cause considerable foam production.
  - Carrying out more rinse cycles does not serve any purpose in such cases.
-

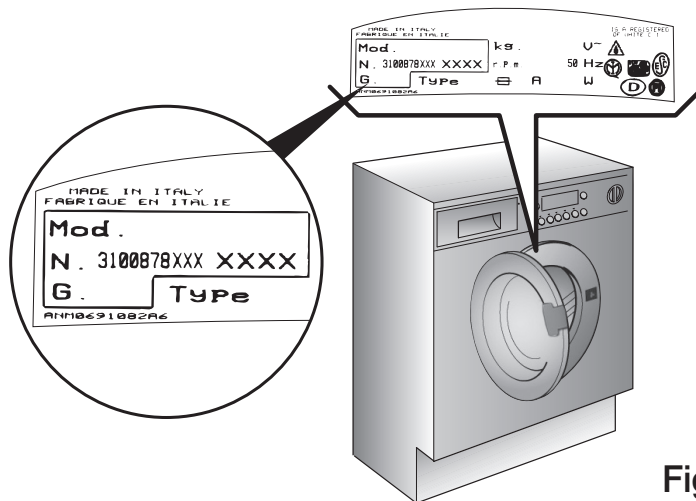

Fig. 2

## Technical data

- Max. load of dry laundry
- Max. load of dry laundry for drying
- Water pressure

Measurements (Exclude Door & Button)

- Width
- Depth
- Height

7 kg  
5 kg  
0,05 ÷ 0,8 MPa

60 cm  
54 cm  
82 cm

NB: For specifications regarding electrical data, see the data panel on the front of the washing machine (porthole area) - as shown in diagram above.

**CE** Appliance complies with European Directives 73/23/EEC and 89/336/EEC, replaced by 2006/95/EC and 2004/108/EC, and subsequent amendments.

# SETTING UP + INSTALLATION

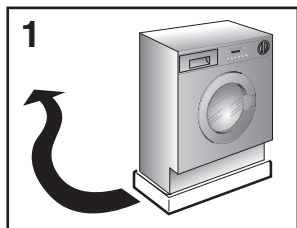

Remove the polystyrene base and place the machine near its permanent position (diagram 1).

Carefully cut through the hose retaining clip at the rear of the appliance (diagram 2).

Remove the 3 fixing screws marked (A) and remove the 3 spacers marked (B) (diagram 3).



Remove the screw (C).

A spacer will fall inside the machine.

By tilting the machine, remove the above mentioned spacer.

Cover the 4 holes using the caps provided in the instruction booklet pack (diagram 4).

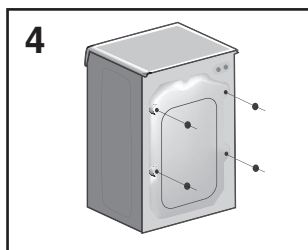
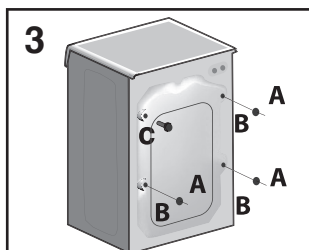

## WARNING:

DO NOT LEAVE THE PACKAGING WITHIN REACH OF CHILDREN AS IT IS A POTENTIAL SOURCE OF DANGER.

Apply the insulation sheet of corrugated material to the base as shown.

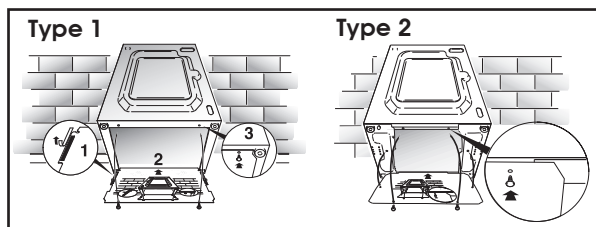

Use the 4 feet to level the machine with the floor:

- Turn the nut clockwise to release the screw adjuster on the foot.
- Rotate the foot to raise or lower it until it stands firmly on the ground.
- Lock the foot in position by turning the nut anti-clockwise until it comes up against the bottom of the machine.

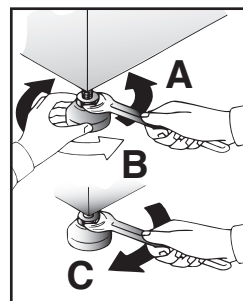

**Note: we recommend you keep the screws to immobilise the machine for future transit.**

**The Manufacturers will not be responsible for any possible damage to the machine caused by not following the rules relating to releasing the mechanism. The user is responsible for all costs of installation.**

## Water connection

The appliance must be connected to the water mains using new hose-sets.

The old hose-sets should not be re-used.

The machine has an inlet hose with 3/4" B.S.P threaded end connection to attach between the threaded connector on the appliance and the cold water supply.

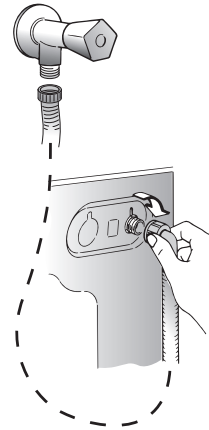

**This machine only uses cold water, therefore only one hose is needed to connect to the cold water supply. Do not connect to the hot supply. Cold fill is an energy efficient system. Only the water required for the washing is heated. There is no loss of heat in the pipeline from a hot water tank or boiler to the machine.**

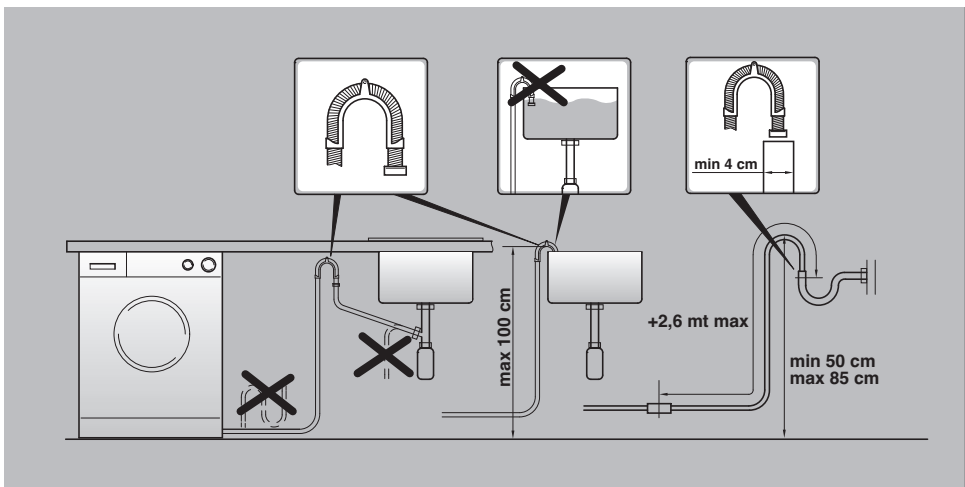

**Note:** it is advisable to turn off the tap after each wash to isolate the washing machine from the water supply.

The appliance must not be installed behind a lockable door, a sliding door or a door with a hinge on the opposite side to that of the washer dryer.

For the washing machine to function properly the terminal end of the discharge hose (mouth) must be at a minimum of 50 cm and a maximum of 85 cm from the ground.

## ELECTRICAL CONNECTIONS

After installation, the appliance must be positioned so that the plug is accessible.

If the plug we supply does not fit

**CUT IT OFF AND DESTROY IT!**

You can't use it on other appliances, and the exposed wires could be dangerous if plugged in.

To fit a replacement plug, proceed as follows:

### Connect

green and yellow wire

### to the terminal in the plug

marked with the letter E,  
OR marked  
with the symbol, - - - -   
OR coloured green,  
OR coloured green and yellow.

blue wire

marked N  
OR coloured black.

brown wire

marked L  
OR coloured red.

### WARNING

This appliance must be earthed

Fuses and plugs

This appliance should be used only on a socket with a minimum rating of 13 Amp.

Our ready-fitted plug is already equipped with a 13 amp fuse which is BS 1362 ASTA approved. Any replacement should be exactly the same.

If the fuse cover is lost, do not use the plug until it is replaced. A correct replacement fuse cover (obtainable from your local retailer) must be the same colour as shown or named on the insert on the base of the plug.

## INSTRUCTIONS FOR MOUNTING DOOR

Drill holes in the door using the cardboard template as indicated in Fig. 1 to mount the hinge and closure magnet in the right or left-hand position according to your requirements. The position of the hinges refers to the upper edge.

Screw the hinges in place with the 4 screws (A). Screw on the magnet (B) with screw (C).

Mount the plate (D) in the right or left-hand position, according to your requirements. Place the rubber washers under the plate and screw in place with screw (G). Snapmount cap (H) in the lower position.

Fig.1

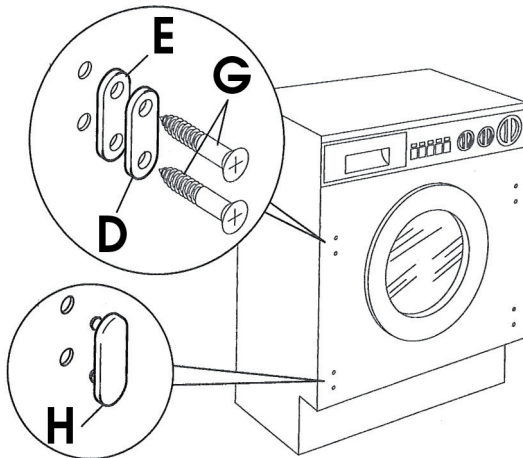
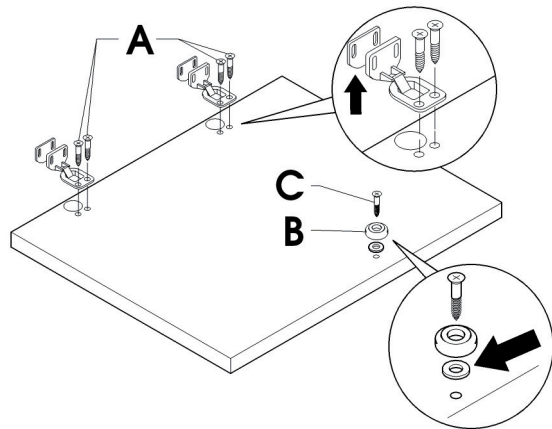
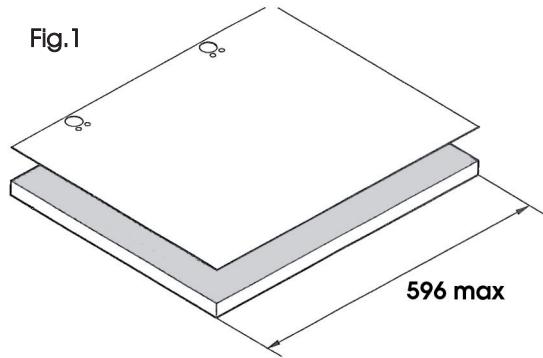

Mount the door with hinges by screwing with screws (L) to the front of the washing machine.

**NOTE:** You are advised to mount the door so that it opens towards the left, in the same direction as the washing machine load door for more loading space.

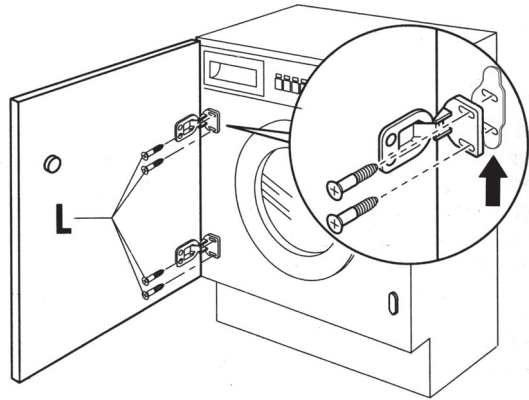

Slide the washing machine into an opening of adequate size. The lower skirting may be applied as preferred but within the size provided for.

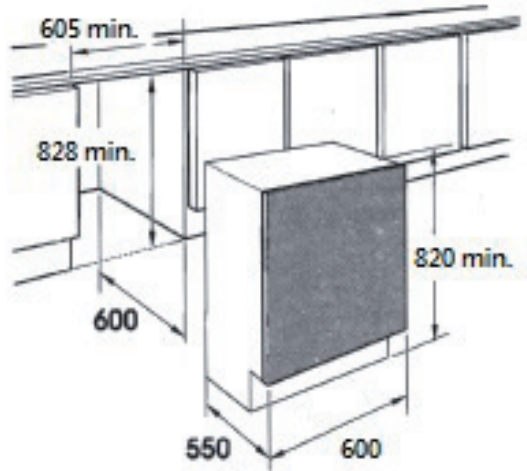

The four adjustable feet allow the height of the washing machine to be adjusted from 820 mm (by removing the nuts supplied and substituting with 5 mm nuts) to a max. 840 mm by raising the feet and blocking the lock nut to the base of the plate.

Unit: mm

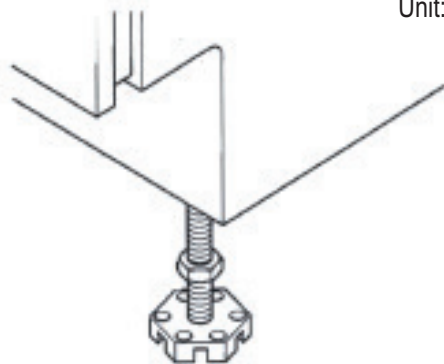



任何因為本書印刷錯誤造成的後果和責任，本產品製造商一概不負責。本產品製造商亦保留權利在維持產品主要特徵的情況下，對產品規格進行任何製造商視之為適當的修改。

**The manufacturer declines all responsibility in the event of any printing mistakes in this booklet. The manufacturer also reserves the right to make appropriate modifications to its products without changing the essential characteristics.**

本產品附有的標誌，表示符合歐盟就廢電子電機產品發出的2012/19/EU指令。  
廢電子電機產品包含污染物質及可再使用成份。為了去除當中所有污染物、修復及循環有用物料，它們必須經過特別的處理方法。透過以下適當方法棄置本產品，閣下便可避免以不恰當的方法棄置本產品，從而幫助減少對環境和人類健康造成的不良影響。

- 廢電子電機產品不可視作一般家居廢物般棄置。
  - 廢電子電機產品需要送往特定的收集點，以便按照當地的相關廢物處理條例，進行合適的回收處理工作。
- 現有不少國家都有推廣回收政策，當消費者於購買新家電時都可選擇把舊電器免費回收給零售商，只要該舊電器是與新品為同類型及持同等功能便可。

This appliance is marked according to the European directive 2012/19/EU on Waste Electrical and Electronic Equipment (WEEE). WEEE contains both polluting substances (which can cause negative consequences for the environment) and basic components (which can be re-used). It is important to have WEEE subjected to specific treatments, in order to remove and dispose properly all pollutants, and recover and recycle all materials. Individuals can play an important role in ensuring that WEEE does not become an environmental issue; it is essential to follow some basic rules:

- WEEE should not be treated as household waste;
- WEEE should be handed over to the relevant collection points managed by the municipality or by registered companies. In many countries, for large WEEE, home collection could be present.

In many countries, when you buy a new appliance, the old one may be returned to the retailer who has to collect it free of charge on a one-to-one basis, as long as the equipment is of equivalent type and has the same functions as the supplied equipment.



CH

EN